



Swedish design and manufacture since 1967
The safe choice with premium products



Products from Pahlén Pool System,
for a trouble-free pool ownership.

For more information: www.pahlen.com



“

We have learned a lot in 50 years and we are more than happy to share. Welcome into the family!

Top quality swimming pool equipment

Invest in genuine Swedish high quality products from Pahlén. Acid-proof stainless steel swimming pool equipment with beautiful design, optimal cleaning system for clean, clear, sparkling water, energy efficient heat pumps and automatic cleaning and dosing equipment that saves both time and money.

With 50 years experience of manufacture of quality products for swimming pools we guarantee reliability and a long-term investment. Your pool will come to be the place where your family and friends naturally congregate for many years to come.

High quality products and operations. Pahlén is a genuine Swedish company with 50 years experience in manufacturing quality products for pools.



Small private, large public

Pahlén provides equipment for both small private pools and public facilities. Our products are made of bronze, stainless steel, titanium and thermoplastic. The highest quality materials ensure long life and reliability.

Environmental profile

Pahlén AB produces and offers cost-effective, high-quality products that are safe for the consumer and the environment. Our environmental work is conducted in a comprehensive manner taking account of the individual and the society as a whole, as well as activities for continual environmental improvement, technological development and resource efficiency.

CEO

Stefan Pahlén

Since our establishment in 1967, quality and service have been the watchwords of our operations. Pahlén develops and manufactures innovative and qualitative pool equipment in the premium sector. As each swimming pool facility is a long term investment for pleasure, enjoyment and quality of life, our product development is highly focused on reliability, energy and the environment.

Our employees are characterized as competent, committed and involved in the contact with our customers and suppliers. In all stages, externally and internally, our business is characterized by long-term cooperation in constant development.



Product news in the catalogue

Discover our news

Experience a much more natural swimming technology with Jet Swim Motion, a counter current with brand new flow technology. Jet Massage a complete massage station that can be combined as desired, with up to 6 nozzles in two different strengths.



Jet Swim Motion
page 22



Jet Massage
page 23

■ Water circulation

Pumps	Page	6-17
-------	------	------

■ Water attractions

Jet Swim	Page	18-22
Jet Massage	Page	23

■ Heating

Heat exchangers	Page	24-33
Heat pumps	Page	34-35
Electric heaters	Page	36-45

■ Lighting and swimming pool equipment

Lighting and accessories	Page	46-55
Skimmers, inlets and outlets	Page	56-69

■ Measuring and dosing equipment

MiniMaster and accessories	Page	70-73
Autodos and accessories	Page	74-79
UV-disinfection	Page	80
CO ₂ - pH regulation	Page	81

■ Test instruments and pool care

Testing kits	Page	83-84
Vacuum cleaner	Page	85

■ Information

Calculation tables and dimensioning	Page	86-88
Showroom	Page	89

Pahlén pumps - The right circulation for your pools wellbeing



Exclusive pumps for efficient circulation. The pump creates suction in the skimmer and pushes the water through the filter, the heater and then back into the pool via the inlets. The pump and motor are integrated into a compact single unit, with a pre-filter housing. The strainer basket in the pre-filter effectively collects twigs, leaves, insects etc. and is easy removable for cleaning. To ensure good quality, water in a private pool should be circulated at least 4-6 times per day.

Pool pumps



P01/EcoP01

Pool pumps of bronze run quiet and stable. A speed controlled pump reduces the operating costs compared with conventional pumps.



P2000/P2000FLO

Pool pumps of bronze run quiet and stable. Equipped with a strainer basket making it easy to remove dirt such as leaves. Available in two versions; with or without pre-filter.



P85/P85FLO

Pool pumps of bronze run quiet and stable. Pool pump P85 is available in two versions; with or without pre-filter.



PT750/PT750FLO

Pool pumps of bronze run quiet and stable. Pumps without pre-filters for various purposes where the only requirement is distributing water. Suitable for i.e. spas, circulation, solar heating, fountains and waterfalls.



WaterVISE/EcoVISE/FloVISE

Pumps of thermoplast/bronze. Proven and rigid bronze material in pump housing and impeller, stainless steel shaft and mechanical seal with thermoplastic pre-filter, which ensures long lasting endurance.



Side channel blower

For air massage in spa pools and swimming pools. The side channel blower can be started from the poolside using pneumatic.

Pumps



P01 0.37-1.5kW

Pool pumps of bronze run quiet and stable. The pump impeller is also made of bronze and it is fitted to a shaft made of acid proof stainless steel. Equipped with a strainer basket making it easy to remove dirt such as leaves and insects.

Swedish-made quality bronze pumps with optimum performance.

Technical data			Voltage/Ampere			
Item no.	Type	kW				
		50Hz	230/1 ~	230/3 ~	400/3 ~	kg
120100	T37	0.37	-	2.1	1.2	18.3
120200	S37	0.37	3,4	-	-	18.3
120105	T55	0.55	-	2.8	1.6	19
120205	S55	0.55	4,3	-	-	19
120110	T75	0.75	-	2.9	1.7	23.5
120210	S75	0.75	5.5	-	-	23.5
120115	T110	1.1	-	4.2	2.4	26.8
120215	S110	1.1	6.6	-	-	26.8
120120	T150	1.5	-	5.2	3.0	28
120220	S150	1.5	9.6	-	-	28

Features

- Pump housing and pump impeller made of bronze
- Pump shaft made of acid proof stainless steel
- High-quality motors
- Equipped with drain plug
- Third-party tested and certified

Also available in 60 Hz version. Contact Pahlén AB for information.

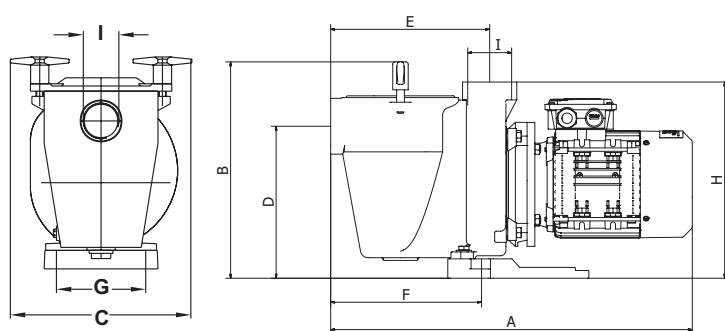

Pump capacities

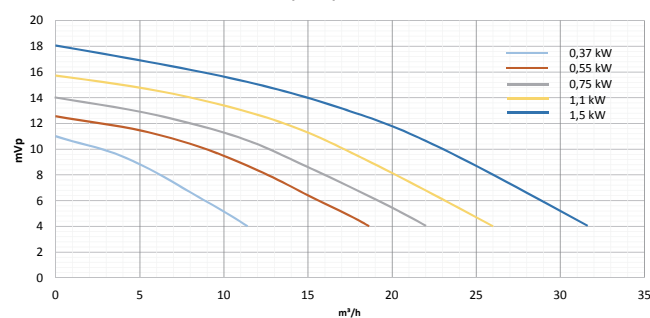

Dimensions

Item no.	A	B	C	D	E	F	G	H	I
120100, 120200	466	285	245	210	202	160	126,5	255	2"
120105, 120205	466	285	245	210	202	160	126,5	255	2"
120110, 120210	484	285	245	210	202	160	126,5	255	2"
120115, 120215	502	285	245	210	202	160	126,5	255	2"
120120, 120220	521	285	245	210	202	160	126,5	255	2"

Pumps



EcoP01 0,75kW

Pool pumps of bronze run quiet and stable. The pump impeller is also made of bronze and it is fitted to a shaft made of acid proof stainless steel. Equipped with a strainer basket making it easy to remove dirt such as leaves and insects.

A speed controlled pump reduces the operating costs compared with conventional pumps. Lower speeds give lower energy consumption and quieter operation.

An existing pool pump P01 can be advantageously upgraded with EcoP01 drive side to get the same characteristics as EcoP01.

Technical data

Item no.	Type	kW		kg
		50Hz	230/1 ~	
117210	EcoP01 V75	0,75	4,4	18
631083	EcoP01 drive end	0,75	-	9

Voltage/
Ampere

Accessories

Item no.

117100	External switch Eco
--------	---------------------

Features

- Pump housing and pump impeller made of bronze
- Pump shaft made of acid proof stainless steel
- High-quality motors
- Three selectable adjustable program speeds
- Timer functions for flexible operating conditions
- Equipped with drain plug

Speed-controlled quality pump in bronze with optimal performance and maximum energy saving.

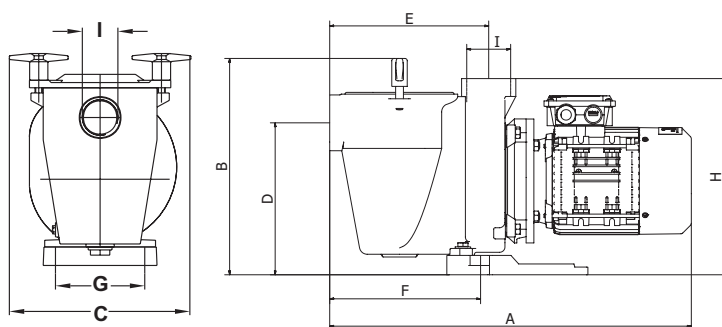

Pump capacities

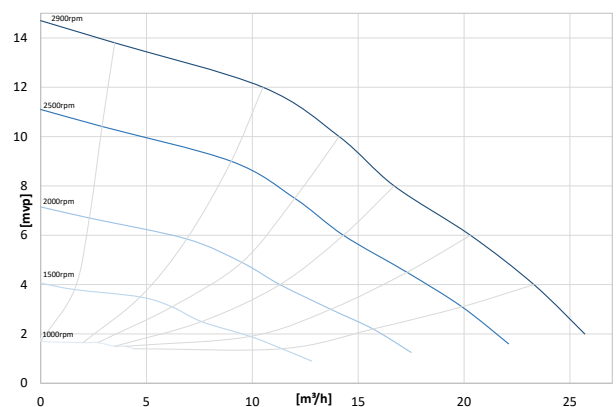

Dimensions

Item no.	A	B	C	D	E	F	G	H	I
117210	466	285	245	210	202	160	126,5	255	2"

Pumps



P2000 1.5-4.0kW

Pool pumps of bronze run quiet and are stable. The pump impeller, pre-filter, pumphousing is also made of bronze and it is fitted to a shaft made of acid proof stainless steel. Equipped with a strainer basket making it easy to remove dirt such as leaves.

Technical data

Voltage/Ampere

Item no.	Type	kW		kg
		50Hz	230/3 ~	
112201	T150	1.5	5.2	35.8
112211	T220	2.2	8.0	37.8
112221	T400	4.0	-	45.8

Also available in 60 Hz version. Contact Pahlén AB for information.

Features

- Pump housing and pump impeller made of bronze
- Pump shaft made of acid proof stainless steel
- High-quality motors
- Pre-filter made of bronze with filter basket of composite material
- Equipped with drain plug
- Third-party tested and certified

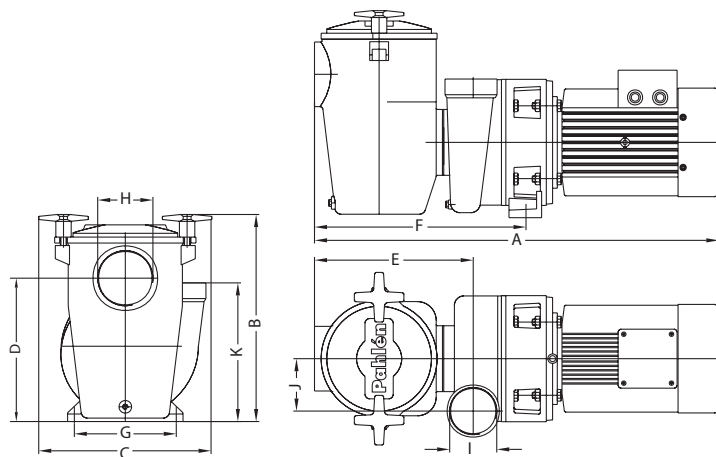

Pump capacities

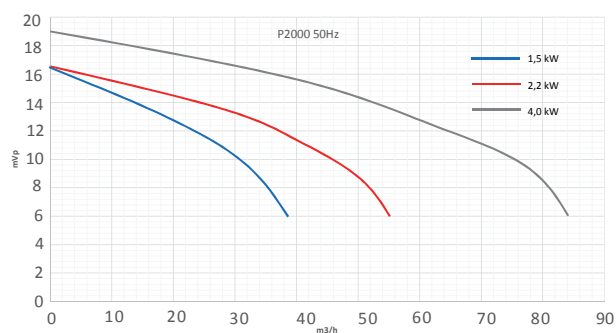

Dimensions

Item no.	A	B	C	D	E	F	G	H	I	J	K
112201	620	335	275	225	250	330	130	3"	2½"	82	220
112211	620	335	275	225	250	330	130	3"	2½"	82	220
112221	710	335	275	225	250	330	130	3"	2½"	82	220

Pumps



P2000FLO 1.5-4.0kW

Pumps without pre-filters for various purposes where the only requirement is distributing water. Suitable for i.e. spas, circulation, solar heating, fountains and waterfalls.

Technical data

Voltage/Ampere

Item no.	Type	kW		230/3 ~	400/3 ~	kg
		50Hz				
115201	T150	1.5		5.2	3.0	25.7
115211	T220	2.2		8.0	4.6	27.7
115221	T400	4.0		-	8.0	35

Also available in 60 Hz version. Contact Pahlén AB for information.

Features

- Pump housing and pump impeller made of bronze
- Pump shaft made of acid proof stainless steel
- High-quality motors
- Equipped with drain plug
- With or without pre-filter
- Third-party tested and certified

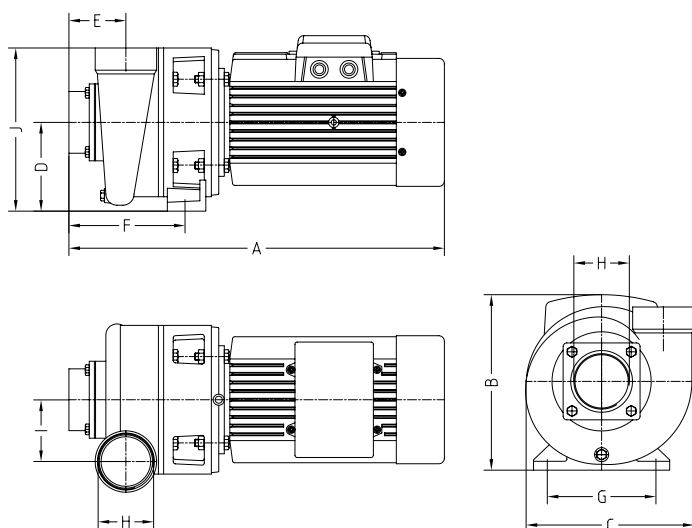

Pump capacities

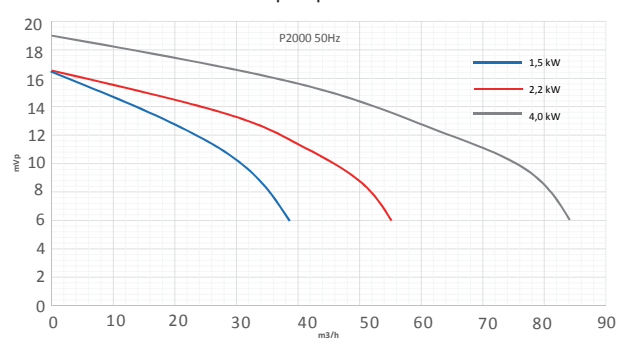

Dimensions

Item no.	A	B	C	D	E	F	G	H	I	J
115201	445	245	230	122	77	155	130	2½"	82	220
115211	445	245	230	122	77	155	130	2½"	82	220
115221	540	285	230	122	77	155	130	2½"	82	220

Pumps



Item no.11224

P85/P85FLO 5.5kW

Pool pumps of bronze run quiet and are stable. The pump impeller is also made of bronze and it is fitted to a shaft made of acid proof stainless steel. Pool pump P85 is available in two versions; with or without pre-filter.

Pumps without pre-filters for various purposes where the only requirement is distributing water. Suitable for i.e. spas, circulation, solar heating, fountains and waterfalls. The pool pump is equipped with a strainer basket which makes it easy to remove dirt such as leaves.

Features

- Pump housing and pump impeller made of bronze
- Pump shaft made of acid proof stainless steel
- High-quality motors
- Pre-filter made of bronze with filter basket
- Equipped with drain plug
- Two different versions. With or without pre-filter
- Third-party tested and certified



Item no.11524

Without pre-filter

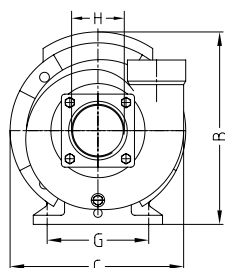

Technical data			Voltage/Ampere		
Item no.	Type	kW 50Hz	400/3 ~	690/3 ~	kg
11224	T550	5.5	10.2	5.9	59
11524	T550	5.5	10.2	5.9	50

Also available in 60 Hz version. Contact Pahlén AB for information.

With pre-filter

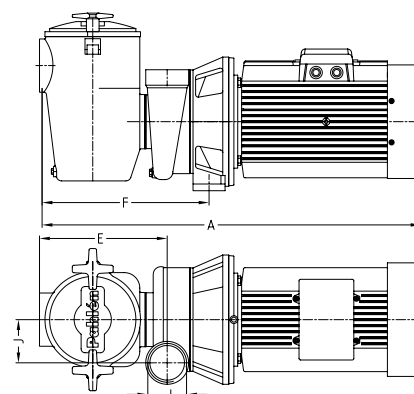
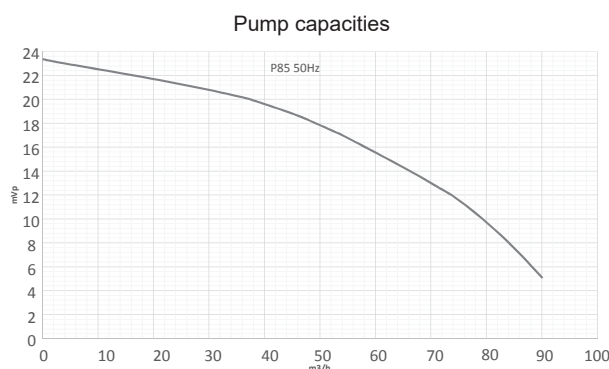
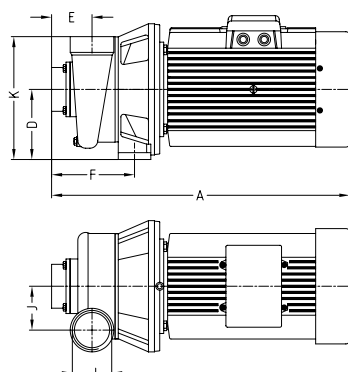
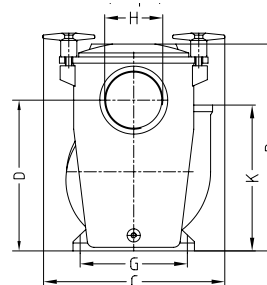

Dimensions

Item no.	Type	A	B	C	D	E	F	G	H	I	J	K
11224	T550 (with pre-filter)	815	330	275	250	240	315	140	3"	2½"	82	235
11524	T550 (without pre-filter)	640	275	275	137	77	155	140	2½"	2½"	82	235

Pumps



Item no.12225



Item no.12227

PT750/PT750FLO 7.5kW

Pool pumps of bronze run quiet and are stable. The pump impeller is also made of bronze and it is fitted to a shaft made of acid proof stainless steel. Pool pump 7.5kW is available in two versions; with or without pre-filter. Pumps without pre-filters for various purposes where the only requirement is distributing water. Suitable for i.e. spas, circulation, solar heating, fountains and waterfalls.

The pool pump with pre-filter is equipped with a strainer basket which makes it easy to remove dirt such as leaves.

Features

- Pump housing and pump impeller made of bronze
- Pump shaft made of acid proof stainless steel
- High-quality motors
- Pre-filter made of bronze with filter basket
- Equipped with drain plug
- Two different versions. With or without pre-filter
- Third-party tested and certified

Without pre-filter

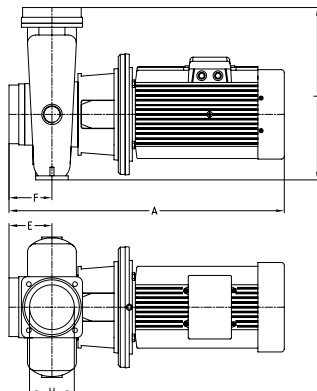
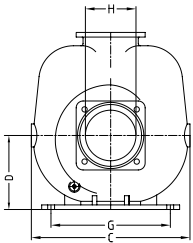

Technical data

Item no.	Type	kW 50Hz	Voltage	Voltage/Ampere		kg
				400/3 ~	690/3 ~	
12225	T750	7.5	400/690	13.7	7.9	108
12227	T750	7.5	400/690	13.7	7.9	79

Voltage/Ampere

With pre-filter

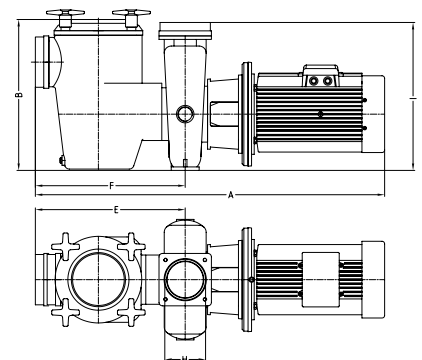
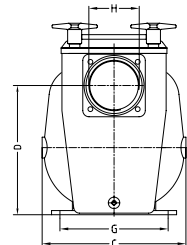

Pump capacities

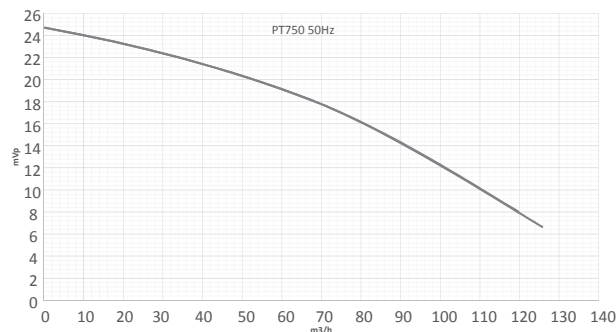

Dimensions

Item no.	Type	A	B	C	D	E	F	G	H	I
12225	T750 (with pre-filter)	995	410	360	300	390	390	260	110	430
12227	T750 (without pre-filter)	720	-	360	160	115	115	260	110	430

Pumps



WaterVISE pre-filter pump 0.25–1.10 kW

Pumphousing and impeller with optimal construction, designed to ensure energy efficiency and quiet operation. Proven and rigid bronze material in pump housing and impeller, stainless steel shaft and mechanical seal with thermoplastic pre-filter, which ensures long lasting endurance.

The pre-filter, with an easily detachable, transparent securing lid, is versatile with up to seven different inlet-positions. This allows flexible and compact installation. 2" thread inlet/outlet connections.

Technical data			Voltage/Ampere		
Item no.	Type	kW 50Hz	3~230V	1~230V	3~400V
118100	HS25	0.25	-	1.95	-
118101	HS37	0.37	-	3,4	-
118121	HT37	0.37	2.1	-	1.2
118102	HS55	0.55	-	4,1	-
118122	HT55	0.55	2.8	-	1.6
118103	HS75	0.75	-	5.5	-
118123	HT75	0.75	2.9	-	1.7
118104	HS110	1.10	-	6.6	-
118124	HT110	1.1	4.2	-	2.4

Features

- Pump housing and pump impeller made of bronze
- Pump shaft in acid proof stainless steel
- High-quality motors
- Versatile pre-filter allowing different inlet-positions
- Higher performance/energy ratio
- Reduced sound levels
- Third-party tested and certified

Pump capacities

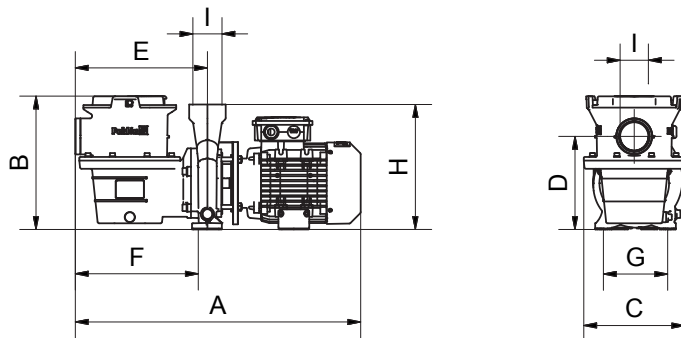
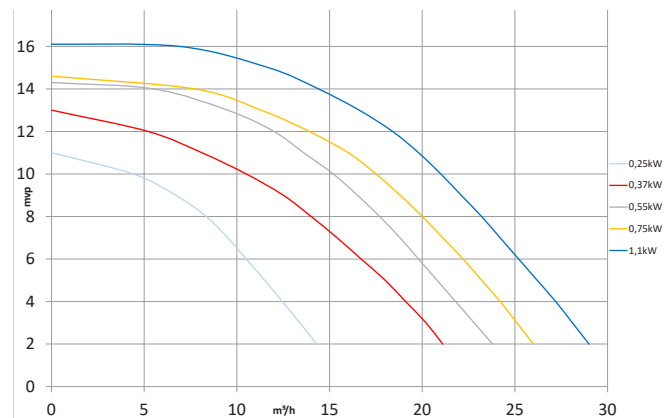

Dimensions

Item no.	Type	A	B	C	D	E	F	G	H	I
118100	HS25	489	280	196	181	257	239	125	243	2"
118101	HS37	519	280	196	181	257	239	125	243	2"
118121	HT37	519	280	196	181	257	239	125	243	2"
118102	HS55	519	280	196	181	257	239	125	243	2"
118122	HT55	519	280	196	181	257	239	125	243	2"
118103	HS75	537	280	196	181	257	239	125	243	2"
118123	HT75	537	280	196	181	257	239	125	243	2"
118104	HS110	555	280	196	181	257	239	125	243	2"
118124	HT110	555	280	196	181	257	239	125	243	2"

Pumps



EcoVISE variable speed pump 0.75 kW

Three selectable program speeds ensure silent operation, energy savings and more efficient filtration. Built on the same design and performance as WaterVISE, with a high efficiency, motor. Integrated timer functions and external control of selected speeds.

Technical data

Item no.	Type	Voltage/Ampere				kg
		kW 50Hz	3~230V	1~230V	3~400V	
117103	HV75	< 0.75	-	4.4	-	13

Accessories

Item no.

117100	External switch Eco
--------	---------------------

Features

- WaterVISE design and performance
- High efficiency, synchronous motor
- Three adjustable selectable program speeds
- Timer functions for flexible operating conditions
- External speed control as accessories
- Maximum energy savings

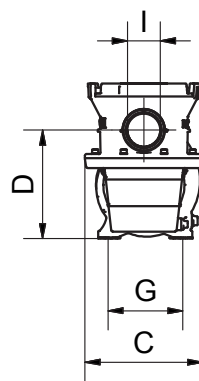
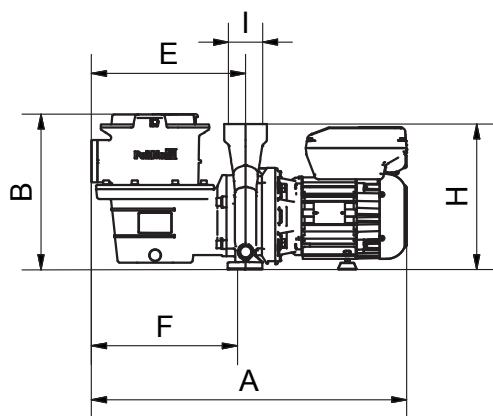

Pump capacities

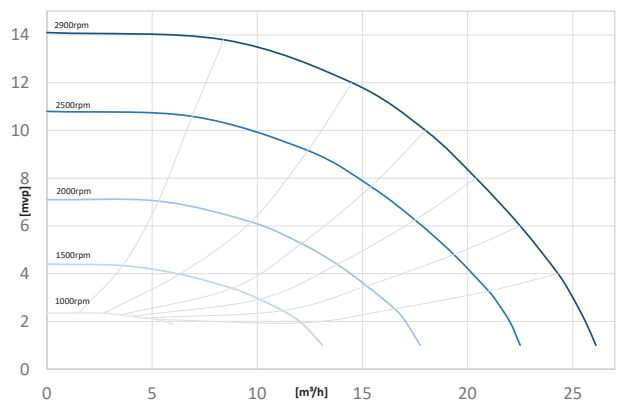

Dimensions

Item no.	Type	A	B	C	D	E	F	G	H	I
117103	HV75	525	280	196	181	257	239	125	243	2"



FloVISE massage pump 0.25–1.10 kW

Pump with optimal construction, designed to ensure energy efficiency and quiet operation. Proven and rigid bronze material in pump housing and impeller, stainless steel shaft and mechanical seal, which ensures long lasting endurance.

For whirlpool, bathtub and spa applications.

Technical data				Rated current (A)		
Item no.	Model	kW 50Hz	Voltage (V)	3~230V	1~230V	3~400V
119100	TS25	0,25 kW	230	-	1,9	-
119101	TS37	0,37 kW	230	-	3,4	-
119121	TT37	0,37 kW	230/400	2,1	-	1,2
119102	TS55	0,55 kW	230	-	4,3	-
119122	TT55	0,55 kW	230/400	2,8	-	1,6
119103	TS75	0,75 kW	230	-	5,5	-
119123	TT75	0,75 kW	230/400	2,9	-	1,7
119104	TS110	1,10 kW	230	-	6,6	-
119124	TT110	1,10 kW	230/400	4,3	-	2,5

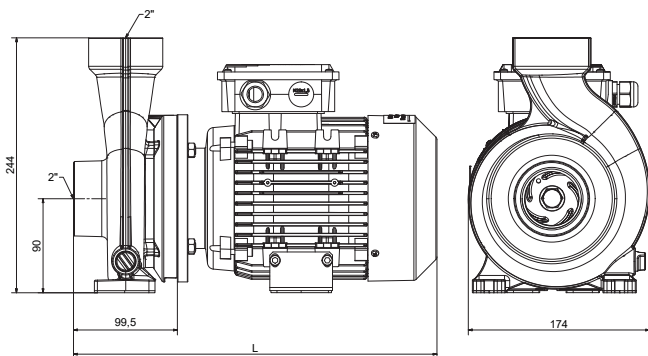

Pump capacities

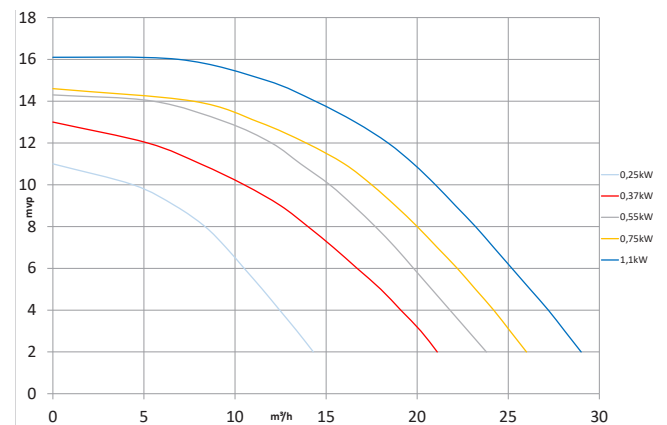

Dimensions

Item no.	Type	L
118100	HS25	278 mm
118101	HS37	308 mm
118121	HT37	308 mm
118102	HS55	308 mm
118122	HT55	308 mm
118103	HS75	328 mm
118123	HT75	328 mm
118104	HS110	348 mm
118124	HT110	348 mm

Side channel blower



Side channel blower

For air massage in spa pools and swimming pools. The side channel blower can be started from the poolside using a pneumatic control. The blower can be installed horizontally or vertically. Pipe connections are made via an air loop 50 cm above the water surface. Blower housing, blower wheel and side channel in cast aluminium.

Filter and silencer

Accessory. Equip the side channel blowers with silencers for extra quiet operation and a filter that prevents small particles from entering the pool.

Features

- Blower housing, blower wheel and silencer housing made of aluminium
- Mounted vertically or horizontally
- Can be equipped with a silencer
- Can be fitted with a filter
- Constant air flow

Technical data			Voltage/Ampere				Dimensions (mm)			
Item no.	Type	kW	230	400	dB	Connection	kg	A	B	C
81200	SC10C-075T	0.75	3.3	1.9	73	1½"	18.5	296	330	340
81201	SC20A-110T	1.1	4.3	2.5	75	1½"	22	360	360	400
81202	SC30A-220T	2.2	8.0	4.6	78	2"	36	395	445	450
81203	SC30C-300T	3.0	11.3	6.5	81	2"	40	395	445	450



Silencer Item no. 81211



Filter Item no. 81210

Accessories

Item no.

81210	Filter to SC10 & SC20 (0.75-1.1kW)
81213	Filter to SC30 (2.2-3.0kW)
81211	Silencer to SC10 & SC20 (0.75-1.1kW)
81212	Silencer to SC30 (2.2-3.0kW)

Wonderful **air massage** for spa and pool, made of aluminum for optimum **quality** and **durability**.

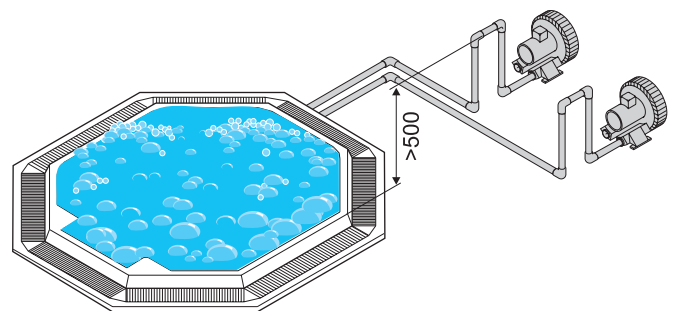
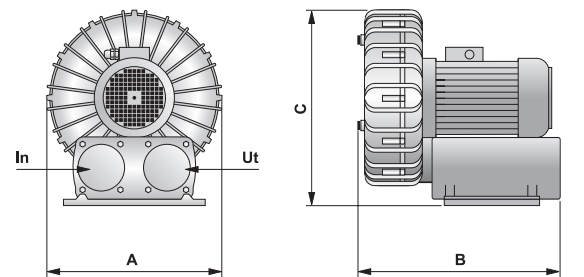
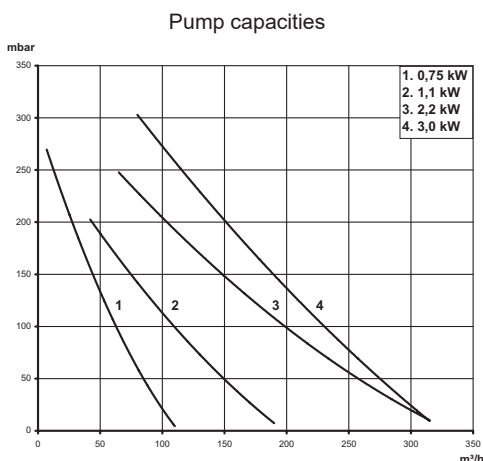

Jet Swim



Jet Swim is the ideal tool for training, exercise and fun. Jet Swim is the perfect accessory for exercise, fitness and fun. With a Jet Swim counter current unit installed in the pool, the training effect is that of a much larger pool. By swimming “on the spot”, you can

For training, exercise and fun



Who would believe you could get a good exercise in a pool 3 x 6 m.

train and practice your swimming technique at the same time as building up your strength and endurance. Jet Swim counter current unit also functions as a massage and rehabilitating muscle trainer. Of course, the children also love to swim in the lively, bubbling current of water.

Water attractions



Jet Swim 2000

An exclusive counter current unit with many different settings. With pump capacity of 71 m³/h it is easy for you to build up your strength and physical fitness. Start your Jet Swim by pressing a button on the front. The flow pattern is set by means of the adjustable jets to suit your personal needs. The air flow that is mixed with the jet streams, is adjusted by turning the air knob on the front. It is just as simple to adjust the water flow.

Jet Swim 2000 is also available in 3-phase 230V/50Hz or 460V/60Hz. Contact Pahlén AB for information.

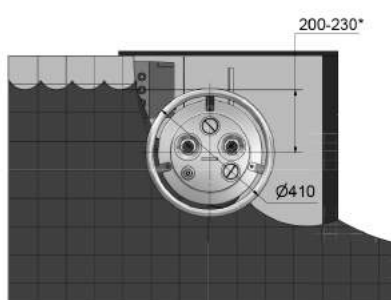
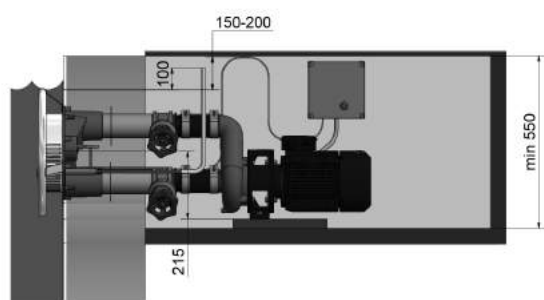

Jet Swim unit 2000
for pool cover
Item no. 1302005



All dimensions in mm. Dimensions within brackets refers to mounting kit item.nr 1302010.

Features

- Bronze and acid proof stainless steel
- Pump capacity at 71 m³/h
- Adjustable water flow
- Adjustable jet streams
- Adjustable setting of the air mixture
- Polished stainless steel front
- High-class motor
- Meets requirements of pool standard EN13451, EN16582, EN16713

Technical data

Type	Motor	Voltage, 50Hz	Power, 230/400	Pump capacity	Pipe connection	Materials
2000	4.0 kW	230/400 V	13.9/8.0 A	71 m³/h	2 1/2"	Bronze/stainless steel

Jet Swim 2000

Type of pool

Item no.	Type	Wood/plastic/ steel with liner	Concrete liner	Concrete pool without liner	Fibreglass/PP- plastic
33029	Complete unit - concrete		x		
33028	Complete unit - liner	x			
1302000	Jet Swim unit	x	x	x	x
1302005*	Jet Swim unit for pool cover	x	x	x	x
1302010	Assembly kit	x			x
1302020	Assembly kit		x	x	
1302015**	Screw kit				x
1302080	Pump	x	x	x	x
1302090	Control box 400/3~	x	x	x	x

*For floating pool cover.

**For fibreglass/PP pool a complementary set of screws is needed.

Water attractions



Jet Swim 1200

With a motor capacity of 2.2kW and pump capacity of 46 m³/h it is easy for you to train your swimming technique and build up your physical fitness. Start your Jet Swim by pressing a button on the front.

The jet stream are varied in power by rotating the turnable front. Resistance can be changed in three different steps, two for the jet stream and one for the air mixture.

Jet Swim 1200 is also available in 3-phase 230V/50Hz or 460V/60Hz. Contact Pahlén AB for information.

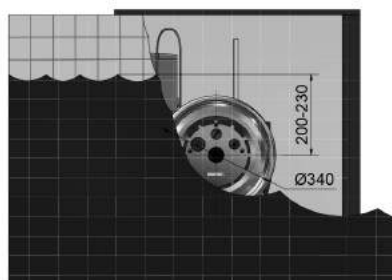
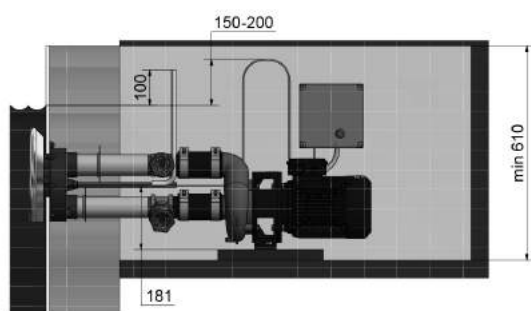

All dimensions in mm. Dimensions within brackets refers to mounting kit item.nr 1301210.

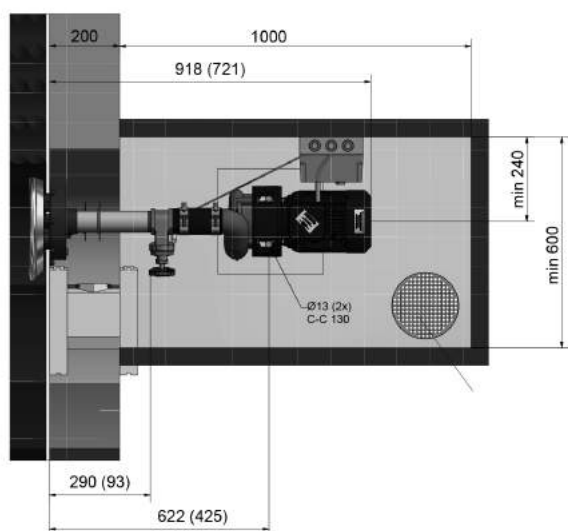

Features

- Bronze and acid proof stainless steel
- Pump capacity at 46 m³/h
- Adjustable water flow
- Adjustable setting of the air mixture
- Polished stainless steel front
- High-class motor

Technical data

Type	Motor	Voltage, 50Hz	Power, 230/400	Pump capacity	Pipe connection	Materials
1200	2.2 kW	230/400 V	8.0/4.6 A	46 m³/h	2"	Bronze/stainless steel

A complete Jet Swim consists of jet unit, assembly kit, pump and control box.

Jet Swim 1200

Typ av poolstomme

Item no.	Type	Wood/plastic/ steel with liner	Concrete liner	Concrete pool without liner	Fibreglass/ PP-plastic
33027	Complete unit - concrete			x	
33026	Complete unit - concrete liner		x		
33025	Complete unit - liner	x			
1301200	Jet Swim unit	x	x	x	
1301210	Assembly kit	x			
1301220	Assembly kit		x		
1301230	Assembly kit			x	
1301280	Pump	x	x	x	
1301290	Control box 400/3~	x	x	x	

Water attractions



Jet Swim Motion

Jet Swim Motion is made of acid-proof stainless steel and has a completely new flow technique with two oval nozzles, of which the lower is directed downward for a more even distribution of the streams. This provides a much more natural swimming technique compared to most counter-current units found on the market.

With a motor power of 2.2 kW and with jet streams of 46 m³/h, you can easily exercise your strength and physical fitness. Jet Swim Motion is started by pressing a pushbutton on the front. The air mixture in the jet streams are adjusted seamlessly in order to suit your personal needs. In its modern minimalistic design, a discreet handle is hidden and integrated in the front.

Jet Swim Motion is available in both Classic and Marine design and meets the requirements for the pool standard EN 16582.

Features

- New flow technique with two oval nozzles
- Seamlessly adjustable setting of the air mixture
- Modern and minimalistic design
- Integrated handle
- Pneumatic start button
- Meets requirements of pool standard EN 16582
- High-class motor



Jet Swim Motion

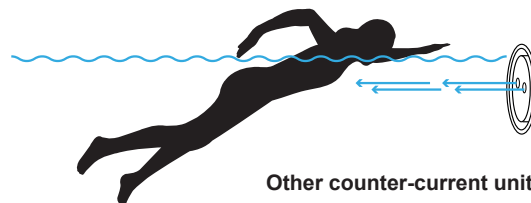

Other counter-current unit

Technical data

	Motor			Pump capacity		
Motion	2.2 kW	230/400 V	8,0/4,6 A	46 m ³ /h	2"	PC/stainless steel

A complete Jet Swim Motion consists of jet unit, assembly kit, pump and control box.

Jet Swim Motion		Type of pool			
Item no.	Type	Wood/plastic/steel with liner	Concrete liner	Concrete pool without liner	Fibreglass/PP-plastic
33041	Complete unit - Classic	x			x*
33042	Complete unit - Classic		x	x	
33043	Complete unit - Marine	x			x*
33044	Complete unit - Marine		x	x	
1301300	Motion Classic unit	x	x	x	x
1301305	Motion Marine unit	x	x	x	x
1301310	Assembly kit	x			x
1301320	Assembly kit		x	x	
1301285	Jet Swim Pump 2.2kW 50Hz	x	x	x	x
1301390	Control box 400/3~	x	x	x	x

*Additional assembly kit is required for fibreglass/PP-plastic

Water attractions



Jet Massage in Classic model

Jet Massage

Jet Massage consists of a standalone inlet, outlet and start button that combines as desired and up to 6 nozzles. All nozzles are made of acid-proof stainless steel and is available in both Marine and Classic designs. The massage station can be controlled with a Pahlén circulation pump (e.g. FloVISE or P2000FLO) and Pahlén control box. Recommended flow capacity max 8-10 m³/h per nozzle.

Features

- 2 nozzles soft and medium
- Combine as desired and up to 6 nozzles
- Both for private pools and public facilities
- Meets requirements of pool standard EN 16713
- Available in both Classic and Marine design
- Meets the requirements of pool standard EN13451, EN16582, EN16713

		Wood/plastic/steel with liner	Concrete liner	Pipe connection
Item no.	Type	Standard	350	
13005571	Start button Classic 350		x	
13005570	Massage Soft Classic 350		x	Ø50mm
13005572	Massage Medium Classic 350		x	Ø50mm
13005561	Start button Classic	x		
13005560	Massage Soft Classic	x		Ø50mm
13005562	Massage Medium Classic	x		Ø50mm
13005551	Start button Marine 350		x	
13005550	Massage Soft Marine 350		x	Ø50mm
13005552	Massage Medium Marine 350		x	Ø50mm
13005541	Start button Marine	x		
13005540	Massage Soft Marine	x		Ø50mm
13005542	Massage Medium Marine	x		Ø50mm

For options to fiberglass/PP-plastic contact Pahlén AB for more information.

Massage station configurations

Complete Jet Massage consists of 1-6 massage nozzles, a start button, at least 2 outlets, a separate circulation pump, a control box, connections and pipes. The number of massage nozzles governs the size of the pump and the number of outlets.

Number of massage nozzles	Number of outlets	Pump
1	2	FloVISE 0,55 kW
2	2	FloVISE 1,1 kW
4	3	P2000 2,2 kW
6	4	P2000 4,0 kW

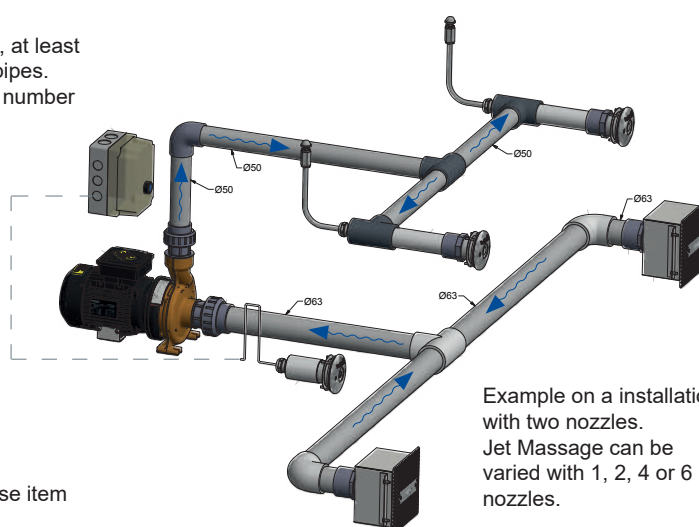

Example on a installation with two nozzles. Jet Massage can be varied with 1, 2, 4 or 6 nozzles.

Jet massage-unit

When ordering Jet Massage units according to configurations above, use item no. as in example shown below.

Example of Item no:	A	B	C
Marine design = 36	350 = 2	Soft = 0	No. of nozzles
Classic design = 35	Standard = 0	Medium = 1	1, 2, 4, 6
36ABC	362BC	3620C	36204
35ABC	350BC	3501C	35012

Accessories

Item no.	
636200	Massage nozzle Soft as option
636201	Massage nozzle Medium as option

Heating - Heat exchangers



Simple to install and suitable for all types of heating system.

Pahlén pool heat exchangers for fast and flexible heating. A heat exchanger is used to transfer heat energy from one medium to another without the two media being mixed. All the models can be installed and connected to electric, firewood, pellets or oil-fired boilers, heat pump or solar panel systems. The heat exchangers are designed and made of materials that permit their use for a wide variety of needs and in many different types of installations.

Easily installed to your existing heat source



Maxi-Flo

Made of acid proof stainless steel or titanium.
Maxi-Flo is a tube heat exchanger with excellent heating properties and is simple to install.



Hi-Flow

Made of acid proof stainless steel or titanium.
Hi-Flow is a spiral heat exchanger for installations that operate under high pressure.



Hi-Temp

Made of acid proof stainless steel.
Hi-Temp is a spiral heat exchanger made of fiberglass reinforced thermoplastic for extra durability, and a coil of acid proof stainless steel.



Hi-Temp titanium

Made of titanium.
Hi-Temp is a spiral heat exchanger made of fiberglass reinforced thermoplastic for extra durability, and a coil of titanium for salt water pools.



Aqua MEX

Made of acid proof stainless steel or titanium.
Outer jacket of fiberglass reinforced thermoplastic.
Aqua MEX is a heat exchanger which can be equipped with digital control and circulation pump.

Use acid proof stainless steel
in fresh water pools and titanium
in saltwater pools.

Heat exchangers



Features

- Titanium
- Twisted tubes for the heating medium
- Available in 75 and 200kW
- Suits all installations
- Mounted vertically

Maxi-Flo titanium 75-200kW

Maxi-Flo titanium is a tube heat exchanger made of titanium for the most demanding installations where there is a high risk of corrosion. Titanium is ideal for swimming pools with salt water or where a salt chlorinator is used.

Titanium for maximum heat transfer. Connects to boiler, heat pump, solar panel system or other heat source. Suits all installations.

Maximum pressure secondary circuit (pool water) 75 kW is 5 bar/200 kW 4 bar and primary circuit (hot water) is 10 bar for both.

Suitable for pools up to 1000 m³.

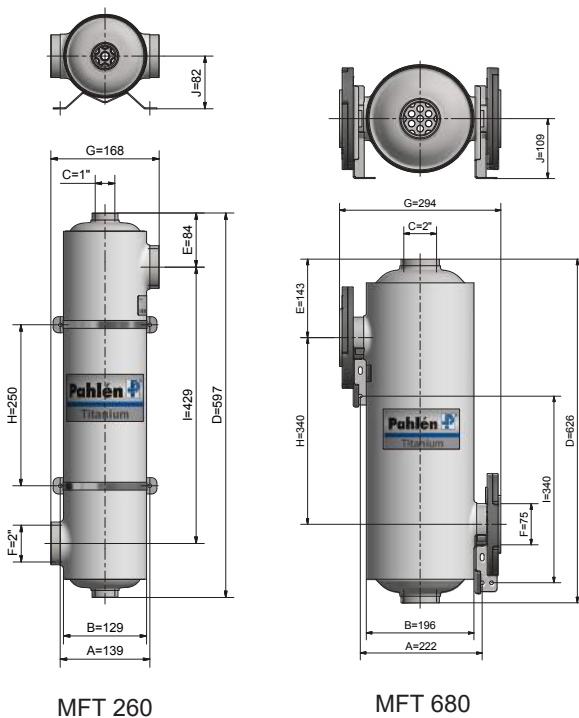

Maxi-Flo Titanium is a tube heat exchanger with twisted tube pipes for optimal heating. Titanium is the ideal material when a salt chlorinator is used.

Dimensions

Item no.	Type	kW	Heating surface m ²	A	B	C	D	E	F	G	kg
11377	MFT260	75	0.77	139	Ø 129	1"	597	84	2"	167	9.8
11380	MFT680	200	2.11	201	Ø 196	2"	612	146	DN65	294	23.8

Technical data

Item no.	Type	Capacity			Primary, hot water		Secondary, pool water		
		kW	kBtu/h	kcal	l/min	press. drop H (m)	l/min	press. drop H (m)	
11377	MFT260	75	260	64 488	35	0.9	300	1.8	
11380	MFT680	200	680	172 000	95	0.1	600	3	

Capacity at a temperature difference of 60°C

Heat exchangers



Maxi-Flo 40-120kW

Maxi-Flo is a tube heat exchanger with excellent heating properties. It is made of acid proof stainless steel for optimum service life. Simple installation using the stainless steel adjustable attachments that are included.

Maximum pressure secondary circuit (pool water) is 5 bar and primary circuit (hot water) is 10 bar.

Suitable for pools up to 450 m³

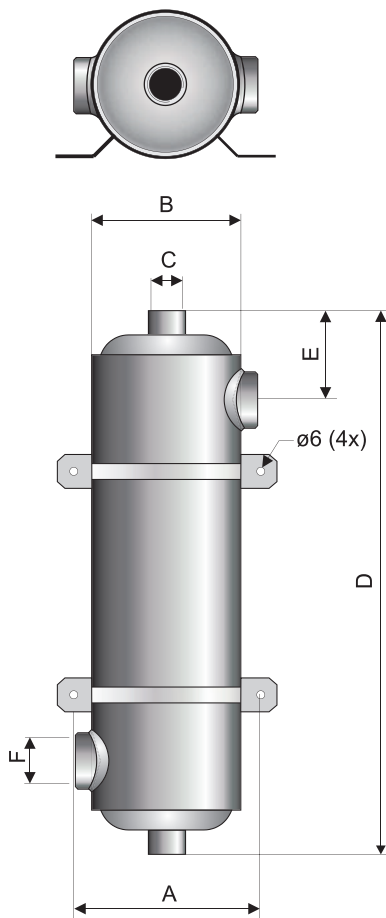

Features

- Acid proof stainless steel
- Precision-welded outer jacket
- 37 seamless pipes equipped with flow restrictors for hot water
- Adjustable brackets of acid proof stainless steel
- Four sizes: 40, 60, 75 and 120 kW
- Connects to existing heat source
- Can be connected in series when needed.
- Mounted vertically

Maxi-Flo is a tube heat exchanger with excellent heating properties, made of acid proof stainless steel for optimum life.

Dimensions

Item no.	kW	A	B	C	D	E	F
11365	40	139	129	1"	355	92	1½"
11366	60	139	129	1"	485	92	1½"
11367	75	139	129	1"	600	85	2"
11368	120	139	129	1½"	1070	85	2"

Technical data

Item no.	Type	Capacity			Primary, hot water		Secondary, pool water		kg
		kW	kBtu/h	kcal	l/min	press. drop H (m)	l/min	press. drop H (m)	
11365	MF135	40	135	34 394	25	0.05	200	0.8	3.4
11366	MF200	60	200	51 590	30	0.15	250	1.4	4.5
11367	MF260	75	260	64 488	35	0.4	300	1.0	5.6
11368	MF400	120	400	103 181	50	0.5	360	1.5	9.3

10083002 Coupling 2" in case of series connection of 11367 or 11368.

1.3

Capacity at a temperature difference of 60°C

Heat exchangers

Hi-Flow titanium 28-75kW

Hi-Flow titanium is a spiral heat exchanger made of titanium for the most demanding installations where there is a high risk of corrosion. Titanium is ideal for swimming pools with salt water or where a salt chlorinator is used. Adjustable stainless steel attachments included.

Maximum pressure secondary circuit (pool water) is 5 bar and primary circuit (hot water) is 30 bar.

Suitable for pools up to 300 m³



Hi-Flow is a spiral heat exchanger made of titanium, the ideal material when a salt chlorinator is used. Suitable for installations with high pressure.

Features

- Titanium
- Connections with interior thread (secondary side)
- Coil for the heating medium
- Pocket for temperature probe
- Adjustable brackets of acid proof stainless steel
- Three sizes 28, 40 and 75 kW
- Connects to existing heat source
- Mounted horizontally

Technical data

Item no.	Type	Capacity			Primary, hot water		Secondary, pool water		kg
		kW	kBtu/h	kcal	l/min	press. drop H (m)	l/min	press. drop H (m)	
11332	T28	28	95	24 075	20	1.0	300	1.1	1.9
11333	T40	40	135	34 393	40	2.3	350	1.7	2.0
11334	T75	75	260	64 488	45	5.2	350	1.7	2.9

Capacity at a temperature difference of 60°C for 11332 and 11333. Capacity at a temperature difference of 70°C for 11334.

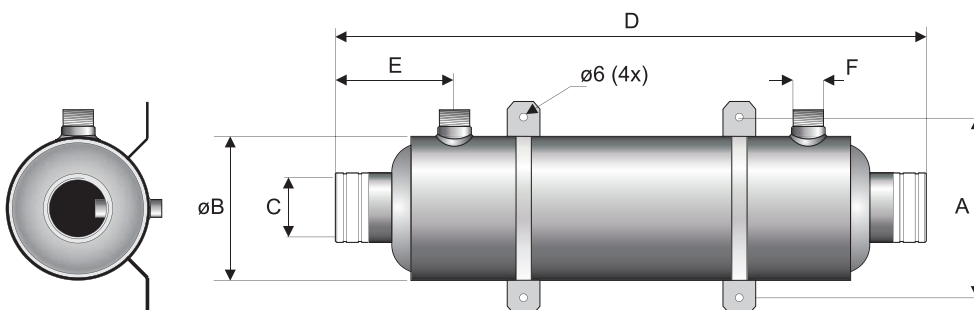

Dimensions

Item no.	kW	A	B	C	D	E	F	G
11332	28	139	113	1 ½"	470	95	1"	51
11333	40	139	127	1 ½"	510	108	1"	51
11334	75	139	127	1 ½"	754	108	1"	51

Heat exchangers



Hi-Flow 13-75kW

Hi-Flow is a spiral heat exchanger made of acid proof stainless steel for installations that operate under high pressure. Simple installation with the included adjustable stainless steel attachments.

Maximum pressure secondary circuit (pool water) is 8 bar and primary circuit (hot water) is 30 bar.

Suitable for pools up to 300 m³

Hi-Flow is a spiral heat exchanger for installations with high pressure made of stainless steel for optimal durability.

Features

- Acid proof stainless steel
- Precision-welded outer jacket
- Coil for heating medium
- Pocket for temperature probe
- Adjustable brackets of acid proof stainless steel
- Four sizes: 13, 28, 40 and 75 kW
- Connects to existing heat source
- Mounted horizontally

Technical data

Item no.	Type	Capacity			Primary, hot water		Secondary, pool water		kg
		kW	kBtu/h	kcal	l/min	press. drop H (m)	l/min	press. drop H (m)	
11391	HF13	13	45	11 177	25	0.9	200	0.6	1.9
11392	HF28	28	95	24 075	25	1.7	300	1.6	3.2
11393	HF40	40	135	34 393	60	1.3	300	1.6	3.4
11394	HF75	75	260	64 488	60	2.6	300	1.1	5.3

Capacity at a temperature difference of 60°C for 11391 and 11392. Capacity at a temperature difference of 70°C for 11393 and 11394.

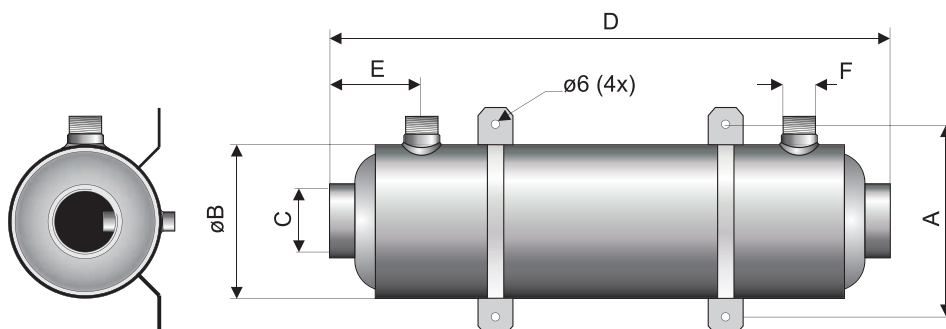

Dimensions

Item no.	kW	A	B	C	D	E	F
11391	13	139	129	1 ½"	235	72	¾"
11392	28	139	129	1 ½"	407	75	¾"
11393	40	139	129	1 ½"	455	85	1"
11394	75	139	129	2"	702	85	1"

Heat exchangers



Hi-Temp titanium is a spiral heat exchanger made of thermoplastic with a high glass content for extra durability and titanium.

Hi-Temp titanium 40-75kW

Hi-Temp titanium is a spiral heat exchanger made of thermoplastic with a high glass content for extra durability. With a coil of titanium for the most demanding installations where there is a high risk of corrosion, such as in pools with salt water or where a salt chlorinator is used.

Maximum pressure secondary circuit (pool water) is 4 bar and primary circuit (hot water) is 5 bar.

Suitable for pools up to 300 m³.

Features

- Outer jacket of thermoplastic
- Hot water coil made of titanium
- Integrated wall-mounting
- Slip connections for bonding of Ø 50 mm pipes
- Two sizes 40 and 75kW
- Connects to existing heat source
- Mounted horizontally or vertically

Technical data

Item no.	Type	Capacity			Primary, hot water		Secondary, pool water		
		kW	kBtu/h	kcal	l/min	press. drop H (m)	l/min	press. drop H (m)	kg
11322	HTT 40	40	135	34 393	52	1.5	300	1.1	2.3
11324	HTT 75	75	260	64 488	58	2.5	300	1.2	3.5

Capacity at a temperature difference of 60°C

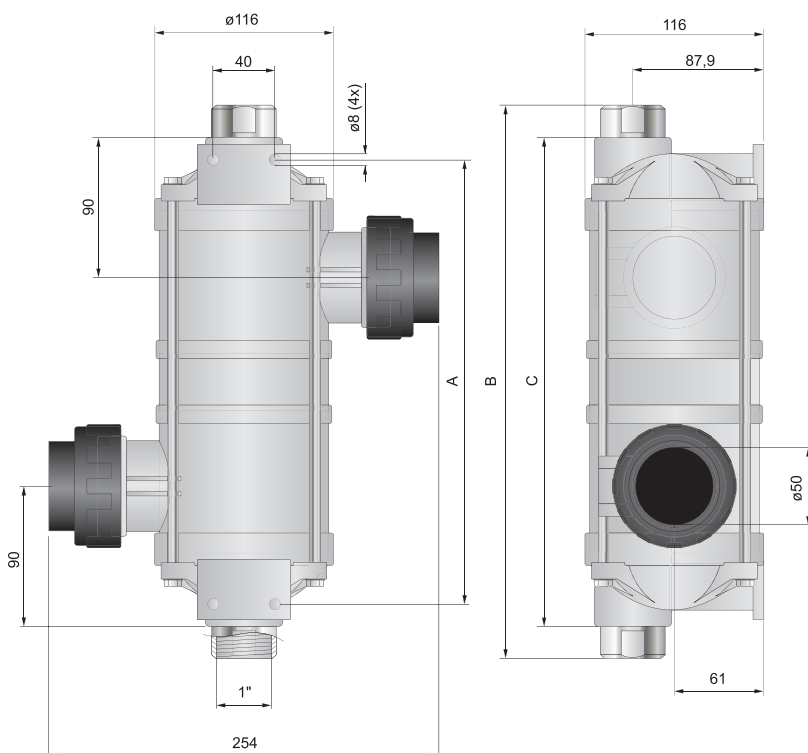

Dimensions

Item no.	kW	A	B	C
11322	40	418	375	277
11324	75	670	625	452

Also available with connections 1 1/2" pipe or 1 1/2" threaded, on secondary side.

Heat exchangers



Hi-Temp is a spiral heat exchanger made of thermoplastic with a high glass content for extra durability.

Hi-Temp 40-75kW

Hi-Temp is a spiral heat exchanger made of thermoplastic with a high glass content for extra durability, and with a coil of acid proof stainless steel.

Maximum pressure secondary circuit (pool water) is 4 bar and primary circuit (hot water) is 5 bar.

Suitable for pools up to 300 m³.

Features

- Outer jacket of thermoplastic
- Hot water coil made of acid proof stainless steel
- Integrated wall-mounting
- Slip connections for bonding of Ø 50 mm pipes
- Two sizes 40 and 75 kW
- Connects to existing heat source
- Mounted horizontally or vertically

Technical data

Item no.	Type	Capacity			Primary, hot water		Secondary, pool water		kg
		kW	kBtu/h	kcal	l/min	press. drop H (m)	l/min	press. drop H (m)	
11312	HT40	40	135	34 393	34	1.9	300	1.3	1.8
11314	HT75	75	260	64 488	43	5.5	300	1.7	2.3

Capacity at a temperature difference of 60°C

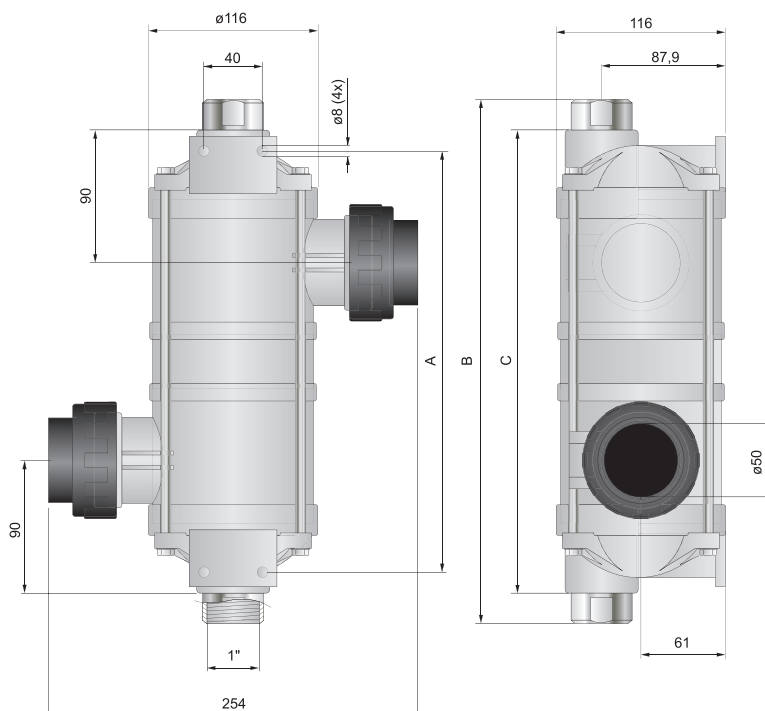

Dimensions

Item no.	kW	A	B	C
11312	40	277	360	315
11314	75	454	535	492

Also available with connections 1 ½" pipe or 1 ½" threaded, on secondary side.

Heat exchangers

Aqua MEX

Aqua MEX is made of high quality materials, fiberglass reinforced polypropylene and a high effective coil made of titanium. Our line gives the best possible heating capacity and resistance against aggressive water. Aqua MEX is compact, fully equipped, easy to install and use.

The heat exchanger has a straight flow with a low pressure drop and with slip connections for Ø 63 mm pipes.

Maximum pressure secondary circuit (pool water) is 4 bar and primary circuit (hot water) is 6 bar.

Aqua MEX fully equipped has a three-step single-phase built-in circulation pump for the primary (hot) water as well as built-in temperature sensor, flow switch and check valve. Digital temperature control and display.

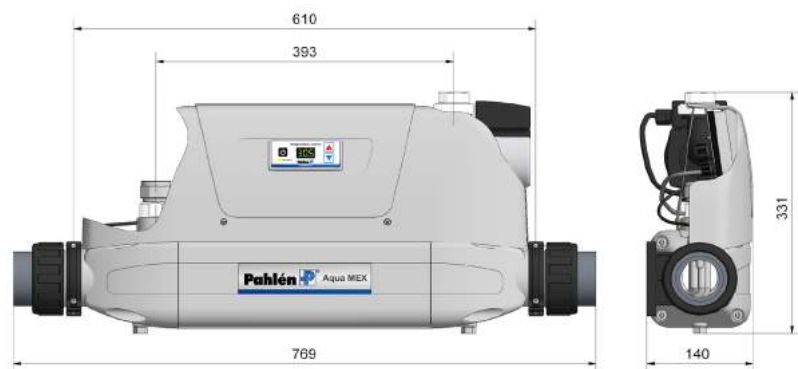

Features

- Aqua MEX fully equipped comes complete with flow switch, check valve, temperature sensor, three-step single-phase circulation pump and electronics
- Economic - lower installation and operation costs
- Capacity range 40, 70kW. Standard also available as 100kW
- Digital control and display
- The housing and cabinet are made of fiberglass reinforced polypropylene
- Straight flow Ø 63 mm (2") pipe
- Coil made of titanium or stainless steel
- Connects to existing heat source
- IP44 (International Protection Rating)
- Standard version without controller and pump
- Mounted horizontally

Aqua MEX Standard

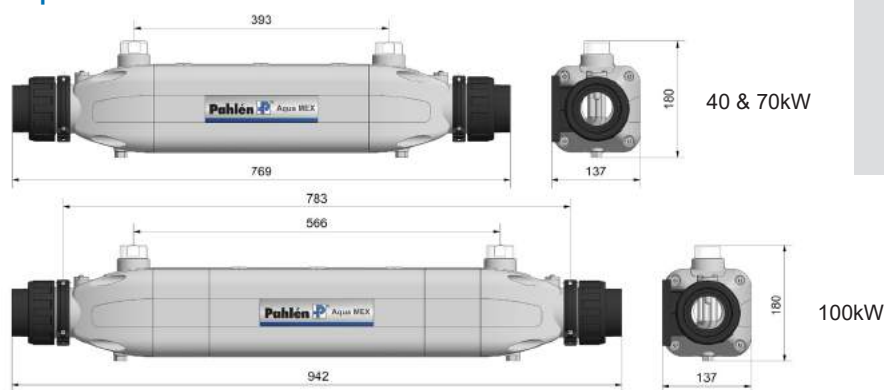

Item no. with T refers to the Aqua MEX with a coil of titanium.

Technical data

Item no.	Fully equipped	Item no.	Standard	Capacity			Primary, hot water		Secondary, pool water	
				kW	kBtu/h	kcal	l/min	press. drop H (m)	l/min	press. drop H (m)
113951	AM-FE40	11316	AM40	40	135	34 393	20	0.6	250	0.4
113952	AM-FE40T	11326	AM40T	40	135	34 393	20	0.4	250	0.5
113953	AM-FE70	11317	AM70	70	240	60 200	30	1.6	300	0.5
113954	AM-FE70T	11327	AM70T	70	240	60 200	30	1.4	300	0.6
		11318	AM100	100	340	86 000	40	2.5	340	0.7
		11328	AM100T	100	340	86 000	40	2.3	340	0.8

Capacity at a temperature difference of 60°C

Temperature control



MidiTemp

A compact unit for digital setting and view of temperature for operation and control of heating products, both in already existing or new installations. Control panel with on/off mode and programmable set value 5 - 45°C.

The controller has an input for external flow switch and/or overheating limit control. 230V output for operating a wide range of heating applications; heat exchangers, solar panels, electric heaters etc.

The controller will give a more precise temperature regulation compared to an analogue thermostat. Built-in safety features for overheat protection, flow switch for low pool circulation and alarm for temperatures above 45°C. Provides a safe operation for both users and pool components.

Item no.

128470 MidiTemp

Electronic digital control panel

- Built-in safety features for overheat protection for temperatures above 45°C
- Energy efficient
- Easy to set desired temperature
- Clear digits shows the pool temperature and the temperature set
- Indicates when heater is operating

Technical data

Power connection 220-240VAC 1~N 50Hz

Max effect 230W

Sealing class IP44

Dimensions L x W x H 170 x 50 x 160 mm

Connection cable 3 x 0,75 mm², 1.5 m long

Switch on at 0.5°C under set temperature

Switch off 0.5°C above set temperature

Connections

Control voltage 230 VAC 50Hz max 1A

Protection switches Potential free/dry contacts

Features

- Electronic control panel with LED
- Remote view and control
- Precise temperature setting
- Controller output gives 230V (max 1A) to control a variety of heating applications; e.g. pumps, contactors, valves etc.
- Length of sensor cable 1400 mm
- Built-in protection and alarm against excessive temperature or sensor failures
- Flow switch input with time-delayed output - heating aborted with alarm when reached low pool circulation



Sensor well/Saddle clamp



Flow switch

Accessories

Item no.

14009100 Sensor well R1/2" L=70 mm

128604 Saddle clamp 63 x 1/2" PN10 PP

12870 Flow switch, external connection 1/2"

Thermostat

For setting and automatic control of water temperature.

Item no. Temperature range Connection

12840 0-40°C R1/2"

Equipped with probe 160 mm.



Heat pump - An effective and energy saving alternative



Latest inverter technology heat pump with superior energy efficiency and quiet operation.

Effective and energy efficient heat pump designed to withstand harsh climates.

Heat pumps exploit the energy in the air, they are effective and energy efficient, easy to install and takes up little space near the pool. The pool heat pump is equipped with a quiet rotation compressor for optimal efficiency rating, minimal vibration and long service life. Digital control includes several functions and permits easy setting of pool temperature. The materials used in the heat pump are designed to withstand harsh climates. The casing is made of thermoplastic and the condenser, the pools heat exchanger, is made of titanium.

Heat pumps

5 YEAR WARRANTY
for compressor
and heat
exchanger.



PVP Inverter

Wide temperature range with a superior energy efficiency. Low noise emissions and starting currents. Five year warranty for compressor and heat exchanger.

Digital control with extended features. Monitors low and high pressures, low water flow and delta temperature (in/out).

The unit also controls the supply voltage and all sensors. Prepared for Wi-Fi control.

Tested according to the European standard EN14511 by an independent test institute TÜV.

Smart and silence mode

Silence mode is used for quieter operation at night. Smart mode adjusts automatically to the air temperature and water temperature for rapidly heating the pool to the desired temperature.

Accessories

Item no.

14983407	Ground stand for heatpump, PVP10, PVP13, PVP17
14983407	Wall stand for heatpump, PVP10, PVP13
14950181	Bypass-kit cc280-390, PVP10 - PVP17
14950182	Bypass-kit cc620-650, PVP28, PVP35

Features

- Frequency-controlled compressor
- Sizes from 9.8 - 27.5 kW
- Operation down to -7°C outdoor temperature
- Drip tray heater
- Electronic expansion valve
- Hot gas defrosting on demand
- Speed-controlled DC fan
- Large condenser surface area
- Superior COP and energy efficiency
- Wi-Fi modul as option

PVP inverter

Item no.		Type 10 14983311	Type 13 14983315	Type 17 14983316	Type 28 14983318	Type 35 14983317
Heating capacity in smart mode	Air +26°C, water +26°C**	2.1-9.8 kW	2.9-13.3 kW	3.4-17.3 kW	6.5-27.0 kW	7,0-35,2kW
	Air +15°C, water +26°C*	1.5-6.8 kW	2.1-9.4 kW	2.3-11.4 kW	4.5-18.0 kW	4,8-24,0kW
COP in smart mode	Air +26°C, water +26°C**	6.9-15.3	6.4-15.4	5.9-15.5	6.2-15.2	5.5-15.5
	Air +15°C, water +26°C*	4.6-7.7	4.4-7.8	4.3-7.8	4.5-7.9	4.5-8.0
COP at 50% capacity	Air +26°C, water +26°C**	10.7	10.6	10.8	11.0	10.6
	Air +15°C, water +26°C*	6.6	6.5	6.3	6.7	7.0
Sound pressure	at 1m dB(A)	38.6-49.9	41.3-54.0	43.1 -53.8	43.5-54.9	42.6-54.7
	at 10m dB(A)	18.6-29.9	21.3-34.0	23.1-33.8	23.5-34.9	22.6-34.7
Rated power at air +15°C (kW)		0.2-1.4	0.27-2.1	0.3-2.6	0.53-3.9	0.63-5.15
Rated operating current at air +15°C (A)		0.91-6.1	1.17-9.1	1.3-11.3	0.76-5.6	0.91-7.4
Electric connection		230V/1 ~			400V/3 ~	
Recommended water flow (m³/h)		3-4	5-7	6.5-8.5	10-12	12-18
Water connection in-out (mm)		Ø 50 mm				
Weight (kg)		49	52	63	93	117 kg
Refrigerant		R410A				
Refrigerant amount		0.85 kg	1.15 kg	1.25 kg	2.6 kg	3,0 kg
Recommended max pool volume		35 m³	60 m³	75 m³	120 m³	169 m³

*Data at air temperature +15°C/water +26°C/humidity 70%

**Data at air temperature +26°C/water +26°C/humidity 80%

Heating - Electric heaters, simple and effective



Simple installation in many effect sizes.

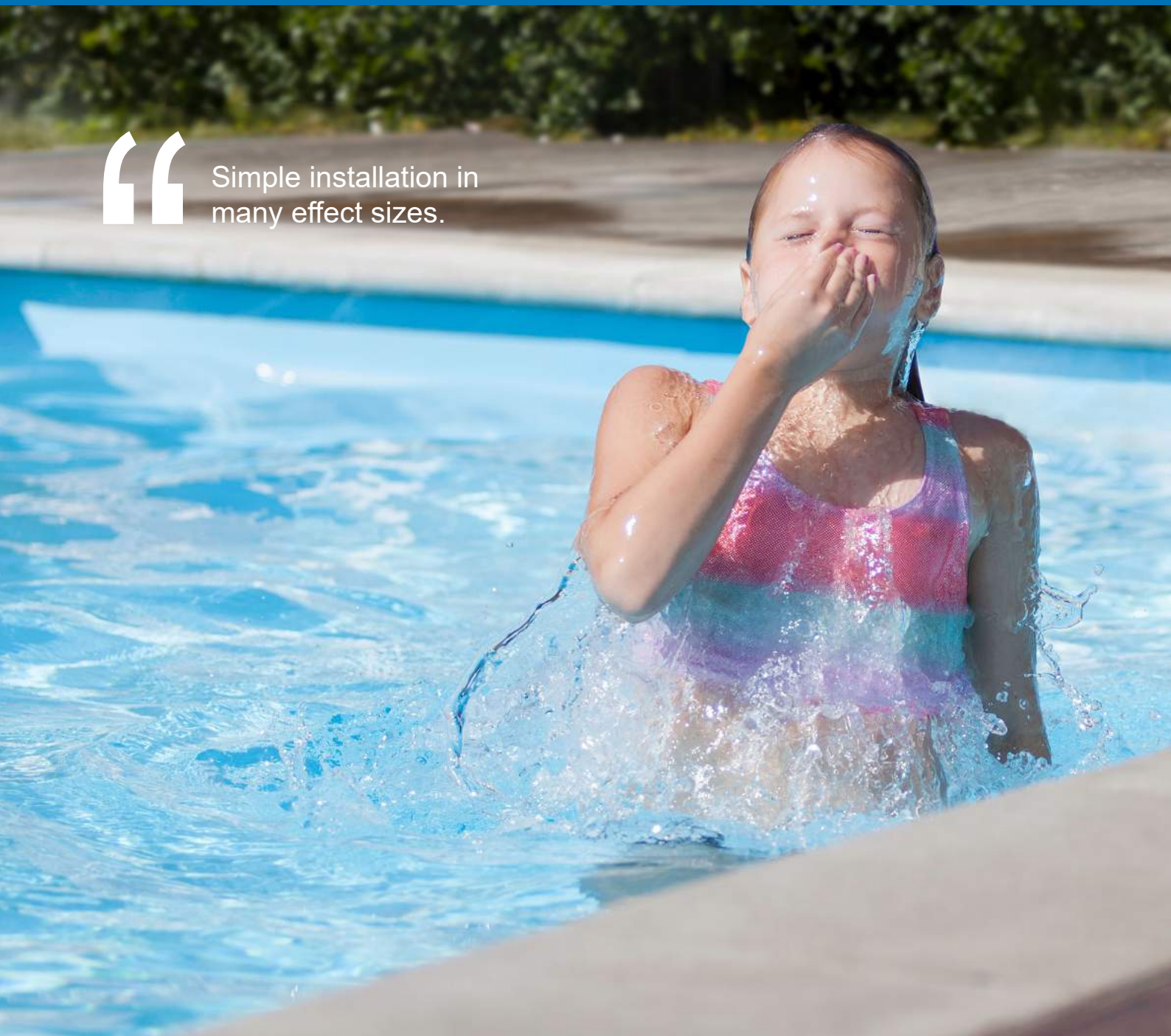

Pahlén's electric heaters heats the water easily and effectively. An electric heater is easy to be connected to the existing power mains in order to deliver full power round the clock. Water from the system flows through the heater and is heated by the heating element. The materials used are acid proof stainless steel, Incoloy 825, titanium and thermoplastic. All electric heaters are designed for continuous flow with the lowest possible pressure drop.

Electric heaters for all types of pools



Compact 3-18kW

Made of titanium/Nic-Tech or acid proof stainless steel/Incoloy 825. Supplied with thermostat, overheating cut out, a flow switch or pressure switch.



Aqua compact 3-18kW

Made of thermoplastic with heating element of Incoloy 825 or titanium. Supplied with thermostat, overheating cut out, flow switch.



Aqua spa 1.5-3.0kW

Made of thermoplastic with heating element of Incoloy 825. A small, compact heater for spa pools and small swimming pools. Adjustable thermostat, overheating cut out and flow switch are standard.



Aqua air 1.5kW

Made of acid proof stainless steel. Air heater supplied as standard with a thermostat and overheating cut out.



Aqua HL 3-15kW

Made of thermoplastic with heating element of Incoloy 825 or titanium. Electric swimming pool heater features digital control and electronic thermostat. Built-in overheating cut out and flow switch are standard.



MidiHeat 18-72kW

MidiHeat is manufactured from materials of the highest quality. With digital or analogue temperature control. Effective heater for larger swimming pools. Overheating cut out and flow switch are standard.

Electric heaters



Compact 3-18kW

Supplied with a thermostat and overheating cut out. A flow switch or pressure switch protects the heating element from damage if the flow to the heater is insufficient.

These electric heaters are available in both titanium/Nic-Tech and acid proof stainless steel/ Incoloy 825.

All compact electric heaters are delivered with a 2" heating element. Max. pressure: 4 bar.

Suitable for private pools up to 100 m³

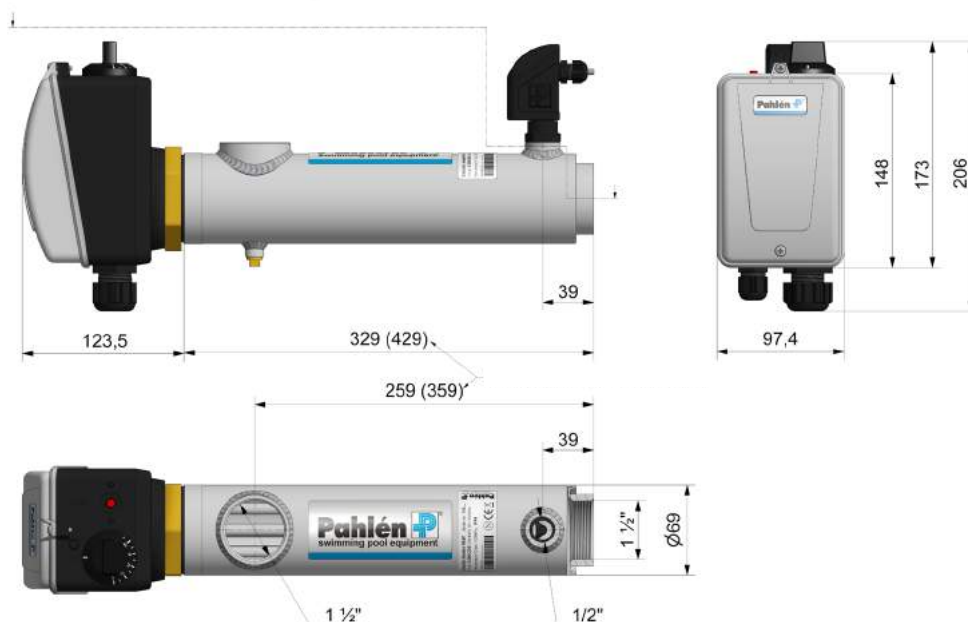

Dimensions for 9 - 18kW within brackets



Electric heaters

With pressure switch. Max 4 bar

Unipolar thermostat 0-45°C, pressure switch, tripolar high limit control 60°C

Item no.	Type	kW	Ampere 3-phase		kg
			230V	400V	
13982206	13P60	6.0	15	9	2.8
13982209	13P90	9.0	23	14	3.2
Unipolar thermostat 0-45°C, pressure switch, unipolar high limit control 60°C					
13982403	11P30	3.0	8	5	2.8
13982406	11P60	6.0	15	9	2.8
13982409	11P90	9.0	23	14	3.2
13982412	11P120	12.0	31	18	3.2
13982415	11P150	15.0	38	22	3.2
13982418	11P180	18.0	46	27	3.2

With flow switch. Max 2.5 bar

Unipolar thermostat 0-45°C, flow switch, unipolar high limit control 60°C

Item no.	Type	kW	Ampere 3-phase		kg
			230V	400V	
13981403*	11F30*	3.0	8	5	2.4
13981406*	11F60*	6.0	15	9	2.4
13981409*	11F90*	9.0	23	14	2.7
13981412*	11F120*	12.0	31	18	2.7
13981415*	11F150*	15.0	38	22	2.7
13981418*	11F180*	18.0	46	27	2.7
Tripolar high limit control 60°C, flow switch					
13981506	03F60	6.0	15	9	2.9
13981509	03F90	9.0	23	14	3.3

With flow switch. Max 2.5 bar

Unipolar thermostat 0-45°C, flow switch, tripolar high limit control 60°C

Item no.	Type	kW	Ampere 3-phase		kg
			230V	400V	
13981203	13F30	3.0	8	5	3.1
13981206	13F60	6.0	15	9	3.1
13981209	13F90	9.0	23	14	3.1
Unipolar high limit control 60°C, flow switch					
13981306	01F60	6.0	15	9	2.9
13981309	01F90	9.0	23	14	3.3
13981312	01F120	12.0	31	18	3.3
13981315	01F150	15.0	38	22	3.3
13981318	01F180	18.0	46	27	3.3

*Available with outer jacket made of titanium and Nic-Tech treated heating element. These heaters are designed for pools with very aggressive water, large quantities of chlorides and where there is a high risk for corrosion, e.g. in pools with salt water.

When ordering titanium model, choose compact electric heater and add a "T" after the item no. Applies to the following article 139814xxT.

Technical data

	With flow switch	With pressure switch
Max temperature	60°C	60°C
Max pressure	2.5 bar	4 bar
Min. flow 3-9kW	85 l/min	20 l/min
Min. flow 12-18kW	85 l/min	40 l/min

Features

- Body and pipework of acid proof stainless steel
- Heating elements of Incoloy 825
- Selected models with body made of titanium and Nic-Tech treated heating elements
- Equipped with thermostat, overheating cut out and flow switch
- Small and compact
- Adjustable brackets of acid proof stainless steel
- Connection 1 1/2"

Pressure drop

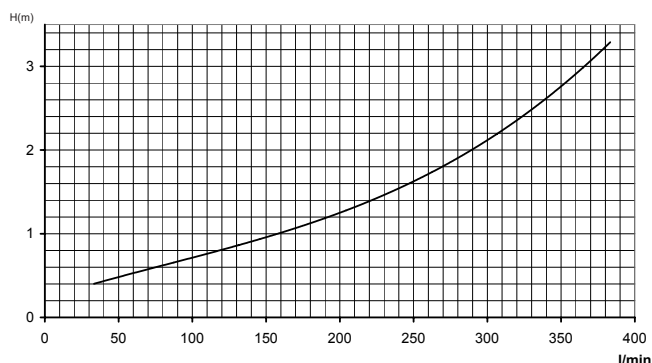

For installations where aggressive water increases the risk of corrosion, we recommend a body of titanium with a Nic-Tech treated heating element.

Electric heaters



Aqua compact 3-18kW

Electric heater made of thermoplastic for extra strength. Heating element made of Incoloy 825 or titanium for extra safety in installations where there is a high risk of corrosion, e.g. salt water pools.

Supplied with a thermostat for adjusting pool temperature as well as overheating cut out and flow switch. Minimum flow 90 l/min.

Max. pressure: 2.5 bar.

Suitable for private pools up to 100 m³

Technical data

Heating element Incoloy 825			Heating element titanium			kW	Ampere 3-phase	
Item no.	Type	kg	Item no.	Type	kg		230V 3~	400V 3~
141600	AC30	1.7	141600T	AC30T	1.7	3.0	8	5
141601	AC60	1.7	141601T	AC60T	1.7	6.0	15	9
141602	AC90	1.7	141602T	AC90T	1.7	9.0	23	14
141603	AC120	2.2	141603T	AC120T	2.1	12.0	31	18
141604	AC150	2.2	141604T	AC150T	2.1	15.0	38	22
141605	AC180	2.2	141605T	AC180T	2.1	18.0	46	27

Also available with connections 1 ½" pipe add a "A" after the item no. or 1 ½" threaded add a "B" after the item no.

Features

- Electric heater made of fiberglass reinforced thermoplastic
- Housing of thermoplastic
- Horizontal installation, eliminates air pockets and damage to the electric heating element
- Heating elements of Incoloy 825 or titanium
- Equipped with overheating cutout and flow switch
- Slip connections for bonding of Ø 50 mm pipes

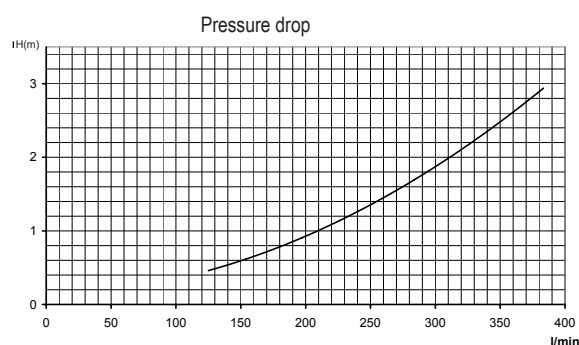
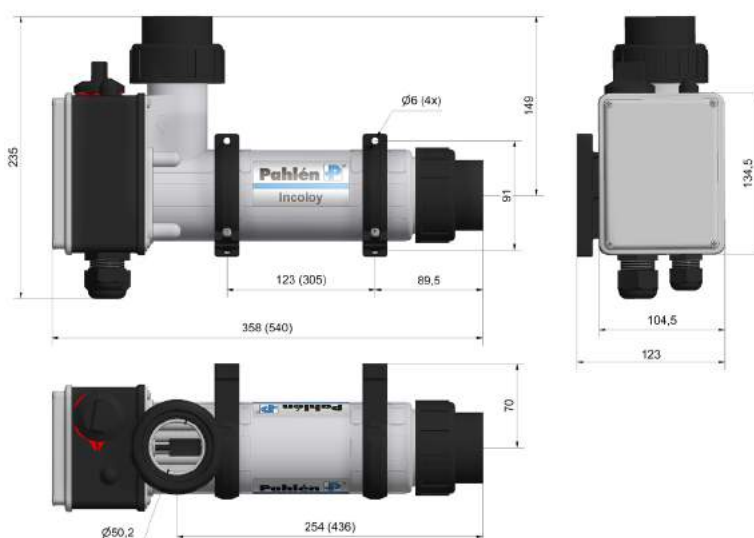

For pools with salt water or chlorinator we recommend a heating element of titanium.

Dimensions for 12 - 18kW within brackets

Electric heaters



Aqua spa 1.5-3.0kW

A small, compact heater for spa pools and small swimming pools. It is available with capacities from 1.5 to 3 kW.

The heater is made of thermoplastic and has a heating element made of Incoloy 825. Adjustable thermostat, overheating cut out and flow switch are standard.

Minimum flow 90 l/min. 1-phase 230V.

Suitable for spa, hot tubs and smaller pools.

Technical data

Item no.	Type	kW	Length mm	Pipe connection	Amp.	kg
141650	AS15	1.5	200	Ø 50 mm	7	1.0
141651	AS20	2.0	200	Ø 50 mm	9	1.0
141652	AS30	3.0	200	Ø 50 mm	13	1.0

Also available with connections 1 ½" pipe add a "A" after the item no.
or 1 ½" threaded add a "B" after the item no.

Features

- Three capacities: 1.5kW, 2kW and 3kW
- Housing of thermoplastic
- Minimal dimensions
- Heating element of Incoloy 825
- Equipped with thermostat 0-45°C
- Overheating cut out and flow switch
- Slip connections for bonding of Ø 50 mm pipes

Specially designed for smaller pools and hot tubs. Small and compact making it easy to install in areas with limited space.

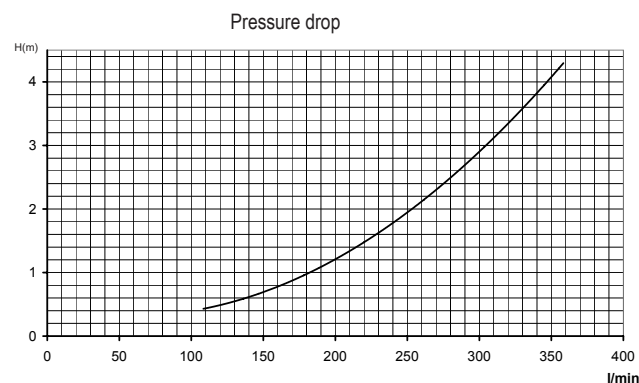
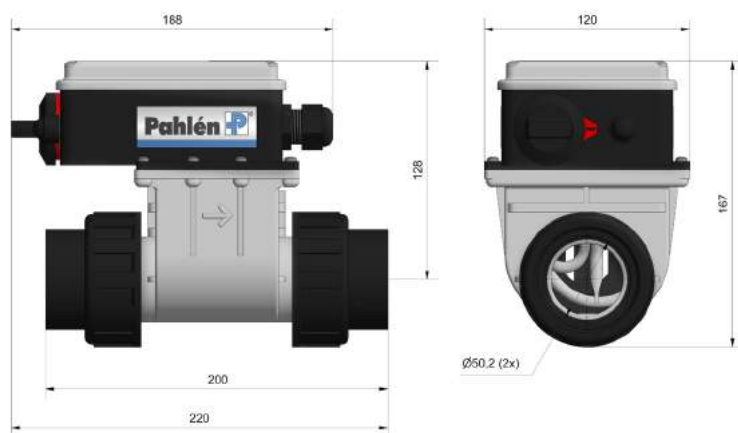

Electric heaters



Aqua air 1.5kW

Air heater is for instance used for air massage in spa pools. The incoming air is heated and mixed with the water.

The heater has a power output of 1.5 kW and is made of acid proof stainless steel. Supplied as standard with a thermostat and overheating cut out.

1-phase 230V.

Suitable for all types of hot tubs and spas.

Technical data

Item no.	kW	Length mm	Pipe connection	Amp.	kg
12700	1.5	360	Ø 51 mm	7	2.5

Features

- Made of acid proof stainless steel
- Minimal dimensions
- Adjustable thermostat 30-80°C
- Heating element acid proof stainless steel
- Overheating cut out
- Ø 51 mm pipes

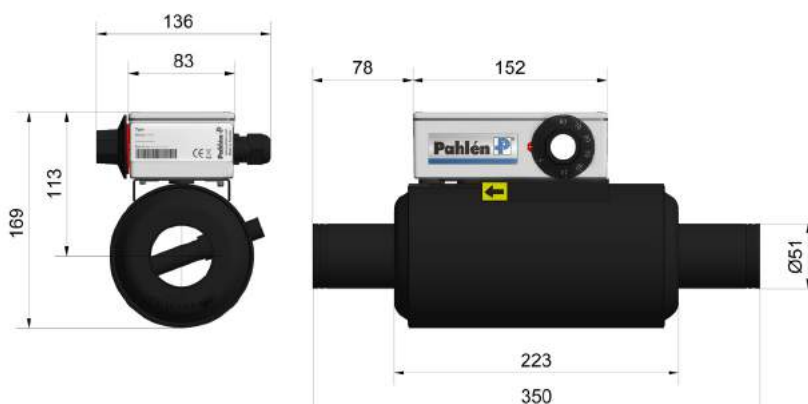
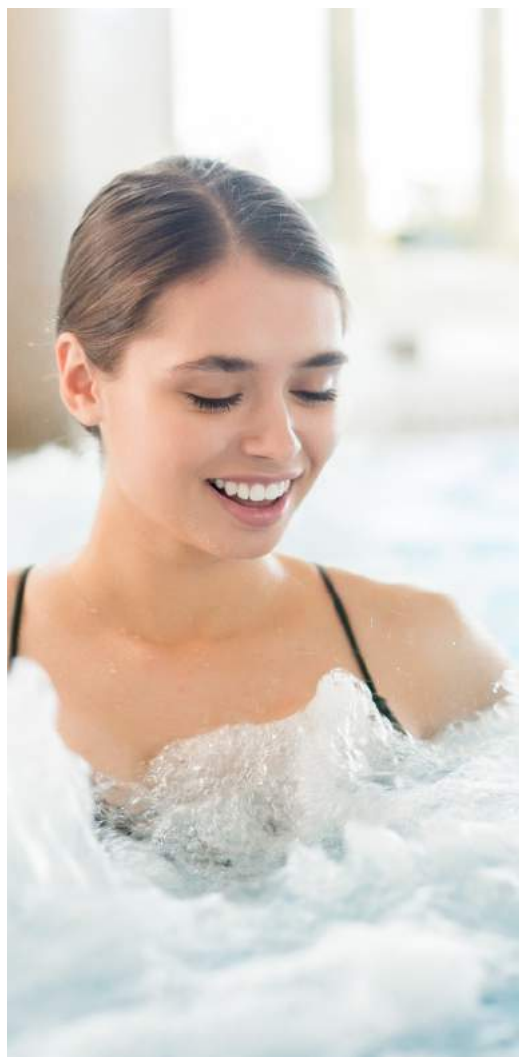

Heat the incoming air in your hot tub easily and effectively with Pahlén's electric air heater.

Electric heaters

Aqua HL 3-15kW

Aqua HL has a digital control, where the desired pool temperature can easily be set and the current pool temperature is shown in the LED display. In addition to an overheating protection and a flow switch, the heater has built-in contactors, that simplifies the connection of the heater.

Rated output 3-15 kW. Made of thermoplastic with heating element made of Incoloy 825 or titanium.

Suitable for private pools up to 100 m³.
Minimum flow 90 l/min.

Features

- Capacity range 3-15kW
- Aqua HL comes with contactors and electronics
- Digital control and display
- Made of reinforced thermoplastic
- Horizontal installation
- Heating elements of Incoloy 825 or titanium
- Equipped with overheating limit control and flow switch
- Dual built-in contactors as per electrical safety standards
- Third-party tested and certified
- Slip connections for bonding of Ø 50 mm pipes



Dimensions for 12 - 15kW within brackets

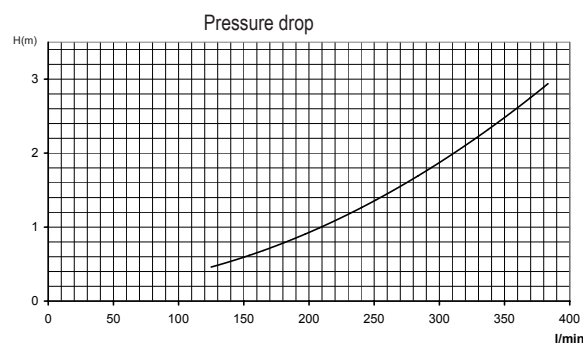

Technical data

Heating element, Incoloy 825			Heating element, titanium			Ampere 3-phase/kW	Ampere 3-phase/kW
Item no.	Type	kg	Item no.	Type	kg	400V	415V
141800	D30	2.6	141800T	D30T	2.6	3.0kW 5A	3.5kW 5A
141801	D60	2.6	141801T	D60T	2.6	6.0kW 9A	6.5kW 9A
141802	D90	2.6	141802T	D90T	2.6	9.0kW 13A	10kW 14A
141803	D120	3.0	141803T	D120T	3.0	12.0kW 18A	13kW 18A
141804	D150	3.0	141804T	D150T	3.0	15.0kW 22A	16.2kW 23A
						1-phase 230V	3-phase 230V
141820	DS30-230	2.6	141820T	DS30T-230	2.6	3.0kW 13A	-
141821	DS60-230	2.6	141821T	DS60T-230	2.6	6.0kW 26A	-
141830	D30-230	2.6	141830T	D30T-230	2.6	-	3kW 8A
141831	D60-230	2.6	141831T	D60T-230	2.6	-	6kW 15A
141832	D90-230	2.6	141832T	-	2.6	-	9kW 23A

Electric heaters

MidiHeat 18-72kW

MidiHeat is manufactured from materials of the highest quality. The casing made of powder coated zinc sheet not only gives the product a very stable construction, it also makes the product highly resistant against corrosion.

MidiHeat has a temperature range of 8-45°C. Heating elements of titanium does not only make the heating highly effective, it also makes the heating element fully corrosion free.

Additional safety

For the optimal safety and in accordance with applicable electrical safety standards MidiHeat has two built-in contactors for each heating element. A built-in flow switch and an over-heating protection accompanied by an external input for pool water circulation.

Connections for bonding of Ø 63 mm tube.
Minimum Flow 170 l/min. Max flow 300 l/min.
Max pressure: 2 bar.

MidiHeat functions extremely well in fresh water pools and in pools fitted with a salt chlorinator.

MidiHeat is also available in an analog version.

Fast and efficient heating in an new smart design, modern materials and built for the future.



Electric heaters



Digital control panel for the MidiHeat Digital

- Digital temperature control 8-45°C
- Master-/slave - connect up to nine heaters and control them with a master
- Activation delay - adjustable delay time for sequential start of the heating elements, 5-60 seconds
- Temperature offset - manually adjust the actual pool temperature, up to $\pm 4^\circ\text{C}$
- Restore factory settings - option for resetting all settings
- Error codes - automatic storing of the last ten error messages

Features

- MidiHeat has two built-in contactors for each element
- Capacity 18-72kW
- Connect up to nine heaters and control them with a master unit
- MidiHeat is made of powder coated zinc sheet. Heat barrel in glass-fiber reinforced polypropylene
- Heating elements of titanium
- Equipped with overheating limit control and flow switch
- Third-party tested and certified

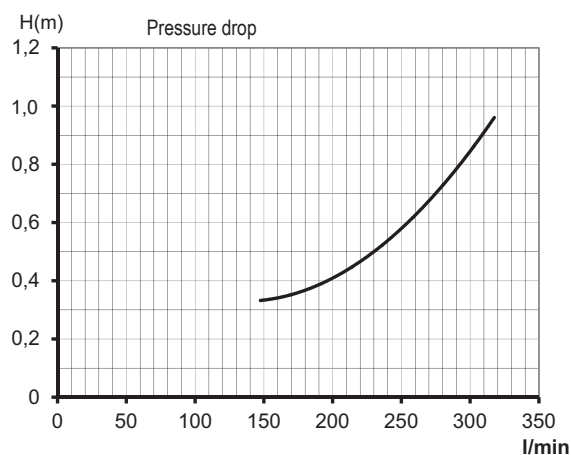

Technical data for MidiHeat Digital EHD 380-415V/230V

Capacity	Item no.	3~400V	3~415V	Item no.	3~230V	Connec- tion Ø 63	Min.flow 170 l/min	Max. flow 300 l/min	Max press. 2 bar
18kW = 2x9kW	1511018T	18kW 26A	19,5kW 27A	1511218T	18kW 45A	•	•	•	•
24kW = 2x12kW	1511024T	24kW 35A	26kW 36A	1511224T	24kW 61A	•	•	•	•
30kW = 2x15kW	1511030T	30kW 43A	32kW 45A	1511230T	30kW 74A	•	•	•	•
36kW = 3x12kW	1511036T	36kW 52A	39kW 54A	1511236T	36kW 90A	•	•	•	•
45kW = 3x15kW	1511045T	45kW 66A	49kW 69A	1511245T	45kW 114A	•	•	•	•
60kW = 4x15kW	1511060T	60kW 87A	65kW 90A	1511260T	60kW 151A	•	•	•	•
72kW = 4x18kW	1511072T	72kW 104A	78kW 108A	-	-	•	•	•	•

Technical data MidiHeat Analog EHA 380 - 415V/230V

Capacity	Item no.	3~400V	3~415V	Item no.	3~230V	Connec- tion Ø 63	Min.flow 170 l/min	Max. flow 300 l/min	Max press. 2 bar
18kW = 2x9kW	1512018T	18kW 26A	19,5kW 27A	1512218T	18kW 45A	•	•	•	•
24kW = 2x12kW	1512024T	24kW 35A	26kW 36A	1512224T	24kW 61A	•	•	•	•
30kW = 2x15kW	1512030T	30kW 43A	32kW 45A	1512230T	30kW 74A	•	•	•	•
36kW = 3x12kW	1512036T	36kW 52A	39kW 54A	1512236T	36kW 90A	•	•	•	•
45kW = 3x15kW	1512045T	45kW 66A	49kW 69A	1512245T	45kW 114A	•	•	•	•
60kW = 4x15kW	1512060T	60kW 87A	65kW 90A	1512260T	60kW 151A	•	•	•	•
72kW = 4x18kW	1512072T	72kW 104A	78kW 108A	-	-	•	•	•	•

Underwater lighting - Creates a pleasant atmosphere



Create a beautiful pool with **Pahlén lights**. An exclusive light series for those who are in search for high quality and appearance. The polished stainless steel front raises the quality feel in your pool.

Swimming pool lighting



Marine

Made of acid proof stainless steel with polished front.
Available in PAR 56 halogen and LED.



Classic

Made of acid proof stainless steel with polished front.
Available in PAR 56 halogen and LED.



200 lights

Made of acid proof stainless steel with polished front.
Easy to install in the pool.



LED spots

Made of acid proof stainless steel. Available in warm or cold white and RGB.



External lights

Made of acid proof stainless steel with polished front.
Easy to install in existing pools.



Accessories

Stainless steel junction box, cable conduit, safety transformer and niche fixtures.

Pool lighting recommendations



Do you care about the environment and at the same time think economically long term? Choose LED in your lights and you will lower your power consumption, which favours your wallet and the environment.



Our recommendations

Poolsize	Rec. number of inlet	Rec. number of skimmer	Rec. number of lights
3 x 6 m <30 m ³	2	1	1
4 x 8 m <50 m ³	2	1	2
5 x 10 m <75 m ³	4	2	3
6 x 12 m <110 m ³	4	2	4

Lights



LED



300

Marine LED/300

Swimming pool lighting made of acid proof stainless steel with polished front. Under water lighting in the pool creates a pleasant atmosphere. Pool lights makes it possible to use the pool around-the-clock, at the same time as it provides added safety when swimming in the evening.

Features

WITH LED

- Supplied with a 4 m long 2-wire connecting cable
- LED lamp and cable in one unit. No loose parts, easy to replace
- RGB with 16 different programs, 25W, 1450 Lumen, 120° angle
- White LED, 28W, 2100 Lumen, 9000 Kelvin, 120° angle

Features

WITH STANDARD PAR 56 300W halogen

- Complete unit for simple installation
- Supplied with a 2.5 m long 2-wire connecting cable
- The water level does not need to be lowered when replacing bulbs
- Easy to replace. Glass and reflector in one unit
- White, 3800 Lumen, 2700 Kelvin

Concrete pool

Item no.	Type	
124281	A-25RGB	LED RGB colored 25W, 12V, IP68. Complete unit with niche.
124381	A-28CW	LED White 28W, 12V, IP68. Complete unit with niche.
124380	A-2	PAR56 White 300W, 12V, IP68. Complete unit with niche.

Liner pool

Item no.	Type	
124291	CA-25RGB	LED RGB colored 25W, 12V, IP68. Complete with lamp unit, niche, gasket, screws and a flange.
124391	CA-28CW	LED White 28W, 12V, IP68. Complete with lamp unit, niche, gasket, screws and a flange.
124390	CA-2	PAR56 White 300W, 12V, IP68. Complete with lamp unit, niche, gasket, screws and a flange.
124710	Replacement kit for upgrading Classic existing lighting to Marine.	
15530127	Fixing kit for Marine 300 CA fiberglass/PP pool	
822610	Concrete kit for 300 light, waterproofing with membrane	

Accessories see page 55.

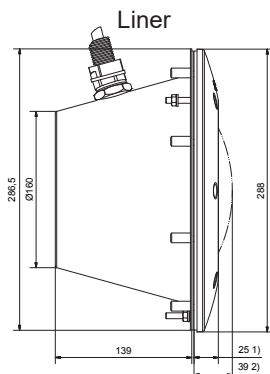
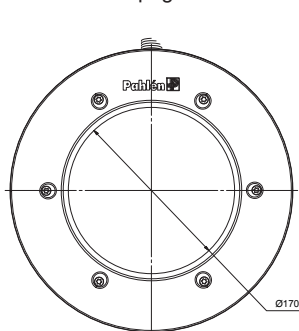

- 1) LED lights
2) PAR56 lights

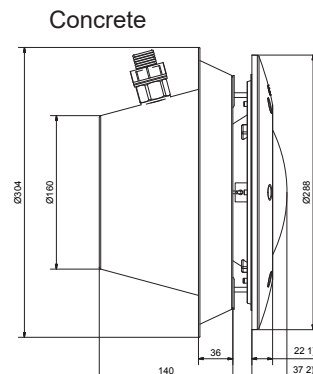

- 1) LED lights
2) PAR56 lights

Lights



Classic LED

Swimming pool LED light with 16 different programs that provide a fantastic light display in the pool. The LED lights produce a soft and pleasant glow, they are energy effective.

The swimming pool lighting can also be set to produce a fixed glow in red, green, blue or white. Also available in a version with just a fixed white glow.

Made of acid proof stainless steel with polished front. Suits all types of installations. Supplied as a complete unit with a niche for simple installation.

Accessories see page 55.

LED RGB colored, 25W, 12V, IP68

Item no. Type

123281	A-25RGB	For concrete pools. Supplied complete with niche.
123291	CA-25RGB	For liner pools. Supplied complete with lamp unit, niche, gasket, screws and a flange.

LED white, 28W, 12V, IP68

Item no. Type

123381	A-28CW	For concrete pools. Supplied complete with niche.
123391	CA-28CW	For liner pools. Supplied complete with lamp unit, niche, gasket, screws and a flange.

Features

- Acid proof stainless steel
- LED lamp and cable in one unit
- Supplied as standard with a 4 m long 2-wire connecting cable
- RGB with 16 different programs, 25W, 1450 Lumen, 120° angle
- White LED, 28W 2100 Lumen, 9000 Kelvin, 120° angle
- Colour synchronization with installation of more than one coloured light through mutual transformer
- Suitable for all types of swimming pools

Accessories

Item no.

822610	Concrete kit for 300 light, waterproofing with membrane
--------	---

More accessories see page 55.

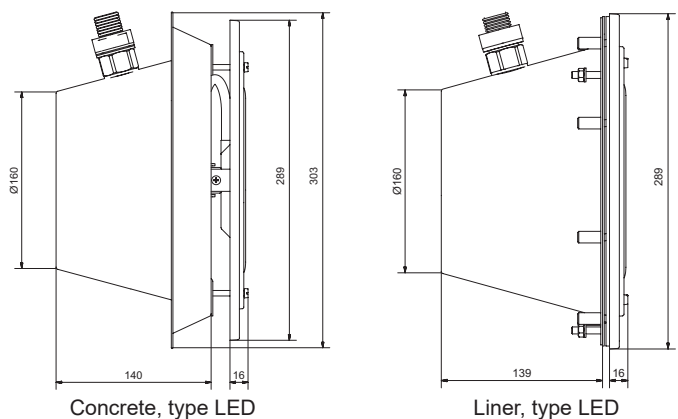
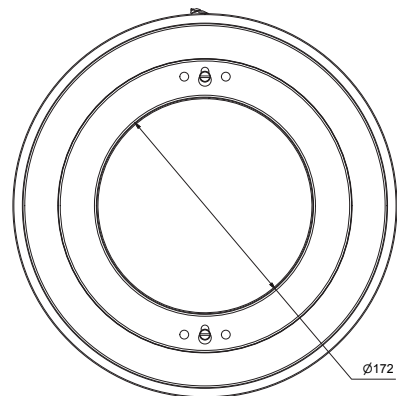

Lights



Classic 300

Swimming pool lighting made of acid proof stainless steel with polished front. Supplied as a complete unit with a niche for simple installation. PAR 56, 300W, halogen.

Features

- Polished front
- Made of acid proof stainless steel
- PAR 56 300W, halogen, type Sealbeam, glass and reflector in one unit
- 3800 Lumen, 2700 Kelvin
- Type 300 supplied as standard with a 2.5 m long 2-wire connecting cable
- The water level does not need to be lowered when replacing bulbs
- Suitable for all types of swimming pools

300W, 12V, IP68

Item no.	Type	
12250	A-2	With 2.5 m cable. For concrete pools. Supplied complete with niche.
12250M5	A-5	As above with 5 m cable.
12250M10	A-10	As above with 10 m cable.
12250M15	A-15	As above with 15 m cable.
12270	CA-2	With 2.5 m cable. For liner pools. Supplied complete with lamp unit, niche, gasket, screws and a flange.
12270M5	CA-5	As above with 5 m cable.
12270M10	CA-10	As above with 10 m cable.
12270M15	CA-15	As above with 15 m cable.

Under water lighting creates a pleasant atmosphere, makes it possible to use the pool around-the-clock and provides extra safety when swimming in the evening.

Accessories

Item no.	
15530123	Fixing kit for Classic 300 CA fiberglass/PP pool
822610	Concrete kit for 300 light, waterproofing with membrane

Accessories see page 55.

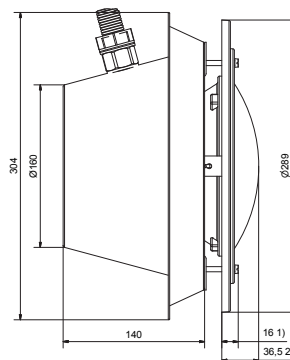
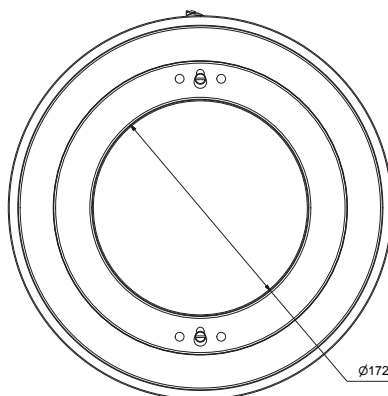

Concrete type 300A

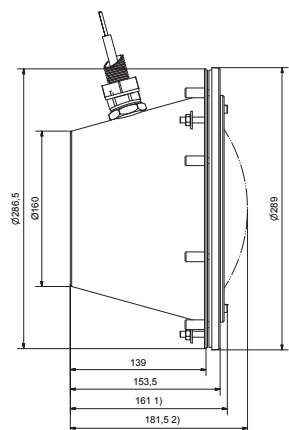

Liner type 300CA

Lights

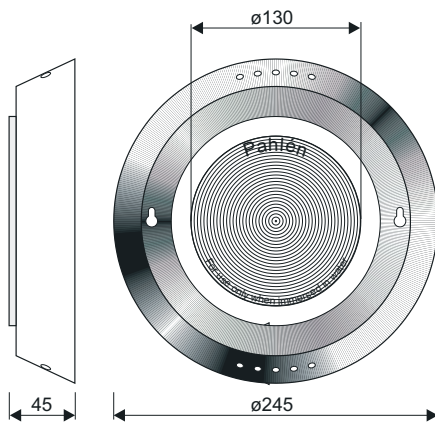

Light 200

Swimming pool light made of acid proof stainless steel with polished front. Equipped with tempered glass and two 75W halogen bulbs.

Features

- Polished front
- Made of acid proof stainless steel
- Halogen bulbs
- Supplied as standard with a 2.5 m long 2-wire connecting cable
- The water level does not need to be lowered when replacing bulbs
- Suitable for all types of swimming pools

Mounting kit



122602

122601

Item no.

122600 Halogen 150W (2 x 75W). Mounting kit is not included.

Accessories

- | | |
|--------|---|
| 122610 | Same as item no. 122600 but including high temperature cut out. Mounting kit is not included. |
| 122601 | Mounting kit for liner pools, complete with brackets, screws and water tight cable gland. |
| 122602 | Mounting kit for concrete pools, complete with brackets, screws and water tight cable gland. |



Non leak flange

Spa light

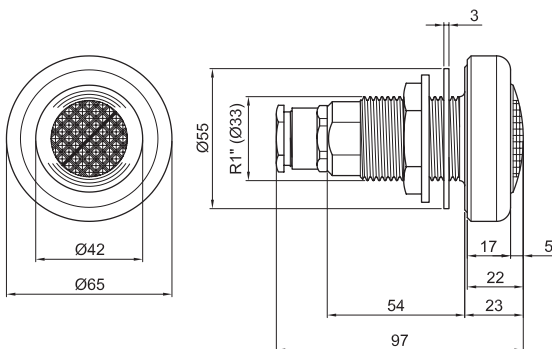

Spa light

Spa light ideal for lighting in spas, pool stairs, fountains or as spotlights in the pool.

The front is made of polished acid proof stainless steel, with the lamp housing made of chromeplated brass. Supplied as a complete unit and suits all installations.

Spa light 50W

Item no.

- | | |
|----------|--|
| 12265 | This unit is supplied as standard with 2.5 m heat resistant silicon cable, fittings and gaskets. |
| 12265M15 | As above with 15 m cable. |
| 12631 | Non leak flange for concrete pool |
| 12632 | Non leak flange for liner pool |

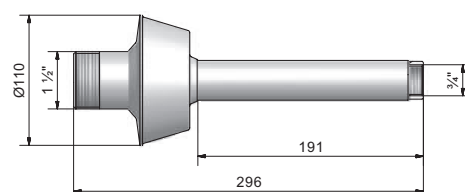

Lights

Classic



Marine

Spotlight LED

Spotlight ideal for lighting in spas, pool stairs, fountains or as spotlights in the pool. Made of acid proof stainless steel with a polished front. Supplied as a complete unit.

Cold and warm white are dimmable.

Spotlight LED

Art.nr.	Typ	
125840	CA-6CW	Spotlight LED Classic 350, cold white
125841	CA-6WW	Spotlight LED Classic 350, warm white
125842	CA-10RGB	Spotlight LED Classic 350, RGB
124840	CA-6CW	Spotlight LED Marine 350, cold white
124841	CA-6WW	Spotlight LED Marine 350, warm white
124842	CA-10RGB	Spotlight LED Marine 350, RGB
822600	Concrete kit for 300 light, waterproofing with membrane	

Features

- Polished front
- Acid proof stainless steel
- For fitting in pool walls, stairs etc
- For pools with liner
- For concrete/Insulating blocks, length 350 mm
- Cold white, 6W, 600 Lumen, 5000 Kelvin, 116° angle
- Warm white, 6W, 540 Lumen, 3300 Kelvin, 116° angle
- Color RGB, 10W 400 Lumen, 116° angle
- 12V

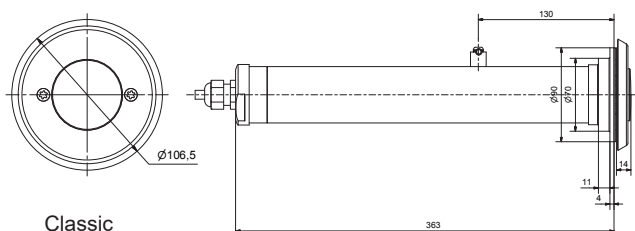

Classic

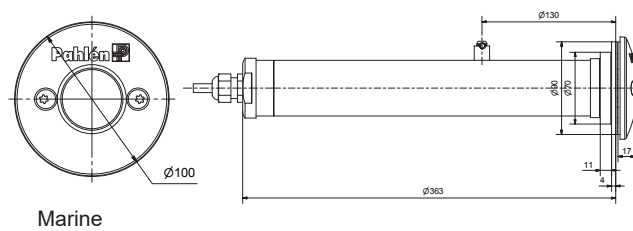

Marine

Spotlight LED

Art.nr.	Typ	
125845	CA-6CW	Spotlight LED Classic, cold white
125846	CA-6WW	Spotlight LED Classic, warm white
125847	CA-10RGB	Spotlight LED Classic, RGB
124845	CA-6CW	Spotlight LED Marine, cold white
124846	CA-6WW	Spotlight LED Marine, warm white
124847	CA-10RGB	Spotlight LED Marine, RGB



Classic



Marine

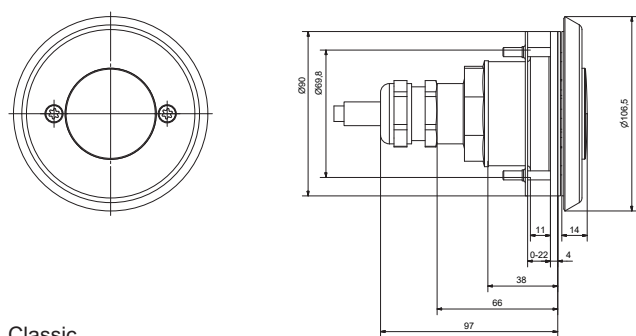

Classic

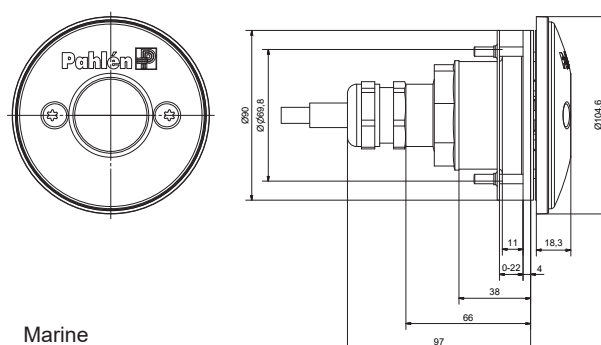

Marine

Lights

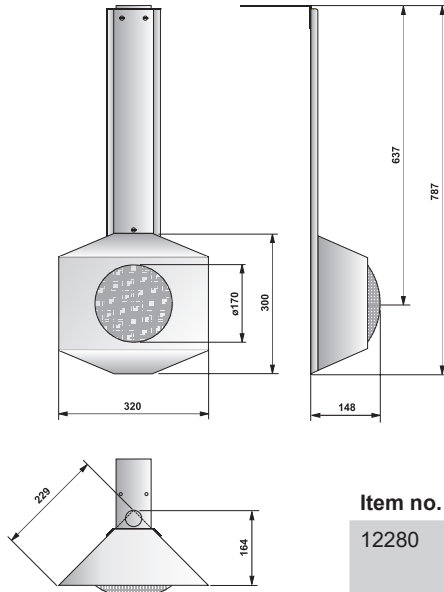

External corner light

With a polished light unit made of acid proof stainless steel for optimum finish and quality.

Easy to install in existing pools.

Highly effective PAR 56 bulb, 300W, halogen.

Item no. Type

12280	304	External light 300W, 12V, IP68 for mounting in the pool corner. Delivered with polished attachment for mounting under the pool coping or deck.
-------	-----	--

Features

- Polished front
- Made of acid proof stainless steel
- PAR 56 300W, halogen, glass and reflector in one unit
- Supplied as standard with a 2.5 m long 2-wire connecting cable
- The water level does not need to be lowered when replacing bulbs
- Easy to replace. Glass and reflector in one unit
- Suitable for all types of pools
- Suitable for existing pools

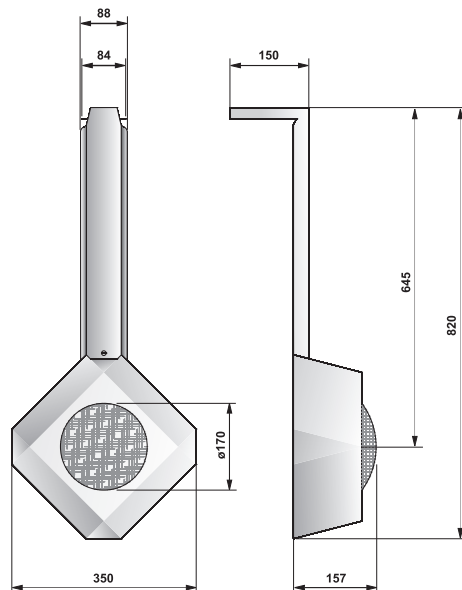

External wall light

With a polished light unit made of acid proof stainless steel for optimum finish and quality.

Easy to install in existing pools.

Highly effective PAR 56 bulb, 300W, halogen.

Item no. Type

12290	303	External light 300W, 12V, IP68 for mounting on the pool wall. Delivered with polished attachment for mounting under the pool coping or deck.
-------	-----	--

Accessories



Cable conduit

Accessories. Protects the cable between the junction box and the lamp unit.

Item no.

- | | |
|-------|---|
| 12330 | Protects the cable between the junction box and the lamp unit, length 900 mm. |
| 12854 | Joining sleeve internal 3/4" PVC. For extension of cable conduit. |



Safety transformer

Accessories. Transformer with built-in fuse.

Item no.

- | | |
|-------|---|
| 12340 | Transformer 300W, 12/230V, IP54 with built-in fuse. |
| 12273 | Transformer 60W, 12/230V, IP54 with built-in fuse. |



Junction box

Accessories. Stainless steel junction box for jointing between lights and transformer. Connection 3/4" for cable conduit. Sealing sleeve PG16.

Item no.

- | | |
|-------|---|
| 12310 | Cable seal in the base, with attachment for cable conduit and connection block. |
|-------|---|



Niche fixtures

Accessories. Niche fixtures in stainless steel. Recommended for wall type concrete with liner. Recommended for concrete liner pools.

Item no.

- | | |
|--------|--|
| 112900 | Niche fixtures, for lights and skimmers, set of 4. |
|--------|--|

Concrete kit

Accessories

- | | |
|--------|--|
| 822610 | For 300 light, waterproofing with membrane |
|--------|--|

Due to **service** and **parts**, we recommend **Pahlén original accessories** only.

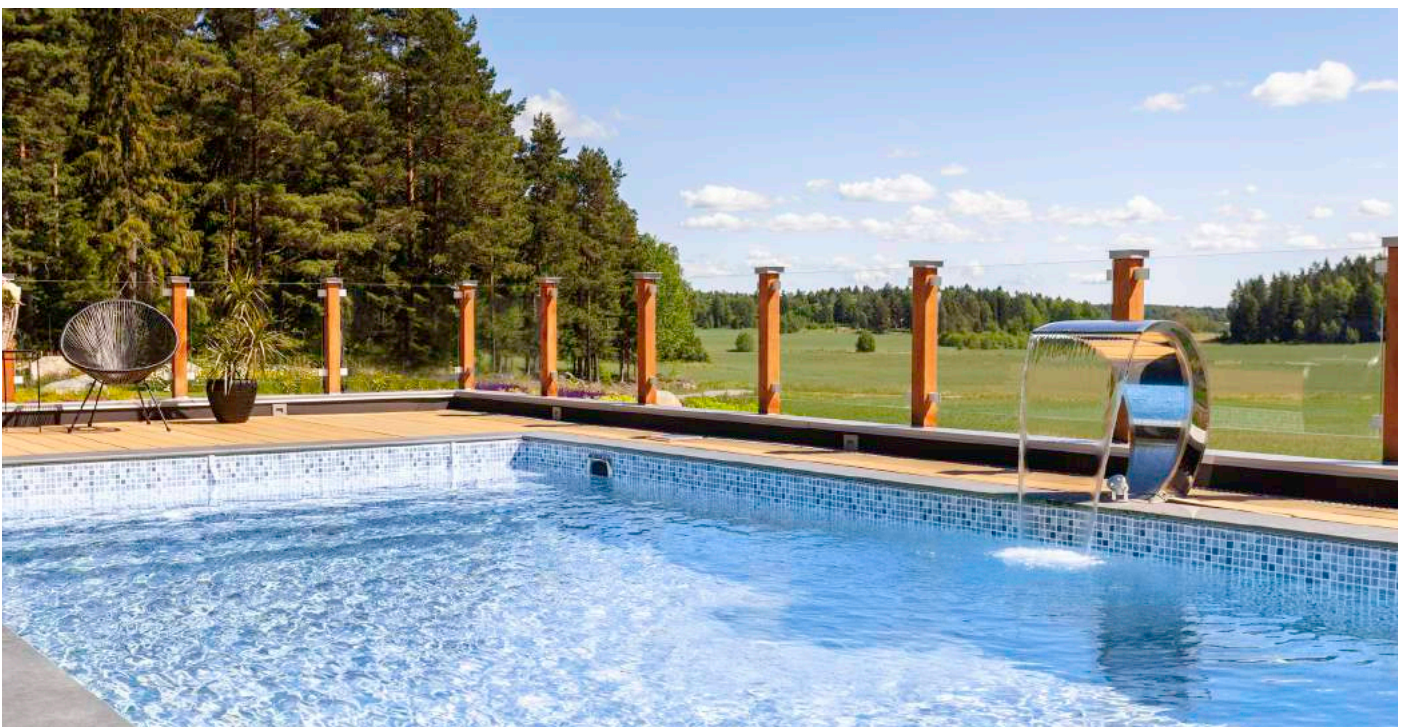

Pool equipment - Stainless steel for optimal quality

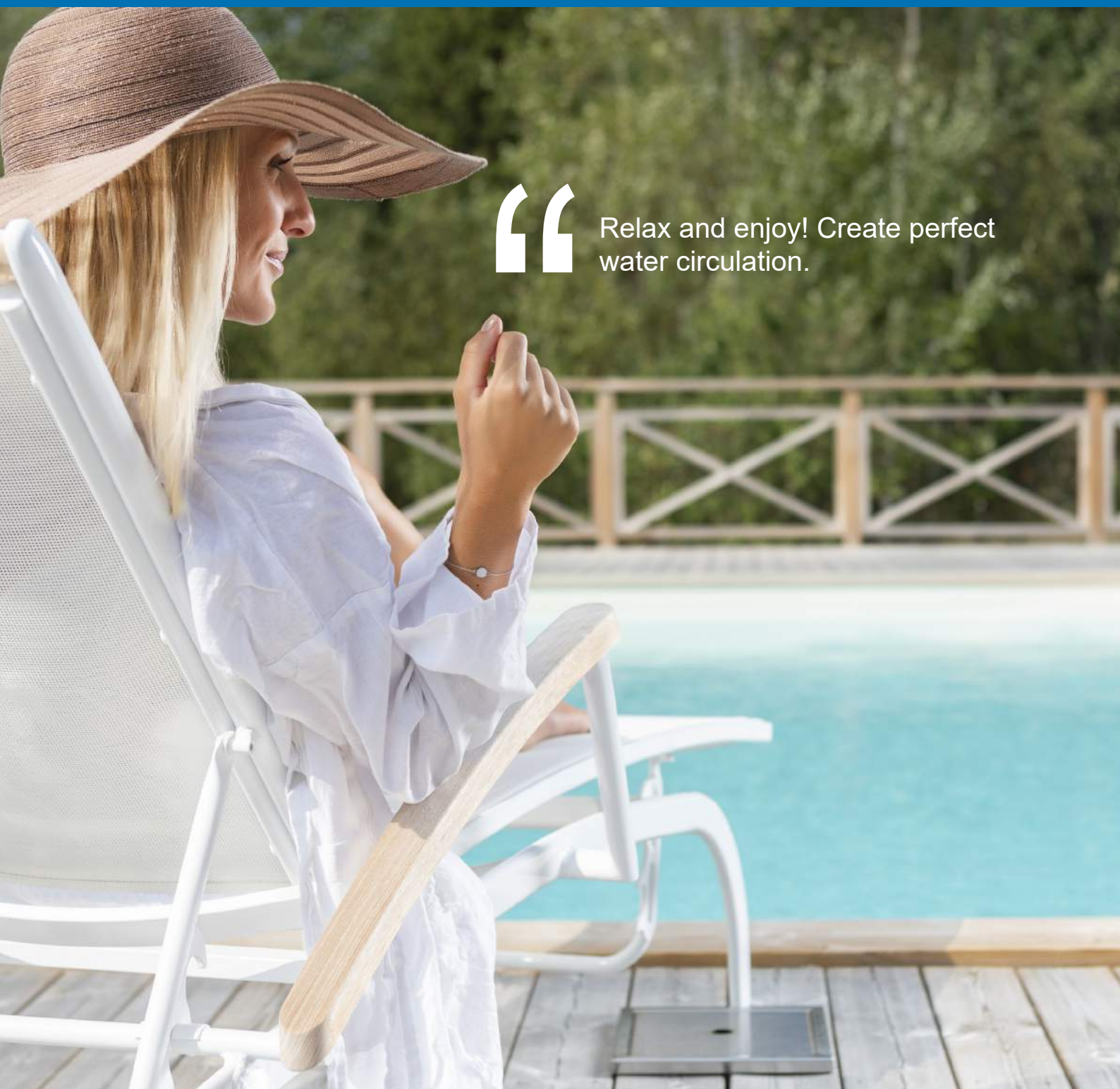

“

Relax and enjoy! Create perfect water circulation.

Create a beautiful pool with Pahlén Marine. An exclusive series of inlets, outlets and skimmers to match your wish for high quality and appearance standard. All Pahlén equipment for swimming pools comes out with polished stainless steel fronts.

Swimming pool equipment



Marine

Made of acid proof stainless steel. Available with short neck, standard neck and extended neck.



Classic

Made of acid proof stainless steel. Available with short neck, standard neck, extended neck and wide.



Wall and bottom outlets

Made of acid proof stainless steel. Prevents stagnant water at the bottom of the pool.



Inlets

Made of acid proof stainless steel. Distributes the waterflow and returns cleaned and heated water to the pool.



Wall inlet - Bottom inlets

Made of acid proof stainless steel. The nozzle is secured by barbs inside the pipe.



Suction nozzles

Made of acid proof stainless steel. Prevents the water from becoming stagnant.

Swimming pool equipment



Skimmer Marine

Water leaves the pool through the skimmer which increases the surface flow rate and moves surface debris into the skimmer. The debris are collected in a filter basket and the water flows on to the sand filter for particle cleaning.

Flow capacity max 12 m³/h.

Features

- Adjustable collar
- Acid proof stainless steel
- Large, high-capacity filter basket
- Connection for water level control
- Flap weir made of stainless steel
- Suitable for all liner pools
- Skimmers available with short neck, standard neck and extended neck

Short		Standard		Extended		Skimmer liner pool
Item no.	Type	Item no.	Type	Item no.	Type	
124971	CA-K	124981	CA-S	124991	CA-L	Complete with screws and gasket.
124978	CA-KNR	124988	CA-SNR	124998	CA-LNR	Same as above but with openings for water filling, overflow and cable bushing for water level control.
124700		124700		124700		Replacement kit for upgrading Classic skimmer to Marine (liner).

Fixture kit

Item no.

112900 Fixture kit, set of 4. Recommended for concrete pool with liner.

Accessories for fiberglass/PP pool

Item no.

15530104 Screw kit, bracket Marine skimmer, fiberglass/PP pool.

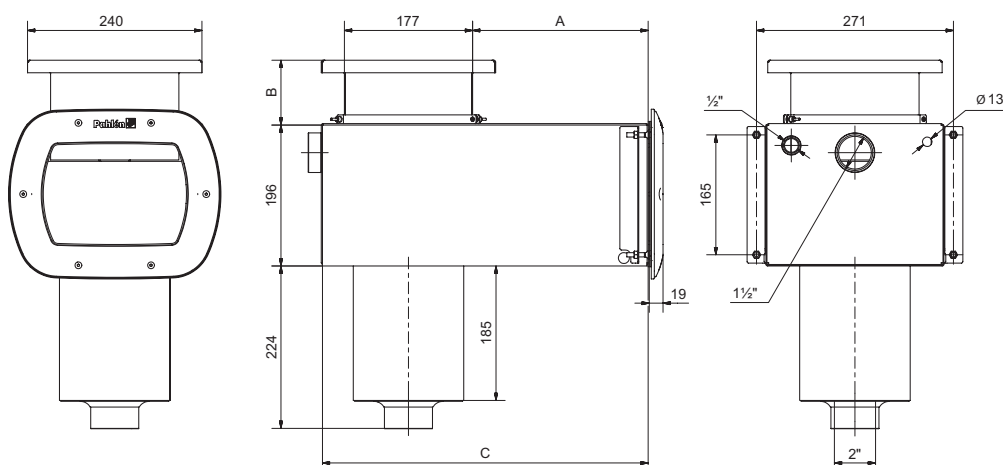

Dimensions

Item no.	A	B	C
124971	60	30-120	270
124978	60	30-120	270
124981	240	30-120	450
124988	240	30-120	450
124991	440	30-120	650
124998	440	30-120	650

Type A



Type B



Skimmer grille

Skimmer grilles prevent large objects from entering the skimmer and for additional safety precautions. Applicable for liner pools and compatible with both new and existing Marine design skimmers.

Item no. Type

124705	A	Skimmer front mesh
124706	B	Skimmer front grille

Swimming pool equipment



Skimmer Classic

Water leaves the pool through the skimmer which increases the surface flow rate and moves surface debris into the skimmer. The debris are collected in a filter basket and the water flows on to the sand filter for particle cleaning.

Flow capacity max 12 m³/h.

Features

- Polished front
- Acid proof stainless steel
- Vertically adjustable collar
- Flap weir made of stainless steel
- Polished, pattern-rolled cover
- Equipped with large, high-capacity filter basket
- Connection for water level control

Short		Standard		Extended		Skimmer liner pool
Item no.	Type	Item no.	Type	Item no.	Type	
112971	CA-K	112981	CA-S	112991	CA-L	Complete with screws and gasket.
112978	CA-KNR	112988	CA-SNR	112998	CA-LNR	Same as above but with openings for water filling, overflow and cable bushing for water level control.

Fixture kit

Item no.

112900 Fixture kit, set of 4. Recommended for concrete pool with liner.

Accessories for fiberglass/PP pool

Item no.

11266 Frame skimmer fiberglass/PP pool

Dimensions

Item no.	A	B	C
112971	60	30-120	270
112978	60	30-120	270
112981	240	30-120	450
112988	240	30-120	450
112991	440	30-120	650
112998	440	30-120	650

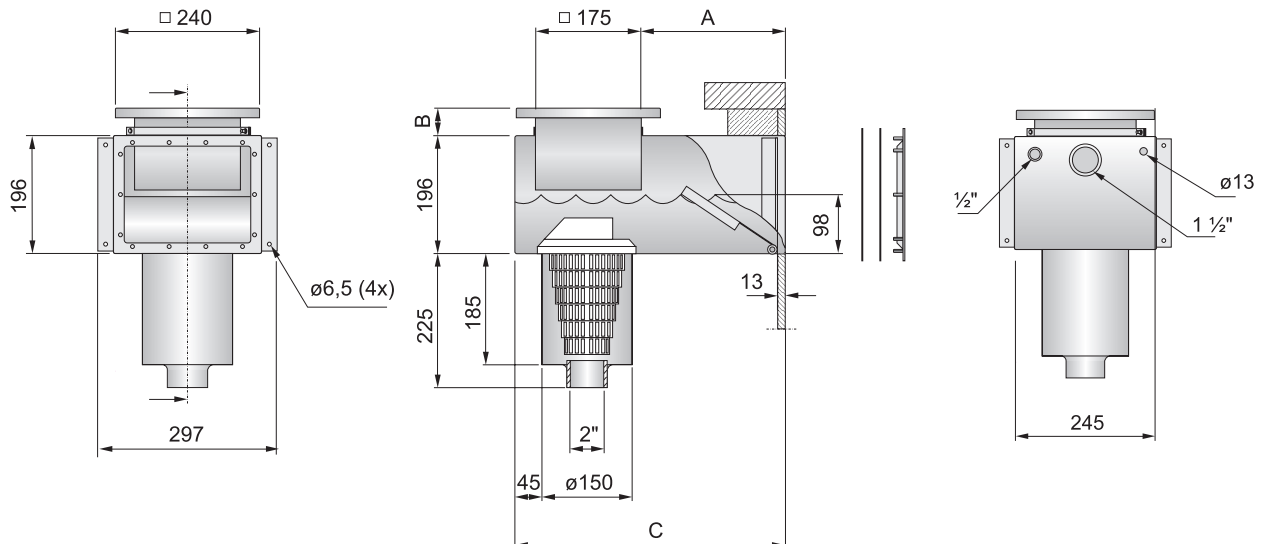

Swimming pool equipment



Concrete

Skimmer

Water leaves the pool via a skimmer, which makes the flow rate at the surface increase and moves particles on the water surface into the skimmer. For embedment in concrete pools with tile or mosaic.

These particles are collected in a filter basket. Made of acid proof stainless steel.

Flow capacity max 12 m³/h.

Features

- Acid proof stainless steel
- Vertically adjustable collar
- Flap weir made of stainless steel
- Polished, pattern-rolled cover
- Equipped with large, high-capacity filter basket
- Connection for water level control

Short		Standard		Extended	
Item no.	Type	Item no.	Type	Item no.	Type
112972	A-K	112982	A-S	112992	A-L
112979	A-KNR	112989	A-SNR	112999	A-LNR

Flange for embedment in concrete wall.

Same as above but with openings for water filling, overflow and cable bushing for water level control.

Dimensions

Item no.	A	B	C
112972	60	30-120	270
112979	60	30-120	270
112982	240	30-120	450
112989	240	30-120	450
112992	440	30-120	650
112999	440	30-120	650

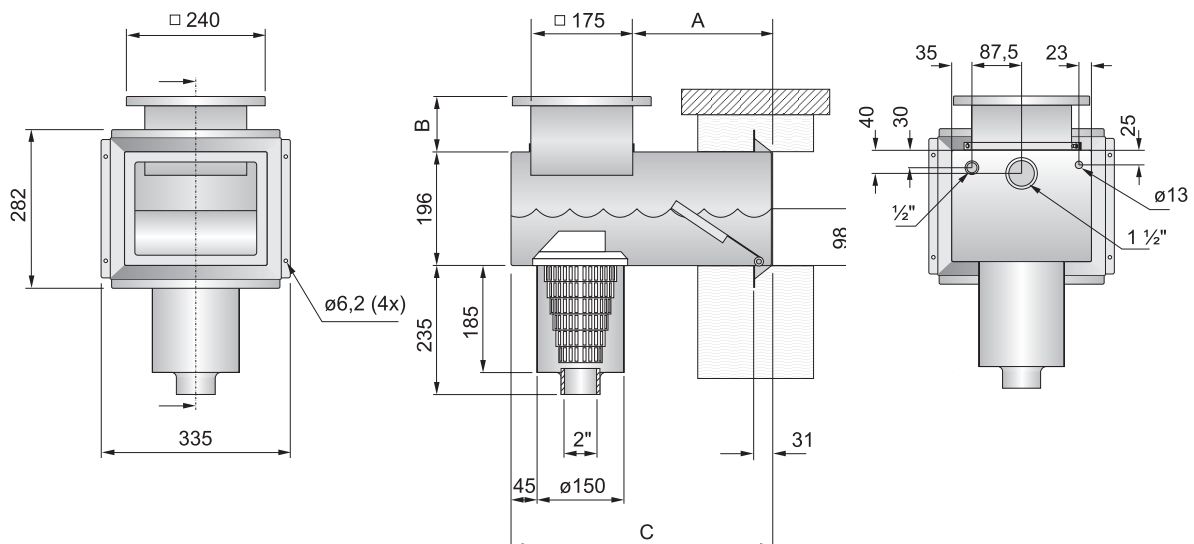

Swimming pool equipment



Classic Wide/Wide6° 385

Open wide skimmer in a exclusive design. Classic Wide 385 gives high water level with efficient extraction of debris and circulation for liner swimming pools.

Classic Wide 6° 385 is especially developed for fiber glass-PP pools with 6 degree angle walls.

Flow capacity max 12 m³/h.

Features

- Acid proof stainless steel
- Vertically adjustable collar 30-70 mm
- Polished front
- Opening: 385 x 92 mm
- Flap weir made of stainless steel
- Filtration outlet internal thread 2"
- Overflow outlet internal thread 1 1/2"
- Water refill inlet internal thread 1/2"
- Connection for water level control Ø 13 mm
- Large, high-capacity strainer basket
- Suitable for fiberglass/PP pool with 6 degree angle walls

Item no. Type

112970	CA-SW	Skimmer Classic Wide 385
112960	CA-SW6	Skimmer Classic Wide 6° 385

Accessories

Item no.

822620	Concrete-kit skimmer WIDE waterproofing with membrane
112504	Bracket for level control skimmer/wide

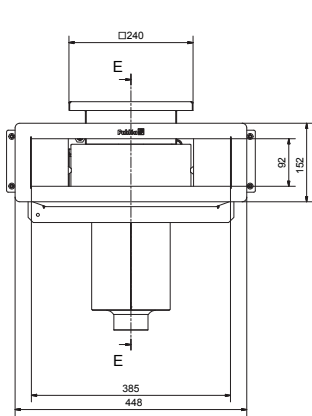

Item no.112970

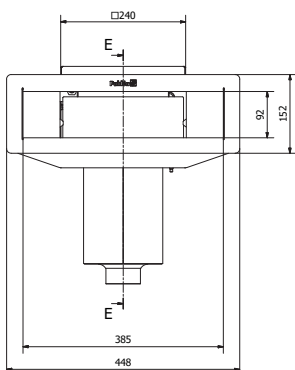
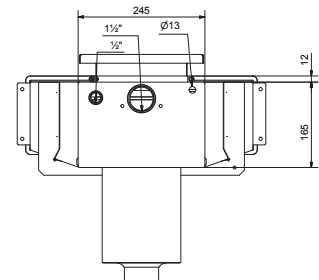
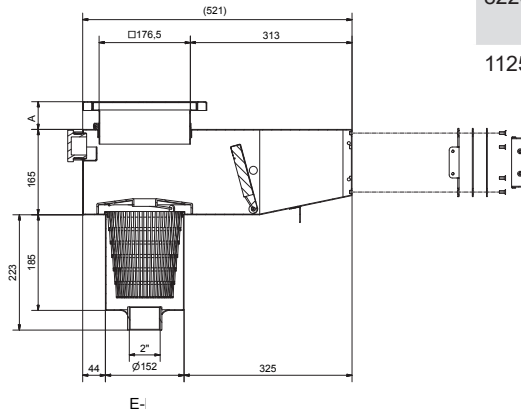

Item no.112960

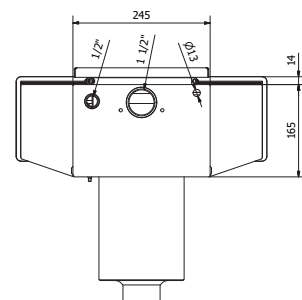
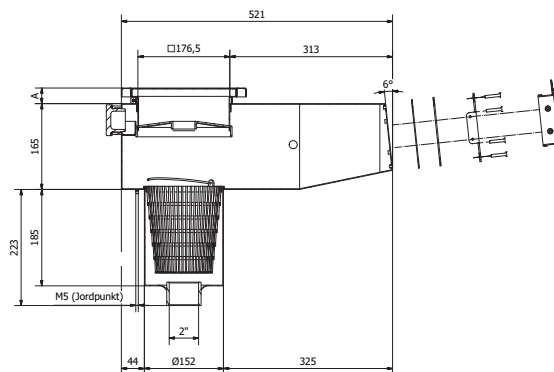

Dimensions

A 30-70 mm

Swimming pool equipment



Water level control

Tops up the water level automatically when it gets too low in the pool. Can be installed in all types of pools, spas, ponds etc.

Programmable refilling time and equipped with warning light.

Item no.

11250	Electronic level control incl. sensor. Built-in safety device with programmable refilling time for solenoid valve.
112501	Solenoid valve ½", soft closing.
112503	Cover made of stainless steel for level control.
112505	Non leak flange for cable of level control.
112504	Bracket for level control skimmer/wide



Solenoid valve



Cover



Non leak flange

Features

- Automatic water filling
- Adjustable water filling time
- Equipped with red warning light
- Suitable for all types of pool

Alerts if the water level is too low and refills when needed.

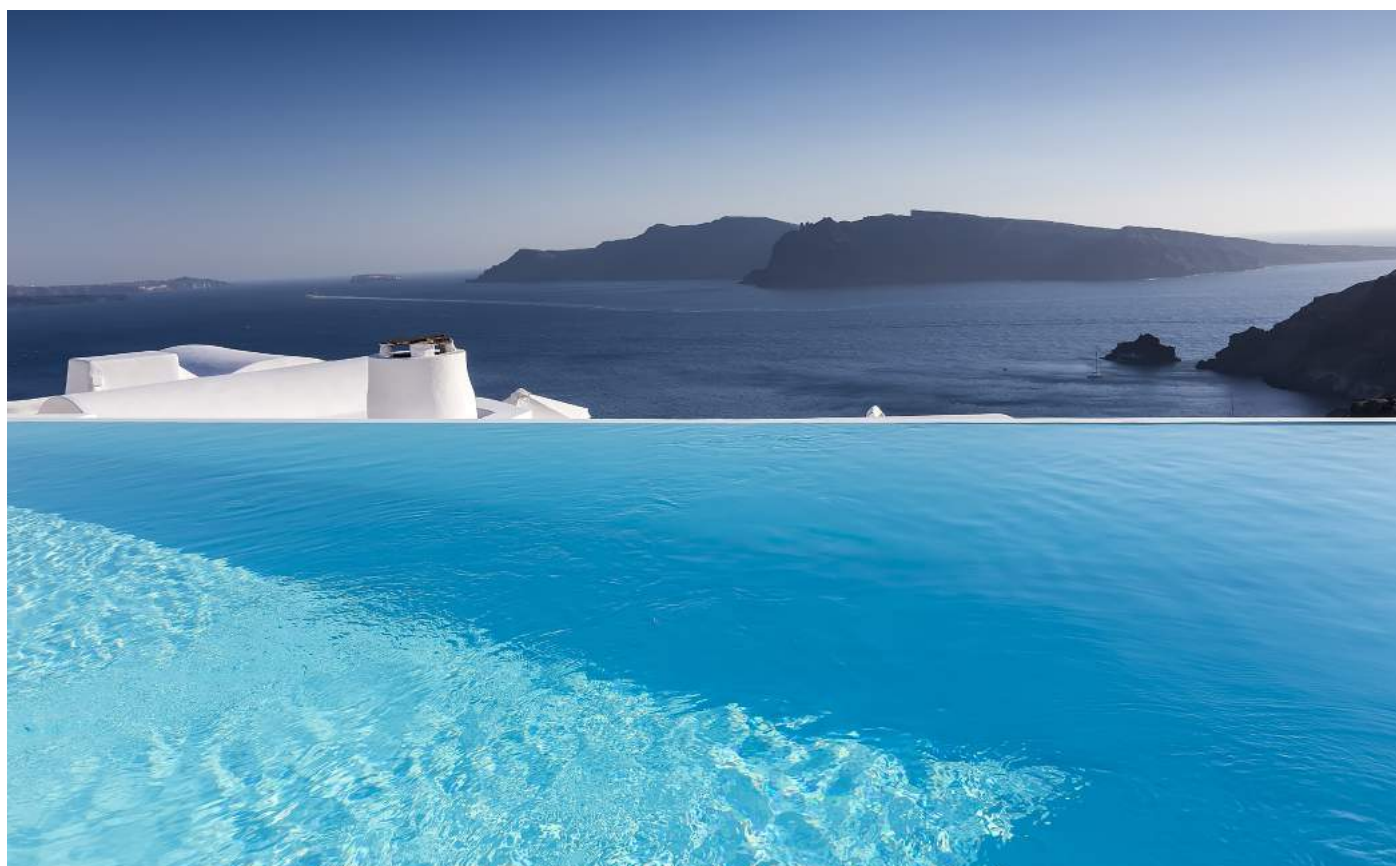

Swimming pool equipment



Wall and bottom outlet

Made of acid proof stainless steel. For deeper swimming pools it is a good idea to install a bottom outlet to prevent stagnant water at the bottom of the pool. Can also be used as outlet for water curtain or massage nozzle. Can be mounted in the wall or in the bottom of the pool.

Recommended flow capacity max 20 m³/h.

Features

- Polished front grating
- Acid proof stainless steel
- Suitable for all types of pools

Item no.	Type (side)	Item no.	Type (bottom)	
125933	CA-WBS	125931	CA-WBB	For liner pools. Complete with flange, rubber gasket and screws. The polished grate is detachable with two screws.
125938	A-WBS	125936	A-WBB	For concrete pools. With flanges for embedding in the concrete floor. The polished grate is detachable with two screws.
126751	NLF-20	Non leak flange. Acid proof stainless steel, with sealing flange. Inside and outside thread 2". Length 600 mm.		
121952		Non leak flange. Acid proof stainless steel, with sealing flange. Outside thread 2". Length 250 mm.		

Accessories for fiberglass/PP pool

Item no.

15530132 Fixing kit for wall and bottom outlet fiberglass/PP pool.

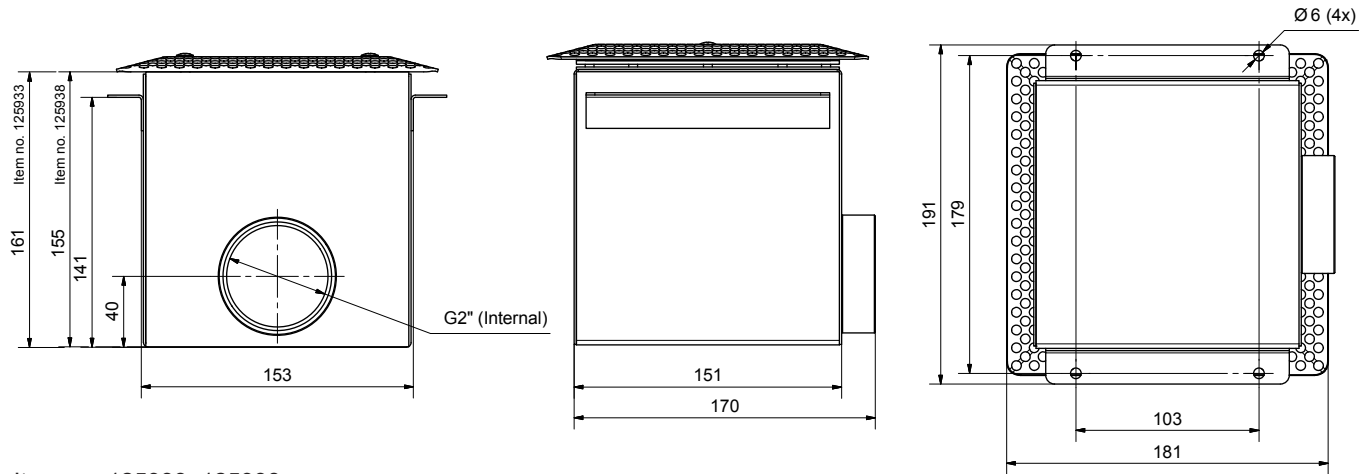

Item no. 125933, 125938

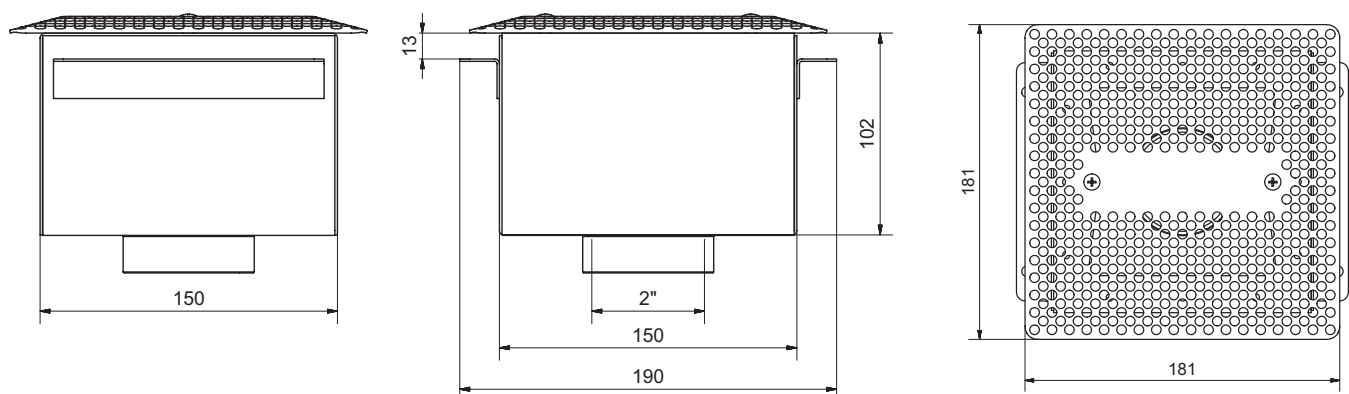

Item no. 125931, 125936

Swimming pool equipment



Inlet Marine

A round, compact and elegant inlet with a polished front. Depending on the size of the pool, you will need two or more inlets that effectively distributes the waterflow and returns cleaned and heated water to the pool. Made of bronze and acid proof stainless steel.

Recommended flow capacity max 6 m³/h.

Item no. Type

124500	CA	For liner pools. With screws and rubber gasket.
124505	A	For concrete pools. Acid proof stainless steel.
124720	Replacement kit for upgrading Classic inlet to Marine (liner)	

Features

- Acid proof stainless steel and bronze
- Adjustable nozzle Ø 26 mm
- Suitable for all types of swimming pools

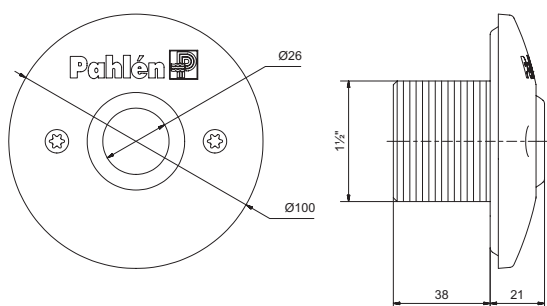

Item no. 124505

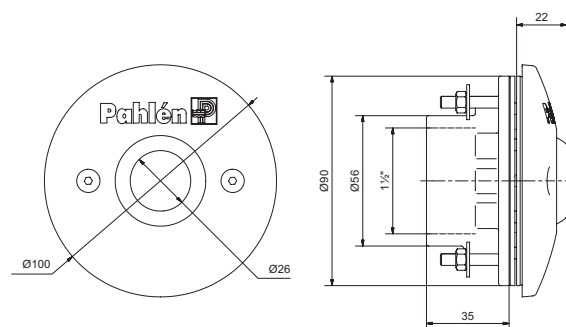

Item no. 124500

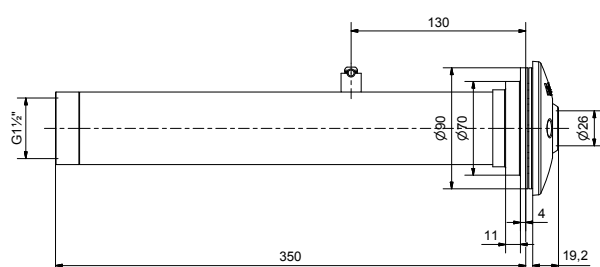

Inlet Marine 350

Complete inlet with casting tube, including screws, flange and rubber gasket.

Recommended flow capacity max 6 m³/h.

Item no. Type

124815	CA	Marine, concrete/liner
--------	----	------------------------

Features

- All stainless steel
- Internal thread 1 1/2"
- Adjustable jet nozzles Ø 26 mm.
- For concrete/insulating blocks, length 350 mm

Accessories

Art.nr. Typ

822600	Concrete kit, waterproofing with membrane
--------	---

Swimming pool equipment

Inlet Classic

The water returns to the pool cleaned and heated via the inlets. These can be directed slightly upwards to facilitate cleaning of the surface water. Made of bronze with front of acid proof stainless steel.

Recommended flow capacity max 6 m³/h.

Item no. Type

125990	CA	For liner pools. With screws and rubber gasket.
126090	A	For concrete pools. Acid proof stainless steel.

Features

- Acid proof stainless steel, polished front
- Adjustable nozzle Ø 26 mm
- Suitable for all types of pools

Accessories fiberglass/PP pool

Item no.

15530110	Fixing kit for inlet fiberglass/PP pool
----------	---

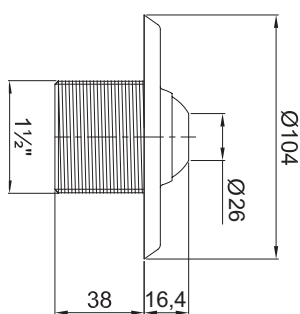

Item no. 126090

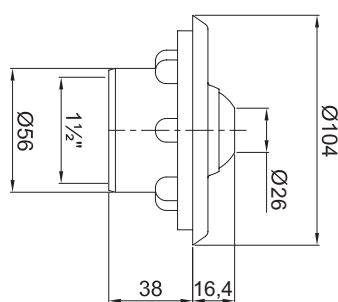

Item no. 125990

Inlet Classic 350

Complete inlet with casting tube, including screws, flange and rubber gasket.

Recommended flow capacity max 6 m³/h.

Item no. Type

125815	CA	Classic, concrete/liner
--------	----	-------------------------

Features

- All stainless steel
- Internal thread 1 1/2"
- Adjustable jet nozzles Ø 26 mm.
- For concrete/insulating blocks, length 350 mm

Accessories

Art.nr. Typ

822600	Concrete kit, waterproofing with membrane
--------	---

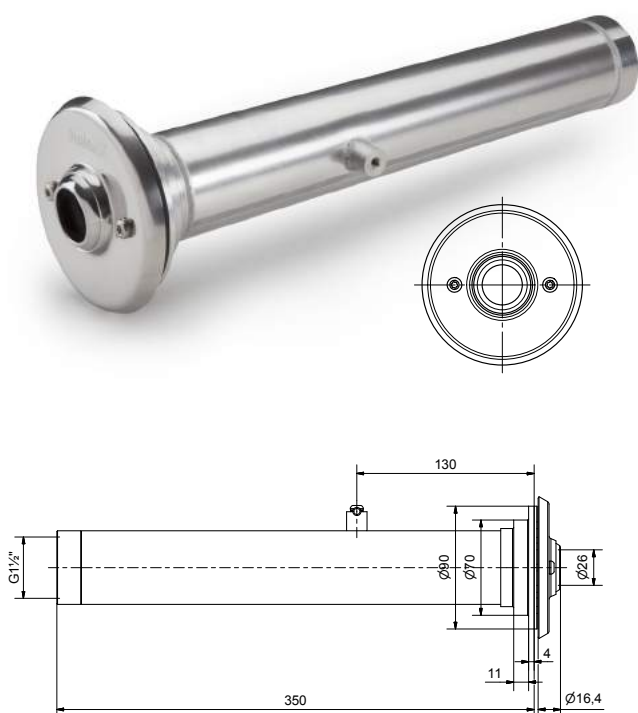

Swimming pool equipment



Inlet anchoring bracket Marine

Wall inlets are designed for mounting onto the end of a molded PVC pipe, PN10/16 with an outer diameter Ø 50 or Ø 63. The nozzle is secured by barbs inside the pipe. The pools flow can be directed by turning the ball in the desired direction.

Recommended flow capacity max 10 m³/h.

Features

- Anchoring bracket
- Adjustable nozzle mesh Ø 7 mm
- For mounting in a concrete pool with casting pipes
- Acid-proof stainless steel
- PVC pipe PN10/16 with an outer diameter of Ø 50 or Ø 63 mm

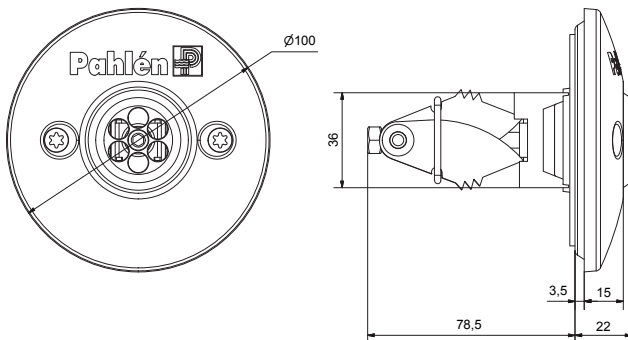

Item no. Type

126102	A	Marine inlet anchoring bracket
--------	---	--------------------------------



Bottom inlet anchoring bracket

A bottom inlet designed for mounting onto the end of a molded PVC pipe, PN10/16 with an outer diameter Ø 50 or Ø 63. The nozzle is secured by barbs inside the pipe. The flow can be regulated in eight different positions on the front of the inlet.

Recommended flow capacity max 15 m³/h.

Features

- Anchoring bracket
- Adjustable flow
- For mounting in a concrete pool with casting pipes
- Acid-proof stainless steel
- PVC pipe PN10/16 with an outer diameter of Ø 50 or Ø 63 mm

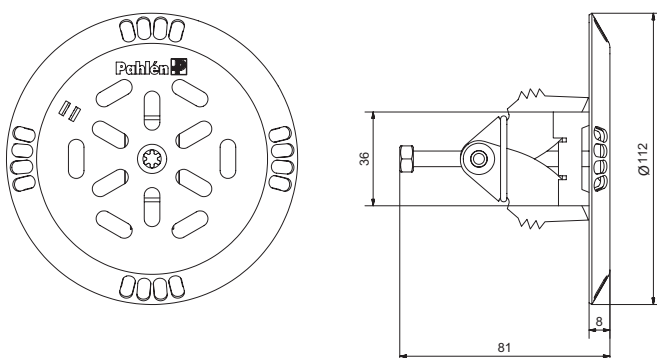

Item no. Type

126110	A	With anchoring bracket
--------	---	------------------------

Swimming pool equipment



Bottom inlet nozzle

Made of acid proof stainless steel with polished adjustable front. Recommended for larger pools and public facilities. Placed in the bottom of the pool to ensure the water keeps circulating. Suitable for concrete pools.

12550 Recommended flow capacity max 6 m³/h.

12560 Recommended flow capacity max 8 m³/h.

Item no.	Type	
12550	A-1	Adjustable for different flows. Outside thread 1 1/2". For concrete pools.
12560	A-2	As above but with outside thread 2".

Features

- Polished front
- Acid proof stainless steel
- Adjustable water flow
- Suitable for concrete pools

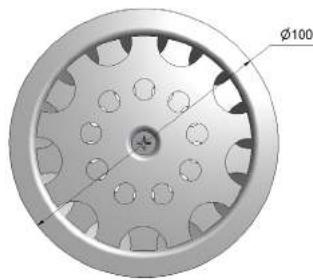
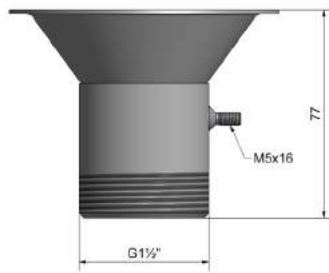

Item no. 12550



Item no. 12560

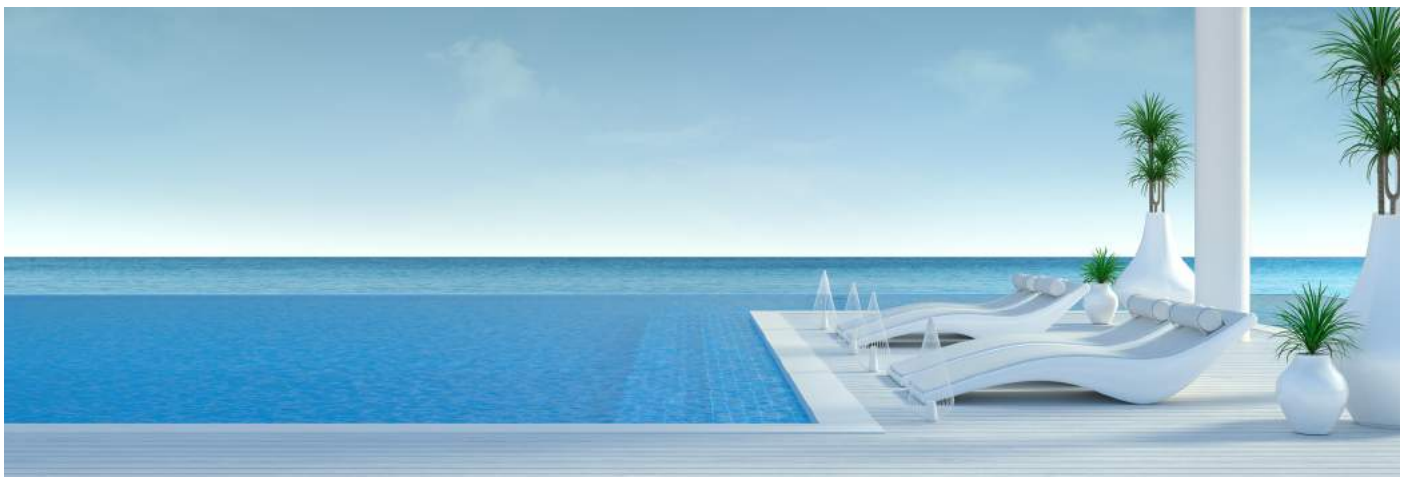

Swimming pool equipment



Item no. 125820

Suction nozzle Classic

A suction nozzle is recommended near the bottom of the pool to prevent the water from becoming stagnant.

Recommended flow capacity max 2 m³/h.

Item no. Type

125820	CA	Bronze, front with acid proof stainless steel, screws and rubber gasket. Grille opening. Inside thread 1½". For liner pools.
12650	A	Acid proof stainless steel. Grille opening. Outside thread 1½". For concrete pools.
125825	CA	Suction nozzle Classic 350. Acid proof stainless steel. Inside thread 1½". For concrete and liner pools.

Accessories

Item no.

15530110	Fixing kit for nozzle fiberglass\PP pool
822600	Concrete kit waterproofing with membrane

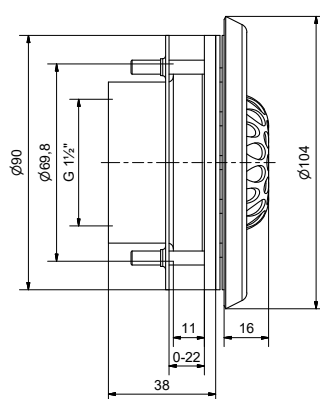
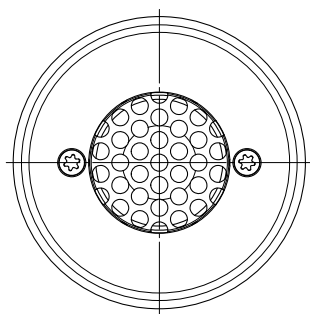

Features

- Polished front
- Acid proof stainless steel
- Suitable for all types of pools



Item no. 125825

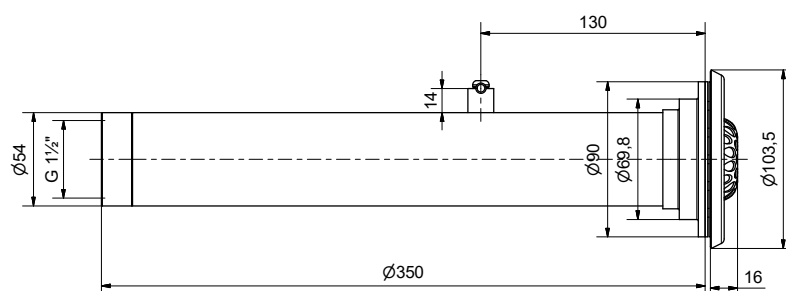
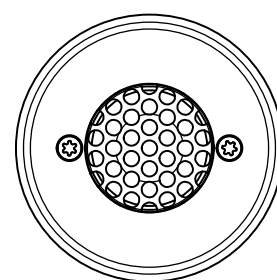

Swimming pool equipment

Vacuum hose connection Classic

Made of bronze, front with acid proof stainless steel. If the pool is equipped with an overflow, a vacuum hose connection is used for the vacuum hose during cleaning of your pool.



Item no. 125830

Item no.	Type	
125830	CAA	Acid proof stainless steel. For concrete and liner pools. Inside thread 1 1/2".
125835	CA	Classic 350. Acid proof stainless steel. For concrete and liner pools. Inside thread 1 1/2".

Features

- Polished front
- Acid proof stainless steel
- Suitable for all types of pools
- Suction nozzle with cover equipped with turning cover

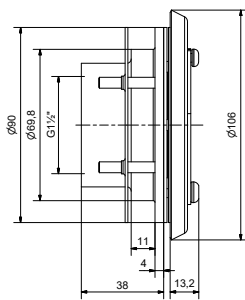
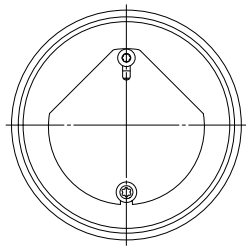

Item no. 125835

Accessories

Item no.

15530110	Fixing kit for nozzle fiberglass\PP pool
822600	Concrete kit waterproofing with membrane

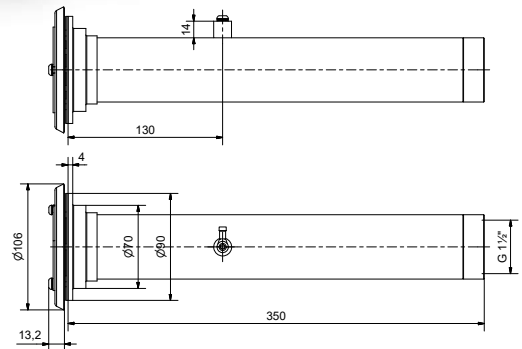
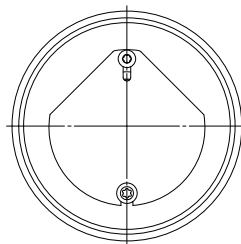

Non leak flange

Non leak flange in acid proof stainless steel. For inlets and suction nozzles in concrete walls.

Accessories for concrete pools

Item no. Type

12670	NLF290	With sealing flange. Inside and outside thread 1 1/2". Length 290 mm.
12675	NLF600	As above but with length 600 mm.
12640	NLF255	With sealing flange. Inside thread 1 1/2". Length 255 mm.
126751	NLF600	With sealing flange. Inside and outside thread 2". Length 600 mm.
126952	NLF250	With sealing flange. Inside and outside thread 2". Length 250 mm.



Measuring and dosing equipment - Water quality that lasts



Correct values and optimal dosing with automatic monitoring



Reduce the needs of expensive chemicals. With a Pahlén Autodos installed in the system, water quality is continuously monitored and a suitable dose of chemicals are supplied, leading to a better consumption, as chlorine and pH levels are maintained at a constant level and unnecessary high values are eliminated. An optimum solution that results in lower costs and favors both bathers and environment. Additional control and disinfection are obtained with a Pahlén CO₂ unit and UV light.

Measuring and dosing equipment



Autodos

Monitoring and dosing system for pH and chlorine in the form of redox, free chlorine and combined chlorine.



MiniMaster

Offers you continuous monitoring and automatic dosing.



Dosing pumps

Dosing pumps for injecting chlorine or pH-regulating agents.

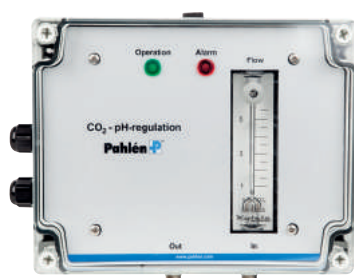

pH-MaxiDos and pH-MiniDos

Safer, dependable and easy to use systems for pH reduction in the pool by carbon dioxide gas.



Auto UV titanium

Reduce your chlorine content by up to 70% with UV light.

Measuring and dosing equipment



MiniMaster for private pools

pH and free chlorine or redox. Dual channel version with electrode kit for pH and free chlorine measuring or with pH and redox (ORP) measuring. MiniMaster is also available in a single channel version with electrode kit for monitoring pH or free chlorine. MiniMaster measuring unit offers you continuous monitoring and automatic dosing (disinfection) to safeguard water quality in the same way as in public pools. With a MiniMaster installed in your pool, you need never again to worry about your water quality – The MiniMaster handles it all automatically.

Suits most types of pools

MiniMaster is available in several versions to suit most pool types. A MiniMaster equipped with all the options is a complete measuring and dosing unit. The water's pH level is measured with the help of pH electrodes and chlorine and redox levels are checked using a free chlorine or redox electrode. Clear and easy-to-see LEDs show the status of your water quality.

Technical data

	pH & chlorine	pH & redox	Chlorine	pH
Power consumption excl. dosing equipment	4W	4W	2W	2W
Power consumption dosing equipment (max)	2X100W	2 x 100W	100W	100W
Rated current	1A			
Rated voltage	220-240 1~N 50/60Hz			
Temperature range	0 to +45°C			
IP class	IP44			

Measures and doses chemicals automatically. Provides optimal water quality with automatic monitoring.

Features

- Digital LED control panel
- Flow meter
- Pre filter
- Tilttable flow cell module
- Transparent flow cell
- Automatic measurement of water quality
- Operates dosing equipment for chlorine and pH

MiniMaster-kit

Item no.	Complete kit with MiniMaster, electrode kit, dosing pump, saddle clamp and collecting vessel
33034	MiniMaster-package chlorine & CO ₂
33033	MiniMaster-package chlorine & acid
33036	MiniMaster-package redox & acid
33037	MiniMaster-package redox & CO ₂

Ordering guide

MiniMaster and electrode kit

Item no.	pH & chlorine	pH & redox	chlorine	pH
416620 MiniMaster	•			
416621 Electrode kit	•			
416600 MiniMaster			•	
416601 Electrode kit			•	
416610 MiniMaster				•
416611 Electrode kit				•
416630 MiniMaster		•		
416631 Electrode kit		•		
Option				
413335 Peristaltic pump	•	•	•	•
414810 pH - MiniDos CO ₂	•	•		•

Chemicals not included.

Measuring and dosing equipment

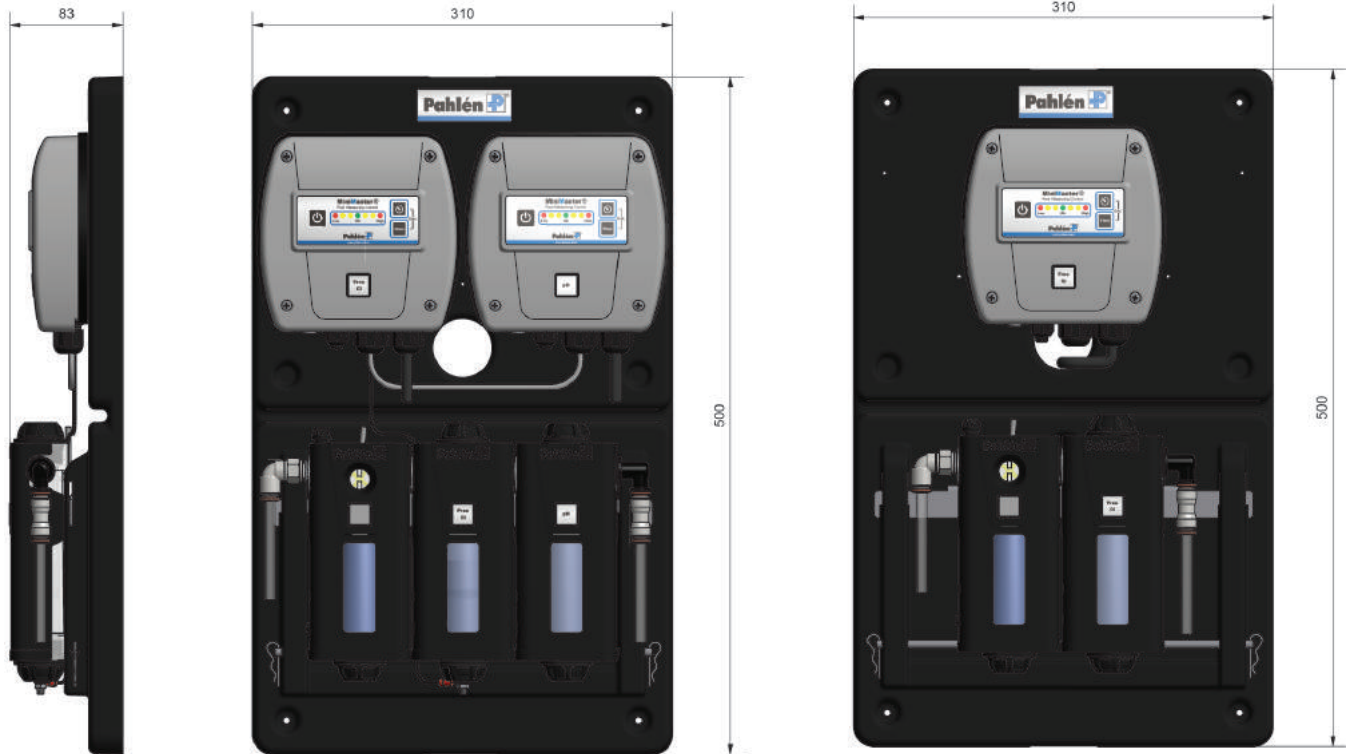

For additional options and disinfection

pH - MiniDos CO₂

Option. Dependable and easy to use system for pH reduction in the pool by CO₂ gas. Read more on page 81.



Auto UV titanium

Option. Disinfects the water using ultraviolet light and can reduce the pool water's chlorine content by up to 70%. Auto UV titanium creates bacteria-free water with minimum chlorine smell. Read more on page 80.

Peristaltic pump

Option. In order for dosing to take place accurately and correctly, a pump is used since this provides steady, uniform dosing of liquid chemicals. The pump is factory-calibrated to function with most pools as soon as the MiniMaster is started up. If necessary, dosing capacity can be adjusted to suit your specific pool.



Item no. 413335

Technical data

Max pressure	1.5 bar
Suction height	1.5 m
Pump output	3.5W
Hose material	Resistant to chlorine and acid
Max. capacity	4 l/h

Measuring and dosing equipment



Picture shows Autodos M2

Autodos

Autodos is a well known, and reliable technology when it comes to measuring and dosing. Autodos is available in a variety of versions and can monitor pH and chlorine in the form of redox, free chlorine and combined chlorine.

Pahlén's own developed Autodos is available for all requirements, from the Autodos M1 which is a single-channel instrument for monitoring of pH, redox, free chlorine or total chlorine, to the most advanced Autodos M3 which is a three-channel instrument for monitoring of pH, free chlorine and combined chlorine or redox.

RAM

Manage and analyze Autodos on internet cloud service. Read more on page 76-77.

Features

- Measures free chlorine, pH, redox, combined and total chlorine
- Automatic chemical dosing
- Dosing output: on/off, frequency pulse or 4-20mA
- Temperature sensor
- Electronic flow meter
- Alarm and built-in safety functions
- User access protection
- pH and flow compensated free chlorine measurement
- Option Modbus RS485 for external monitoring, logging and alarm management
- Gas-proof electronic housing safeguards long life operation

Autodos is easy to use and provides exact readings for accurate monitoring and disinfection of pool water. It is also extremely easy to monitor and control the water quality.

Ordering Guide

A complete Autodos consists of Autodos and electrode kit (sold separately). For additional control, a dosing pump and external cable can be purchased. Additional accessories such as chemical tank, collecting vessels and mixers are also recommended. Electrode kit is supplied complete with buffer agents. Chemicals not included.



Electrode kit

Autodos M1	Autodos M2	Autodos M3
Item no.	Item no.	Item no.
416500 Autodos M1 free chlorine	416540 Autodos M2 pH and free chlorine	416560 Autodos M3 pH, free chlorine and redox
416510 Autodos M1 pH	416550 Autodos M2 pH and redox	416570 Autodos M3 pH, free and combined chlorine
416520 Autodos M1 redox	416541 Electrode kit M2, PB200 free chlorine, pH	416561 Electrode kit M3 PB200 free chlorine, pH and redox
416530 Autodos M1 total chlorine	416542 Electrode kit M2 CLE3 - 10ppm free chlorine, pH	416562 Electrode kit M3 CLE3 - free chlorine 10ppm, pH and redox
416501 Electrode kit M1, PB200 free chlorine	416543 Electrode kit M2 CLE3 - 20ppm free chlorine, pH	416571 Electrode kit M3 PB200 - free and CTE combined chlorine , pH
416502 Electrode kit M1 CLE3 - 10ppm free chlorine	416551 Electrode kit M2 redox, pH	
416511 Electrode kit M1 pH		
416521 Electrode kit M1 redox		
416531 Electrode kit M1 CTE1 total chlorine		

Accessories for Autodos on page 78-79

Measuring and dosing equipment

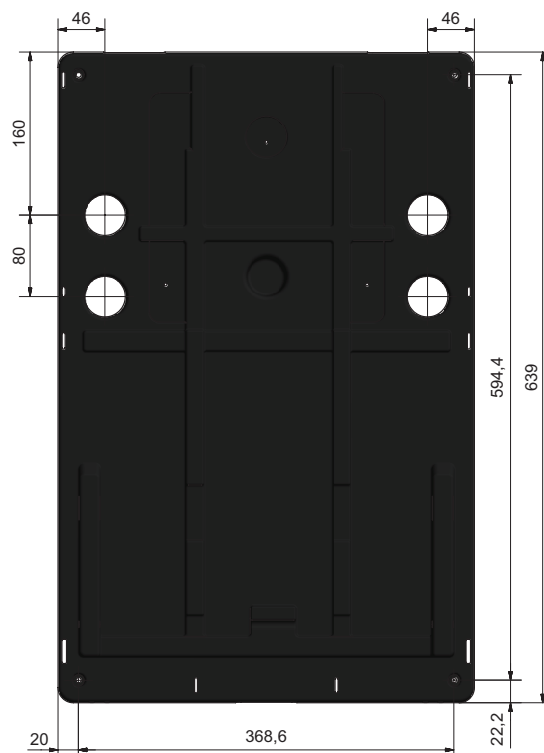
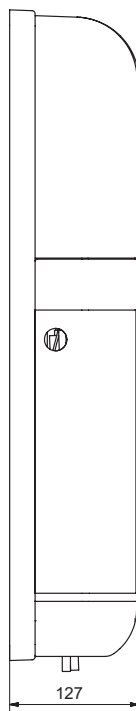

For additional options and disinfection

Increased disinfection - UV light

Auto-UV titanium

Option. Disinfects the water using ultraviolet light and can reduce the pool water's chlorine content by up to 70%. Auto UV titanium creates bacteria-free water with minimum chlorine smell.

Read more on page 80.

Extra monitoring with CO₂

pH-MaxiDos

Option. A dependable and easy to use unit for pH reduction in the pool. Read more on page 81.

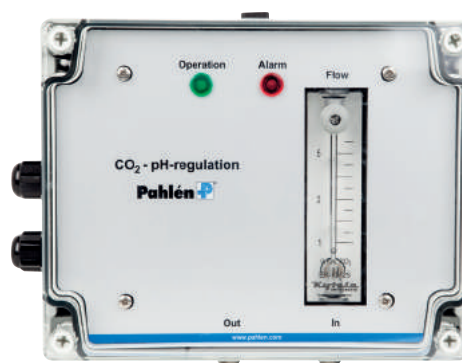

Measuring and dosing equipment



Pahlén Cloud Service

Two choices of gateways for Ethernet connection or Mobile network uplink. Cloud service access by any platform; PC, smartphone, tablet.



Autodos® RAM

Remote Access Monitoring

With Autodos® RAM it is easy to analyze your Autodos-system online. A turnkey solution for a complete IT-infrastructure without building own network management. The cloud service is online and all data is stored on remote secure global servers.

Graphical log data for every value measured by Autodos. Built-in reporting tool for accessing detailed weekly export report. Additional features for historical comparison of values, Google maps function for easy overview, managing and access to several projects and systems.

Features

- 50 000 log points included/system and year
- Regular reports
- History logs with measured data and alarms
- Up to 9 system languages available
- Map function showing system locations
- Two user login for individual project access with customized user rights
- Report module for online data or trend analysis
- Active alarms online or via e-mail/SMS
- No software needed, access via web browsers; e.g. Firefox, Safari or Chrome etc.

Manage and analyze Autodos on internet cloud service.

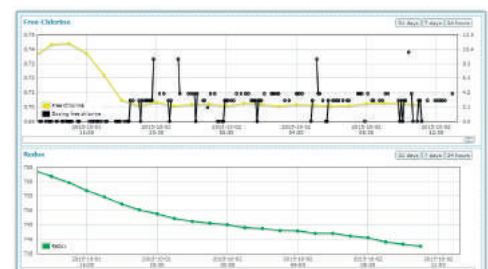
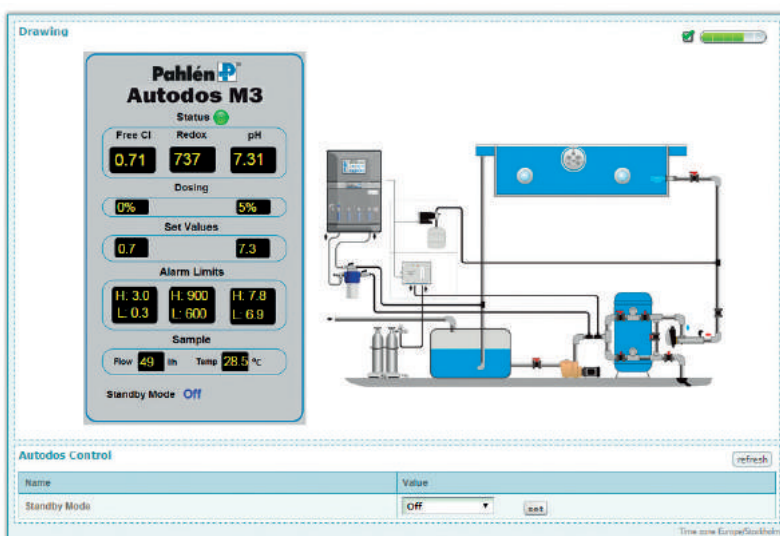

Measuring and dosing equipment

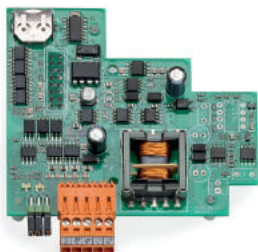

System components

- System compatibility with Autodos M1-M2-M3 *
- Modbus-RTU communication interface
- Gateway modules for Ethernet (WAN) or mobile (GPRS/3G) uplink

* Autodos software from version 5.6

Item no.

416209	- Internal communication module Autodos
--------	---



EC220 - Gateway Mobile

Wireless gateway
Modbus-RTU interface
Metal casing, wall mount
Dimensions 92 x 115 x 25 mm
Operating temperature -30 to +65 °C
Power supply 9-24 V DC

Network access: Custom/standard SIM through GPRS
Quad band Class 12. 850/900/1800/1900 MHz
SIM card not included.

Item no. Type

416230	EC220	- External web-module for GPRS/3G uplink - Including subscription cloud-service 12 month.
--------	-------	--



EC310 - Gateway Ethernet

- Modbus-RTU interface
- Metal casing, wall mount
- Dimensions 92 x 135 x 27 mm
- Operating temperature -40 to +65 °C
- Power supply 12-48 VDC

Network access: Ethernet 10/100 Mbit/s

Item no. Type

416231	EC310	- External web-module for Ethernet uplink - Including subscription cloud-service 12 month
--------	-------	--



Accessories

Dosing pumps with reliable dosing

Dosing pumps for injecting liquide chlorine or pH-regulating agents. The pumps are microprocessor-controlled and magnetically operated for maximum dependability and dosing precision. The pumps offer a wide range of settings. The liquid end is manufactured from plexiglass and the suction and pressure details are of PVDF. These materials are chosen for their known resistance to the majority of chemicals used in water treatment. The pump can be controlled on/off or externally by pulses from a monitoring and controlling device, for example by using an Autodos with an external cable (optional).



Beta/4B

Dosing pump Beta with plexiglass liquid end (NPE) excl. Beta/4B 0400 PPT. All pumps have on/off or frequency control and are supplied with injection and foot valves and 2 m of suction and 5 m of pressure hose.

Technical data

Item no.	Type	Connection mm	Max capacity l/h	Max capacity ml/stroke	At max pressure bar
413330*	Beta/4B 0400	6 x 4	0.8	0.07	4
413331	Beta/4B 0402	12 x 6	2.9	0.27	4
413332	Beta/4B 0408	12 x 6	8.1	0.75	4
413333	Beta/4B 0220	12 x 9	19.0	1.76	2
413334	Beta/5B 0232	12 x 9	32.0	2.96	2

* Beta/4B 0400 is a flocculation pump.

Features

- High precision
- Magnetic dosing pump
- Adjustable capacity
- Multifunctional valve (option)
- Wear resistant operation
- External cable (option)

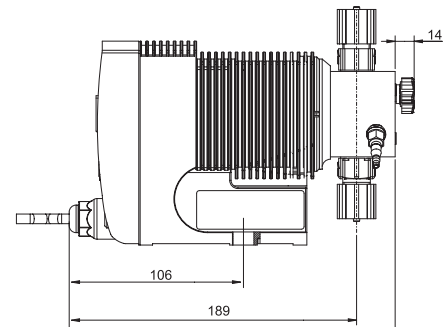
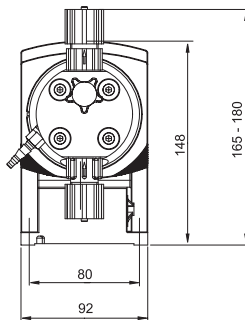

Concept

Dosing pump with liquid end of PVDF. The pump has on/off or frequency control and is supplied with injection and foot valves and 2 m of suction of pressure hose and a 5 m external cable.

Technical data

Item no.	Type	Connection mm	Max capacity l/h	Max capacity ml/stroke	At max pressure bar
413340	Concept plus 1002	6 x 4	2.6	0.24	5

Operating voltage: 230V, 50/60Hz.

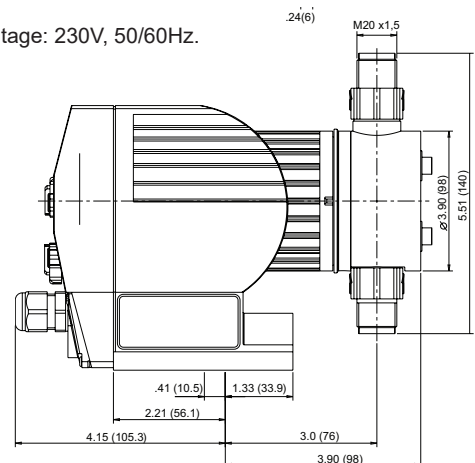
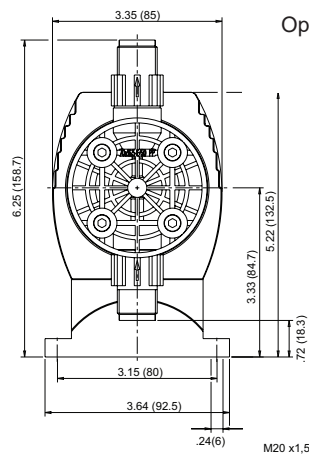

Features

- High precision
- Chemical resistant material
- Reliable
- Easy installation
- Small and compact
- Simple adjustment
- External cable included

Accessories



Chemical cabinet

Intended for storage of liquid chlorine or acid. The cabinet is made of PP plastic with a well welded bottom, which acts as a fitting for possible leakage.

Possibility for connection of ventilation Ø125 mm. As an additional security to prevent any unauthorized access e.g. a padlock can be connected. The cabinet is intended for storage of 1st 25l standard container or 1st 35l chemical vessel (item. no. 41501).

Item no.

413300 Ø 125 outside 400 x 400 x 1050 mm (W x D x H)

Features

- Collecting vessel
- Possibility of ventilation
- Lockable



External cable for frequency controlled pump

Item no.

41366 External cable Beta, 2-wire 5 m



Float switch

Item no.

41372 Float switch BETA 2 m cable

41373 Float switch BETA 5 m cable



Wall mounting bracket

Item no.

41378 Wall mounting bracket BETA/Concept



Complete flocculation station

Item no.

41330 Flocculation station incl. 60 l tank and pump.BETA/4B 0400 and dosing valve, foot valve, suction and pressure hose.



Chemical tank

Store your "liquid" chlorine or acid in a safe tank.

Item no.

41501 Chemical tank 35 l

41502 Chemical tank 60 l

41503 Chemical tank 100 l

41500 Chemical tank 140 l



Mixers for different sizes of tanks.

Item no.

41516 Mixer manual 35/60 l

41515 Mixer manual 100 l

41517 Mixer manual 140 l

41518 Mixer manual 250/500 l



Collecting vessel

Ensures that no liquids get mixed in case of leakage from chemical tank.

Item no.

41512 Collecting vessel for 35 l

41507 Collecting vessel for 60 l

41513 Collecting vessel for 100/140 l



Multi function valve

Item no.

413745 1,5-6 bar Beta/B 0400 - 0220, Concept

413755 1,5-6 bar Beta/B 0232

UV-disinfection

Auto-UV titanium

The Pahlén Auto-UV titanium is designed for disinfection of water in pools and spas. With the Auto-UV titanium you can reduce your chlorine content by up to 70%. The result is also a swimming pool with less combined chlorine, which makes a more pleasant bathing environment without irritations like red eyes, the smell of chlorine or the risk of allergies. Optimal neutralisation of bacteria, viruses and algae.

The UV lamp produces short-wave ultraviolet UVC radiation with a 254 nm wavelength. This wavelength is optimal for neutralising bacteria, viruses and algae. As a result your pool water is crystal-clear and pleasant. When the Auto-UV is in operation this is shown by a blue indicator at the top of the unit.

Safe and efficient disinfection of your pool water



Electronic panel with LEDs

- Operation indicator shows the number of hours the unit has been in operation
- Timer flashes when 1000 hours of operating time remain
- Display indicates when the UV lamp has come to the end of its lifetime.

With the Auto-UV titanium you can reduce your chlorine content by up to 70%.

Features

- UV lamp encased in casing made of titanium
- Electronic box contains adjustment control, timer and on/off switch
- Digital counter
- Built-in indicator for alerting when lamp needs to be replaced
- UV lamp for optimal neutralisation of bacteria, viruses and algae
- Reduces the concentration of combined chlorine in the pool
- Light indicator shows operation status in a blue light
- Delivered complete in one single unit
- Easy to install



Technical data

Item no.	Lamp	Lifetime lamp	Voltage 1~	Current	UVC-radiation wavelength	UVC-radiation	Max pressure	Max flow	Connection	Max water temperature
417760	75W	9000 h	220-240	0.5 Amp	254 nm	25W	4 bar	250 l/min	2"	45°C
417770	130W	9000 h	220-240	0.8 Amp	254 nm	43W	4 bar	250 l/min	2"	45°C

CO₂ - pH regulation



Item no.

414810 Complete with control unit, valve 5 bar for one bottle, injector and check valve with connection 1/2", 5 m gas hose 6 x 8 mm. **Gas bottle not included.**

pH - MiniDos

Pahlén pH-MiniDos is stable and easy to use for stabilizing the pH value with CO₂ (carbon dioxide). For use in private pools.

pH-MiniDos is a control unit that is easily operated via MiniMaster. The MiniMaster measures the water's pH and sends signals to the pH-MiniDos, which with high precision, doses the exact amount of CO₂ needed for the pool.

Features

- High safety
- User-friendly
- Reduces the water's corrosiveness and stabilizes pH value
- Operated via MiniMaster
- Operational indication light for dosage
- Safety bracket for gas bottle

A stable and correct pH-level is important to both the environment and safety aspect for the bathers.

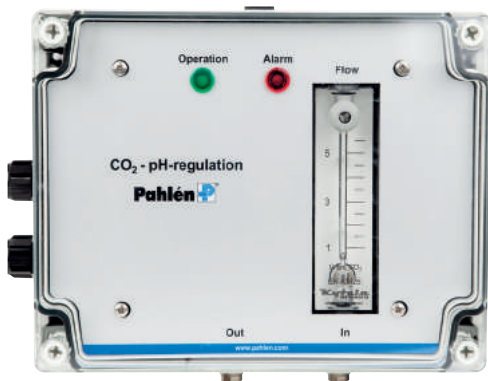

Item no.

414800 Complete with control unit CO₂ valve 6 bar for one bottle, injector and check valve with connection 1/2", 10 m gas hose 6 x 8 mm. **Gas bottle not included.**

pH-MaxiDos

pH-MaxiDos is a dependable and easy to use for pH stabilization in the pool. The unit is controlled via Autodos and suits all pool types. The gas flow is easy to adjust and is read off the flow meter. Connection with an external alarm function possible. For use in public facilities.

Features

- High safety
- User-friendly
- Reduces the water's corrosiveness and stabilizes pH value
- Operated via Autodos
- External alarm function
- Operational indication light for dosage
- Safety bracket for gas bottle



CO₂-Alarm

CO₂-alarm

Item no.

414820 CO₂-alarm for increased safety

If the gas bottle is installed in a closed space, a CO₂-alarm should be installed for increased safety in case of leakage. The alarm measures the CO₂ level in the installed space. The alarm is fitted with a clear LED-display that changes color depending on the status.

Green = Normal, Yellow = Increased, Red = High



Flash siren

Flash siren

Two different modes available:
- Flash light and buzzer
- Flash light only

Water quality - Keep an eye on the values!



Fast, easy and efficient!



Simple instruments for your swimming pool monitoring and maintenance. A cloudy pool can mean that the pH value and chlorine levels are wrong. Many bathers, sun oils and other contaminants in the water make the pool water out of balance, so that bacteria and algae begin to flourish. Taking care of ones pool should be a natural part of bathing and should be as simple and fast as possible.

Test instruments and pool care



Digital, advanced monitoring equipment for larger pools and public facilities.

Advanced monitoring equipment

Autocheck 3i is a digital photometric monitoring equipment for free and total chlorine, pH, cyanuric acid, calcium hardness and total alkalinity. Digital readouts. Date and time in real time.

Autocheck 3i has built in date and time for storing measurements. Up to 16 measurements can be stored before the first is overwritten.

Measure range: Chlorine (free and total) 0.05–6.0 mg/l
pH 6.5–8.4
Cyanuric acid 0–160 mg/l
Calcium hardness 50–500 mg/l
Total alkalinity 5–200 mg/l

Features

- Factory-calibrated
- Easy to use
- Illuminated display
- Automatic switch-off
- Tablet reagent for water parameter included

Item no.

212994 Equipment for free and total chlorine, pH, cyanuric acid, calcium hardness and total alkalinity.



Item no.

212993 For high accuracy measuring of the pools chlorine content (free and total), pH, cyanuric acid, and total alkalinity.

Autocheck 15

Autocheck 15 is a very simple but effective digital measuring instrument.

Autocheck 15 helps you test your values quickly and accurately. The integrated test chamber is filled by immersing it in water. A test tablet is added and the values measured photometrically. The result is displayed on the digital screen.

Autocheck 15 measures with accuracy the water's chlorine content (free and total), alkalinity, pH and cyanuric acid photometrically.

Measure range: Chlorine 0.1–6.0 mg/l
pH 6.5–8.4
Cyanuric acid 1–160 mg/l
Total alkalinity 0–300 mg/l
Brom 0,2 - 13,5 mg/l

Features

- Waterproof
- Digital display
- Easy to use
- Comes with battery and test tablets

As with professional equipment, Autocheck 15 reads the water quality photometrically and displays the results digitally.

Test instruments and pool care



Item no. 212996

Salt meter SD 90

SD90 is a small and compact measuring unit for measuring salinity. Up to 25 different separate readings with date, time and temperature can be stored. An illuminated LCD display shows the results and temperature simultaneously, while other information with date and time are displayed with a simple press of a button.

Measure range: 0-2000 ppm
2-20 ppt
0-2 ‰



Accessories

Item no.

212981	Measuring glass Ø 24 mm to Autocheck I, II and III
212982	Measuring glass Ø 16 mm to Autocheck II
212901	Measuring glass cuvette square
212985	Tablet crusher/stirring rod



Accessories

Item no.		Autocheck I	Autocheck II	Autocheck III/3i	Autocheck 10	Autocheck 15
212916	Free chlorine DPD No.1, 100 tablets	x	x	x		x
212915	Free chlorine DPD No.1, 500 tablets	x	x	x		x
212926	pH phenol red, 100 tablets	x	x	x		x
212925	pH phenol red, 500 tablets	x	x	x		x
212936	Total chlorine DPD No.3, 100 tablets	x	x	x		x
212935	Total chlorine DPD No.3, 500 tablets	x	x	x		x
212956	Cyanuric acid, 100 tablets	x	x	x		x
212966	Alkalinity, 100 tablets		x	x		x
212976	Calcium hardness, 100 tablets**		x	x		
212971	Calcium hardness 1-2, 10 tablets*			x		
212870	pH phenol red, 50 tablets				x	
212910	DPD1 free chlorine, 50 tablets				x	
212930	DPD3 total chlorine, 50 tablets				x	
212950	Cyanuric acid, 50 tablets				x	

*Only for use in Autocheck 3i

**Only for use in Autocheck 3



Vacuum cleaner trolley

In large pools and public facilities, it is more practical to use a vacuum cleaner trolley. Stainless steel container with a filter cartridge, filter area 9.7 m², which gives the filter a long operating time.

Pump 0.55 kW made of bronze, with high capacity (12 m³/h). Air evacuation from the suction hose is handled automatically by the pump. Supplied with 25 meters of cable and motor cut out for a singlephase electrical connection.

Features

- Pump made of bronze
- Stainless steel container
- Equipped with replaceable filter cartridge
- Convenient operation as all equipment is fitted to one trolley
- Supplied complete with ground fault relay

Item no.

31225 Vacuum cleaner trolley

Accessories

Item no.

17010116 Vacuum hose, silver (sold in /m, max 25 m)

17010015 Vacuum hose end adapter

Practical for larger pools and public facilities.



Dimensioning heat exchanger online

Pahlén has developed a calculation program for Pahlén's range of heat exchangers.

A heat exchanger is to transfer energy (heat) from one medium to another, e.g. from electric, firewood, pellets or oil-fired boilers, heat pump or solar panel systems. The heat exchangers can not create energy on their own. The heat source should match the heating requirements for the pool.

Pahlén has an extensive experience in dimensioning and heat calculation

Our calculation program for heat exchangers can be used to assist in decision making. The heat requirement for each pool is unique and is affected by a variety of factors such as isolated/non-isolated pool, above ground pool/inground pool, pool cover, etc.

A heat exchanger consists of a primary side where the hot water comes from the heat source and a secondary side where the pool water passes through the heat exchanger. To ensure an optimum heat transfer the flows meet crosswise.

What does the program do and how do you use it?

In the calculation program the type of heat exchanger is chosen in the drop list. Then a nominal inlet temperature and the flow for the primary side is shown together with the desired pool temperature and the flow of the pool circulation to the secondary side.

It is free to modify the values as long as they are within the limits (in parentheses). The calculate button gives transferred heating power and output temperatures. You will also get the calculated pressure drop across for each side shown in H(m) (defined as mH_2O).

If you want to change heat exchanger you can lock the operating mode with the "lock button" to be able to compare the transmitted power with another heat exchanger model. The tabs picture/dimensions show a picture and dimensions of the selected heat exchanger.

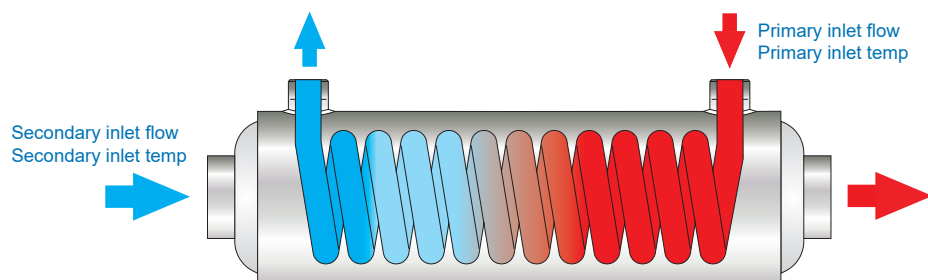

You can **easily** and conveniently **dimension** your heat exchanger **online** if you don't **know** which one to **choose**!



Swimming pool heat exchanger calculator

Picture Dimensions



Heat Exchanger

11365-MF 135 Moss-Pla

Calculate

Lock Values

Primary inlet flow: 25 l/min (5 - 60)

Primary inlet temperature: 80 °C (20 - 150)

Secondary inlet flow: 200 l/min (50 - 500)

Secondary inlet temperature: 20 °C (4 - 60)

Transmitted effect: kW

Primary outlet temperature: °C

Secondary outlet temperature: °C

Primary pressure drop: mH_2O

Secondary pressure drop: mH_2O

Calculation of electric heaters

Calculation of electric heaters



MidiHeat 18-72kW



Compact 3-18kW



Aqua compact 3-18kW



Aqua HL line 3-15kW



Aqua spa 1.5-3kW

Example

The amount of hours in theory it takes to heat up your pool based on volume and the capacity (kw) of the heaters.

Example: the pool is 100 m³ and a heater of 24kW takes 87 hours to heat up to 28°C from 10°C.

$\Delta T=18$ (10°C - 28°C)											
kW	6	9	12	15	18	24	30	36	45	60	72
Volume											
25 m ³	87	58	44	35	29	22	17	15	12	9	7
45 m ³	157	105	78	63	52	39	31	26	21	16	13
70 m ³	-	163	122	98	81	61	49	41	33	24	20
100 m ³	-	-	174	140	116	87	70	58	47	35	29
150 m ³	-	-	-	-	-	131	105	87	70	52	44
200 m ³	-	-	-	-	-	-	140	116	93	70	58
250 m ³	-	-	-	-	-	-	-	145	116	87	73
300 m ³	-	-	-	-	-	-	-	-	140	105	87
350 m ³	-	-	-	-	-	-	-	-	-	122	102

Dimensioning of heat exchangers

Dimensioning of tube- and spiral heat exchangers

The capacity of a heat exchanger varies according to the liquid flow through the primary (hot) and the secondary (cold) circuits and the temperature difference between both media. From the table of capacities a nominal thermal output for each heat exchanger may be obtained. This output is based upon given liquid flow through both circuits, which is quoted in the table, and a temperature difference between the incoming primary and secondary media.

As an example heat exchanger type MF 135 has a thermal output of 40 kW when the liquid flow is 25 l/min on the primary side, 200 l/min on the secondary side, and the temperature difference between both incoming media is 60°C. By the use of diagrams A and B, the thermal output may be calculated for other liquid flows and temperature differences than those quoted in the table.

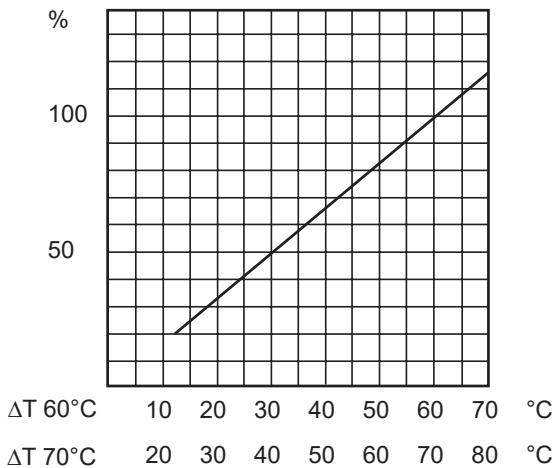

Diagram A Nominal heat effect

Shows the variation in thermal output with changes in temperature differences between the incoming media. This output is virtually proportional to this temperature difference.

Difference in temperature between incoming warm water (primary) and incoming cold water (secondary)

Theoretical heat calculation

Examples of calculation formulas for heating pools without any heat loss

- Power required to increase water temperature by ΔT degrees in a fixed time (t), assuming no heat loss.
Formula: $P = 1.16 \times \frac{\Delta T}{t} \times V$
 - Time taken to increase water temperature by ΔT degrees from a fixed power input, assuming no heat loss.
Formula: $t = 1.16 \times \frac{\Delta T}{P} \times V$
- P = Power in kW
 t = Time in hours
 ΔT = Temperature difference °C
1.16 = Constant
 V = Volume in m³

Example: Time taken to heat 30 m³ of water from 5°C to 25°C with a 6 kW heater, assuming no heat loss:
 $t = 1.16 \times \frac{(25-5)}{6} \times 30 = 116$ hours

Ask the experts for help
or calculate it your self!
The right dimension
gives you a warm and
comfortable pool.

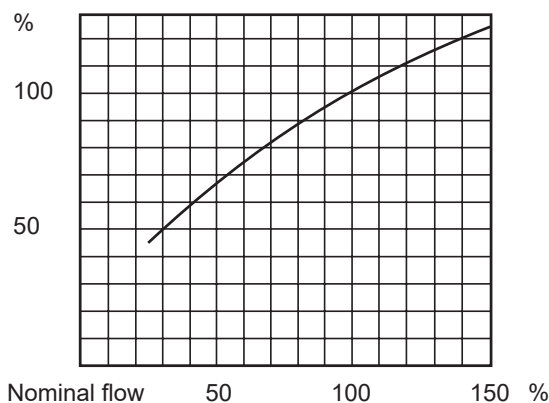

Diagram B Nominal heat effect

Represents the variation in thermal output with changes in liquid flow. This diagram is based upon the nominal values given in the table of capacities, which values represent 100% on the graph.

If the flow in both primary and secondary circuits is in the same relationship to the nominal values, then the rate of the thermal output from the heat exchanger may be read from the graph.

If, however, the flow in both circuits do not have the same relationship to the nominal values, the thermal output can be approximated as the average of the two separate readings from the graph.

Pahlén showroom, Upplands Väsby, Sweden

Pahléns first class show room

All Pahlén products are clearly exposed in a relaxing and pleasant environment. For further inspiration, you find the most common type of pools demonstrated, obviously with Pahlén products installed. Welcome to Pahlén!



[illegible]

[illegible]



=



Pahlén Pool System is supplied in the form of a complete circulation systems with efficient cleaning, heating and lighting for the most common pool sizes. They are sold in basic and premium versions, with or without various options. Contact your nearest Pahlén dealer.

Pahlén AB

Box 728, 194 27 Upplands Väsby, Sweden
Email: info@pahlen.se, www.pahlen.com

We do not accept liability for printing errors.
We reserve the right to make changes to specification and product range.
Colour deviation may occur due to restrictions in the printing process.